

JUNE 20, 2017
BOARD OF COUNTY COMMISSIONERS
ORANGE COUNTY, FLORIDA
ADDENDUM NO. 3 / IFB Y17-768-CC
ORANGE COUNTY CORRECTIONS BOOKING AND RELEASE CENTER
ENERGY RECOVERY UNIT REPLACEMENT

BID OPENING DATE: JUNE 27, 2017

This addendum is hereby incorporated into the bid documents of the project referenced above. The following items are clarifications, corrections, additions, deletions and/or revisions to, and shall take precedence over, the original documents. Underlining indicates additions, deletions are indicated by ~~strikethrough~~.

A. The bid opening remains June 27, 2017 at 2:00 P.M.

B. REVISION:

Make the following changes to Part C – Instructions to Bidders, No. 28 References and also to Part D, Attachment E:

Bidder should supply (with the bid form) a list of four (4) similar projects successfully completed **by the Bidder, with two (2) projects as a Prime and two (2) projects as a Prime or Sub Contractor** within the last ten (10) years. Failure to provide this information may be cause for rejection of the bid. For purposes of the Invitation for Bids, a similar project is described as the replacement of one energy recovery unit equipped with supply and exhaust fans, enthalpy wheel heat exchanger, filters, intake and exhaust hoods, variable frequency drives and unit mount controller in a building with a minimum of two stories and a gross square foot area of 25,000 square feet or greater, or a HVAC rooftop unit with a minimum weight of 20,000 lbs. and a minimum size of 28 feet long by 12 feet wide by 11 feet high and the project included replacing a roof curb in a building with a minimum of two stories and a gross square foot area of 25,000 square feet or greater.

Additionally, at least one (1) of the projects submitted must meet the following requirement:

Work must have been completed in an occupied and operational building.

EACH SIMILAR PROJECT LISTED SHALL BE LISTED WITH COMPLETE INFORMATION AS SPECIFICALLY PROVIDED ON THE REFERENCE FORM (ATTACHMENT E). THE SPECIFIC INFORMATION ON REFERENCES MUST BE PROVIDED ON THE REFERENCE FORM. DO NOT ATTACH LISTINGS OF REFERENCE

INFORMATION. FAILURE TO PROVIDE REFERENCE INFORMATION AS REQUESTED MAY RESULT IN THE REJECTION OF YOUR BID.

The determination of whether a bidder is responsible or not shall be at the sole discretion of the County. Although the County may request submission of a minimum number of similar projects for evaluation, the County's determination of a bidder's responsibility shall not be solely based on the number of similar projects submitted.

The contact person listed as a reference shall be someone who has personal knowledge of the Bidder's performance during the referenced project. Contact persons must have been informed that they are being used as a reference and that the County will be calling or emailing them.

C. QUESTIONS/ANSWERS

1. Question: Does the ductwork inside the mechanical room have the insulation lining on the outside or inside?
Response: No. The ductwork is not insulated.
2. Question: If the insulation is on the inside, is it limited to a certain linear feet distance? And then the insulation is on the outside or is it continuous on the inside?
Response: Ductwork is not insulated.
3. Question: What are the ladder requirements for accessing the ductwork in the mechanical room?
Response: Ductwork penetrate roof slab at 14 feet 6 inches above finished floor (AFF) in the mechanical room.
4. Question: Will there be access to run an air line to the exterior for powering cleaning equipment, either up through the roof or through exterior doors?
Response: No roof penetrations than can be accessed. Could run the air line down the hall, up through stairs, through roof access door near elevator and on to roof but it will require security escorts and is not recommended.
5. Question: Is there a power disconnect for AHU at the equipment location for LOTO?
Response: Energy Recovery Units (ERUs) have an integral power disconnect as noted in the Mechanical Schedule Note #7 in sheet M-201.

6. Question: Will we be able to run equipment that will exceed 15 amps electrical power in the mechanical room? Is there at least two 15 amp service outlets on separate breakers?
Response: There are 15 amp convenience receptacles integral to the ERUs. Receptacles on ERUs do not have dedicated circuits. There are receptacles in the mechanical room at the 4th floor and they are not in the dedicated circuits.
7. Question: Do the ductwork inside the mechanical room have the insulation lining on the outside or inside?
Response: The exhaust and outdoor air ducts in the mechanical room associated with ERU-1 and ERU-2 are not insulated.
8. Question: If it is on the inside, is it limited to a certain linear feet distance and then the insulation is on the outside, or is it continuous on the inside?
Response: Seal connections from new ERUs to existing exhaust and outdoor air ducts. Transitioning to existing ducts are necessary.
9. Question: The panel schedule E-001 call out Square D panels and the panels are General Electric (GE) panels. Can we get the correct information please?
Response: Panel board DP-ELS-4C is manufactured by General Electric (GE).
10. Question: Sheet E-101 Hex Note #1 reads Panel board DP-ELS-4C. As the existing power panel, it appears that MP-E4C is the existing power panel. Which is correct?
Response: Both electrical Panel boards MP-E4C and DP-ELS-4C shown on drawings are existing. Electrical plans include both demolition (Sheet ED-101) and new installation (Sheet E-101) electrical plans. Sheet ED-101 shows locations of existing panels and indicates removal of existing ERU wiring from panel MP-E4C. Sheet E-101 also shows location of existing panels and indicates replacement of existing breakers in panel DP-ELS-4C for new ERUs.
11. Question: Drawing M-102 indicates a new roof curb for each Energy Recovery Unit. Can you provide information about what type of roof insulation and material is required for insulating around new roof curbs?
Response: As-built drawings indicate that roof consists of insulating concrete fill-sloped to roof drains with 2-inch minimum thickness and rigid insulation with R-19 insulation average (3-inch

minimum thickness). Reference as-built detail 8 sheet A7.3.1 dated 3/17/2003 for make-up of roof. (See attached)

12. Question: The plans call out that the panel DP-ELS-4C (the panel that we are adding the new breakers) is an NQOD panel. NQOD panels are 120/208 volt. We need to know the specific (name plate) style of the panel as well as the KAIC rating of the new breakers.
Response: Panelboard DP-ELS-4C is a 1200A, 480/277V, 3-Phase, 4-wire rated panel as noted on drawings. Panel manufacturer is a General Electric "Spectra Series" with an AIC of 42,000 Amps, not a type NOQD. New breakers shall match panel manufacturer, breaker type and AIC rating. See photos attached.
13. Question: Must the Prime Contractor for this project be a licensed General Contractor?
Answer: The contractor is responsible for ensuring all required permits are obtained. The majority of work performed on a particular project shall be within the scope of the Contractor's license.

D. ADDITIONAL NOTES

1. Any noise generating activities above 80 decibels shall not be conducted during normal business hours. Normal business hours are defined in specification section 01010 Paragraph 1.06 – Work Sequence. Coordinate any activities above 80 decibels with Orange County Project Manager and Corrections Facilities personnel.
2. Mechanical and electrical equipment may be de-energized for a maximum of four (4) hours at a time. Coordinate all equipment shutdowns with Orange County Project Manager and Corrections Facilities personnel.
3. Refer to specification section 01010 paragraph 1.04.B. For existing building protection requirements.
4. Contractor shall consider methodology of lifting equipment to roof and consider restricted access to facility including security gate clearance height of 13 feet 6-inches.

E. ACKNOWLEDGEMENT OF ADDENDA

- a. The Bidder/Proposer shall acknowledge receipt of this addendum by completing the applicable section in the solicitation or by completion of the acknowledgement information on the addendum. Either form of acknowledgement must be completed and returned not later than the date and time for receipt of the bid or proposal.
- b. All other terms and conditions of the IFB remain the same.
- c. Receipt acknowledged by:

Authorized Signature

Date Signed

Title

Name of Firm

As-built detail indicating roof curb detail from sheet A7.3.1 dated 3/17/2003.

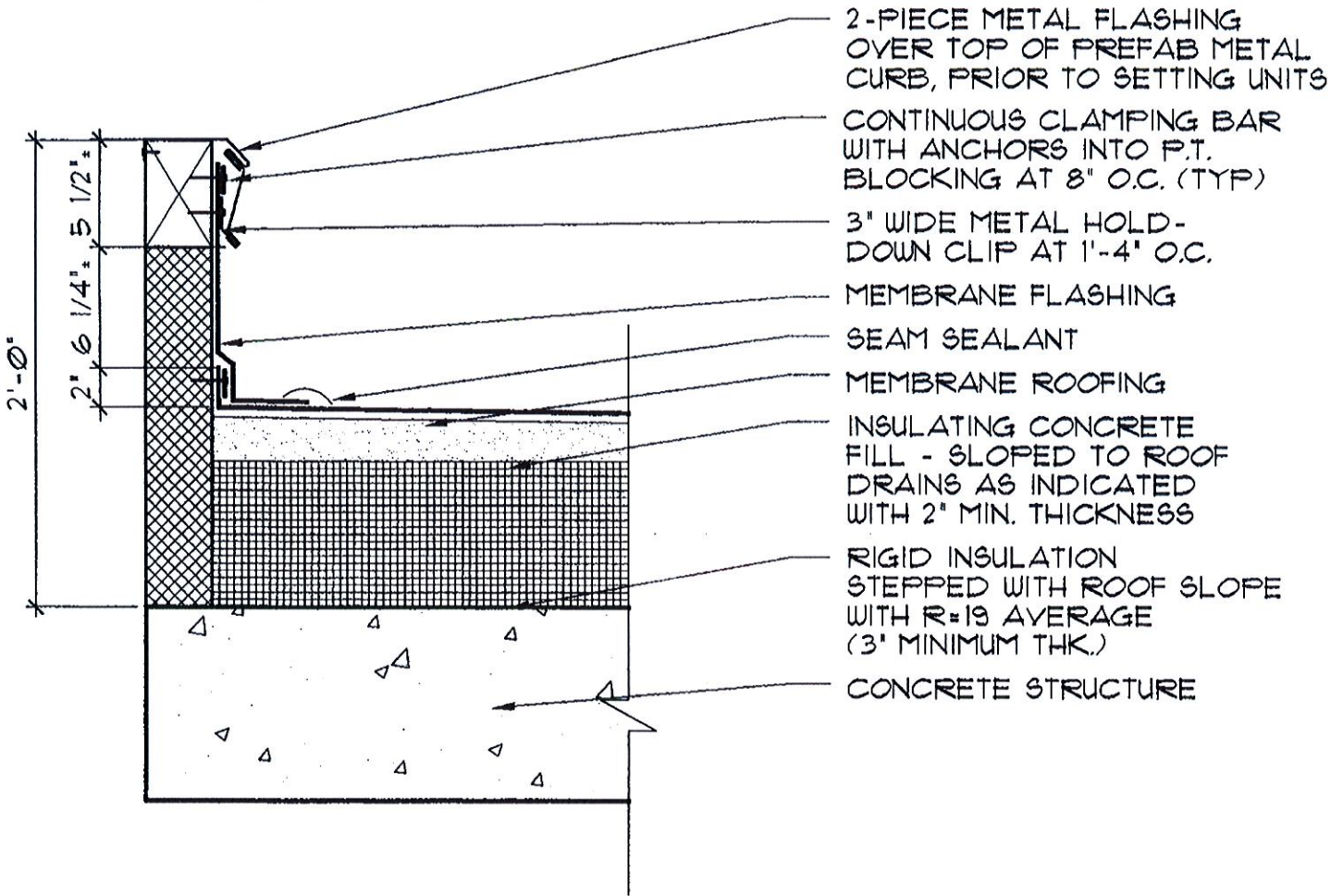

NOTE: PROVIDE PREFAB CURBS FOR ALL ROOF MOUNTED EQUIPMENT. CURB SHALL BE DESIGNED FOR THE SPECIFIC TYPE OF EQUIPMENT TO BE USED AND SHALL PROVIDE ALL NECESSARY CONNECTIONS FOR THE EQUIPMENT WITHIN THE CURBED AREA. NO CUTS OR PENETRATIONS OF CURB WILL BE PERMITTED UNLESS SPECIFICALLY SO NOTED BY THE MANUFACTURER.

8 mechanical curb detail
A7.3.1

1 1/2"=1'-0"

SPARE

 Spectra RMS™

**CURRENT LIMITING
CIRCUIT BREAKER**

Cat. No. SELA38AT0100
100 Amp Max 600VAC ~ 3Pole
Rating Plug Type: SRPE100A

Lug Data: 60/TSDEGC WIRE
Cat. No. TCAL18

Wire Range #12 - 3/0 CU
#12 - 3/0 AL

Torque: #12--#10 35 lb-in
#8--#3 100 lb-in
#2--3/0 150 lb-in

FOR SERIES RATINGS COMBINATIONS, TP
AND 1% SEE GE BULLETIN DEV-2000

MAX

 Spectra RMS™

**CURRENT LIMITING
CIRCUIT BREAKER**

Cat. No. SELA38AT0100
100 Amp Max 600VAC ~ 3Pole
Rating Plug Type: SRPE100A

Lug Data: 60/TSDEGC WIRE
Cat. No. TCAL18

Wire Range #12 - 3/0 CU
#12 - 3/0 AL

Torque: #12--#10 35 lb-in
#8--#3 100 lb-in
#2--3/0 150 lb-in

FOR SERIES RATINGS COMBINATIONS, TP
AND 1% SEE GE BULLETIN DEV-2000

Interrupting Rating
RMS Sym Amps 60 kA

Volts	kA
240	100
480	65
600	25

TRIP

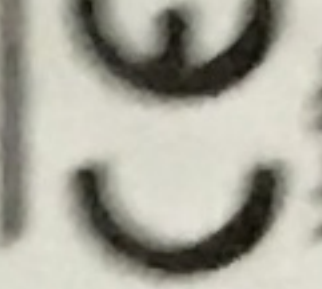

600V

Volts

220/240	100	6
380/416 <td>65</td> <td>5</td>	65	5
500	40	5
690	10	5

GE INDUSTRIAL
PLANTVILLE CT 06060

TYPE SRPE100A

100A

ON

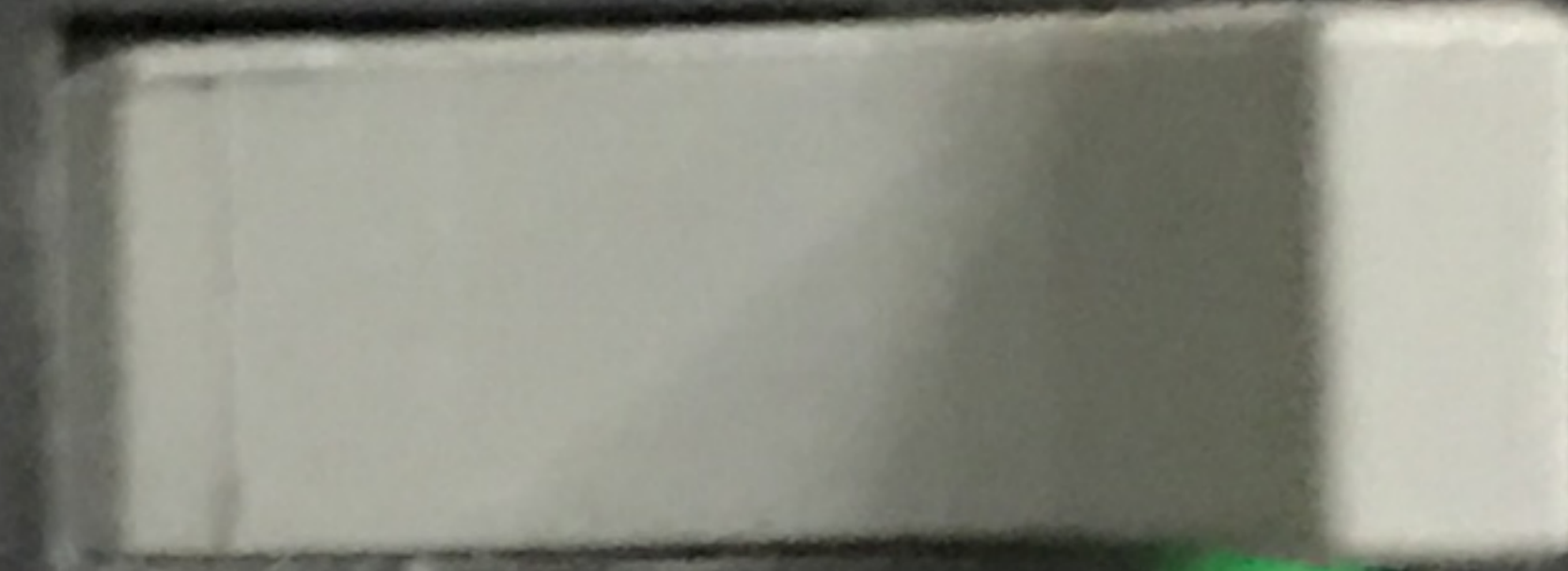

OFF

MAX

DANGER
 HAZARD OF ELECTRICAL SHOCK OR BURN
 TURN OFF POWER SUPPLYING THIS
 EQUIPMENT BEFORE WORKING INSIDE.
DANGER
 RISQUE DE CHOC ET DE BLESSURES PAR
 TRANSFERT D'ENERGIE COUPER
 L'ALIMENTATION DE CET APPAREIL AVANT
 DE PROCEDER A DES TRAVAUX A L'INTERIEUR.

NOTE: IF BREAKER TRIPS, HANDLE WILL BE
 IN INTERMEDIATE POSITION
 TO RESTORE POWER
 1. MOVE HANDLE TO OFF POSITION.
 2. THEN MOVE HANDLE TO ON POSITION. 252B2269P3

Spectra Series™ APNB BOLT-ON STYLE

REQ. NO. 341430C11P	ORDER NO. 178PP73078	ITEM NO. 7-1	DATE CODE MMS03&
------------------------	-------------------------	-----------------	---------------------

VOLTS 480Y/277 AC	PHASE 3	WIRE 4	FEED TOP	INTERIOR AMPS 1200
----------------------	------------	-----------	-------------	-----------------------

SHORT CIRCUIT CURRENT RATING
 THE SHORT CIRCUIT RATING OF THIS PANELBOARD IS EQUAL TO THE LOWEST CURRENT
 INTERRUPTING RATING OF ANY DEVICE INSTALLED, OR COMBINATION SERIES CONNECTED
 CIRCUIT BREAKER. SEE LABEL ON BOX. THE MAXIMUM RMS SYMMETRICAL AMPERS
 RATING IS: **42K AMPERS**

CURT. MARK: DP-ELS-4C
 NOTE: COPPER BUS 1000A PSI

GE 8354 APNB1812134A 1487 ASSEMBLED IN MEXICO 252B2269P3

LIGHTING OR APPLIANCE BRANCH
 CIRCUITS ARE NOT TO BE SUPPLIED
 DIRECTLY THROUGH MORE THAN 10
 PERCENT OF THE BRANCH CIRCUIT
 OVERCURRENT - PROTECTIVE
 DEVICES.
 SUITABLE FOR USE AS SERVICE
 EQUIPMENT IN USA WHEN EQUIPPED WITH
 A MAIN OVERCURRENT DEVICE OR WHEN
 NOT MORE THAN SIX SERVICE
 DISCONNECTING MEANS ARE PROVIDED.
 EACH DEVICE MUST BE LESS THAN 1000
 AMPS OR HAVE GROUND FAULT
 PROTECTION OR SYSTEM MUST BE LESS
 THAN 150V TO GROUND.

USE WITH APNB PLUG-IN STYLE PANELS
 USE ONLY G.E. TYPE
 AIC SWITCHES
 AIRC CIRCUIT BREAKER MODULES
 ANL OR ANB LUG UNITS
 AFL FEED THRU KITS
 ANK OR ANKN NEUTRAL
 APB ENCLOSURE
 AEG EQUIPMENT GROUNDS
 APF TRIM
 APP OR APP FILLER PLATES
 APCU, ATWS AND ADDVMA

USE WITH APNB BOLT-ON STYLE PANELS
 USE ONLY G.E. TYPE
 ANB LUG UNITS
 AFLD FEED THRU KITS
 ANK OR ANKN NEUTRAL
 APB ENCLOSURE
 AEG EQUIPMENT GROUNDS
 APP OR APP FILLER PLATES
 APF TRIM

UL LISTED
 PANELBOARD
 ISSUE NO. C-2599

E2366 75C140576P608

Technical specifications and safety information for the top-left breaker.

Technical specifications and safety information for the top-right breaker.

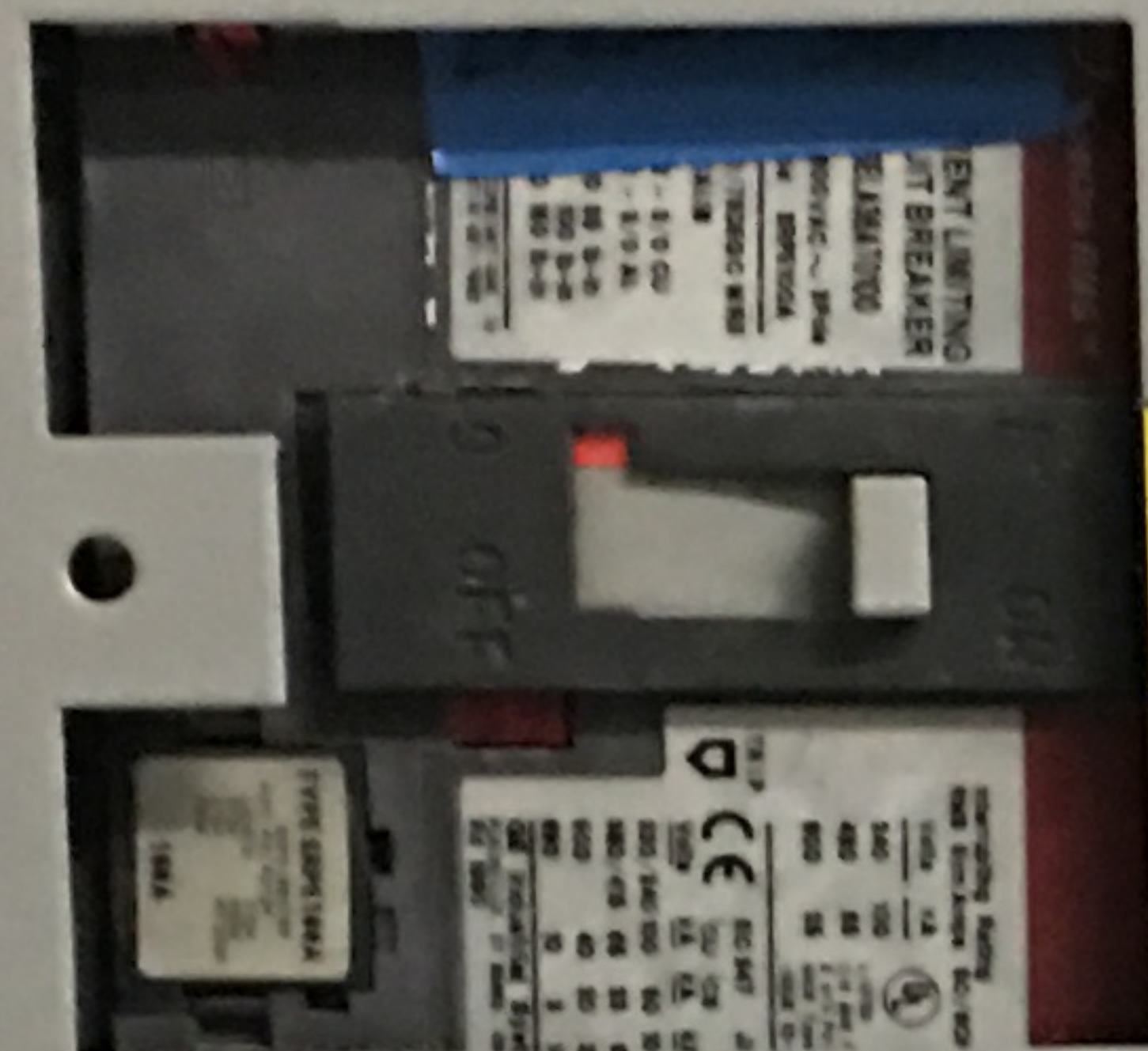

LP-ELS-3B

LP-ELS-2B

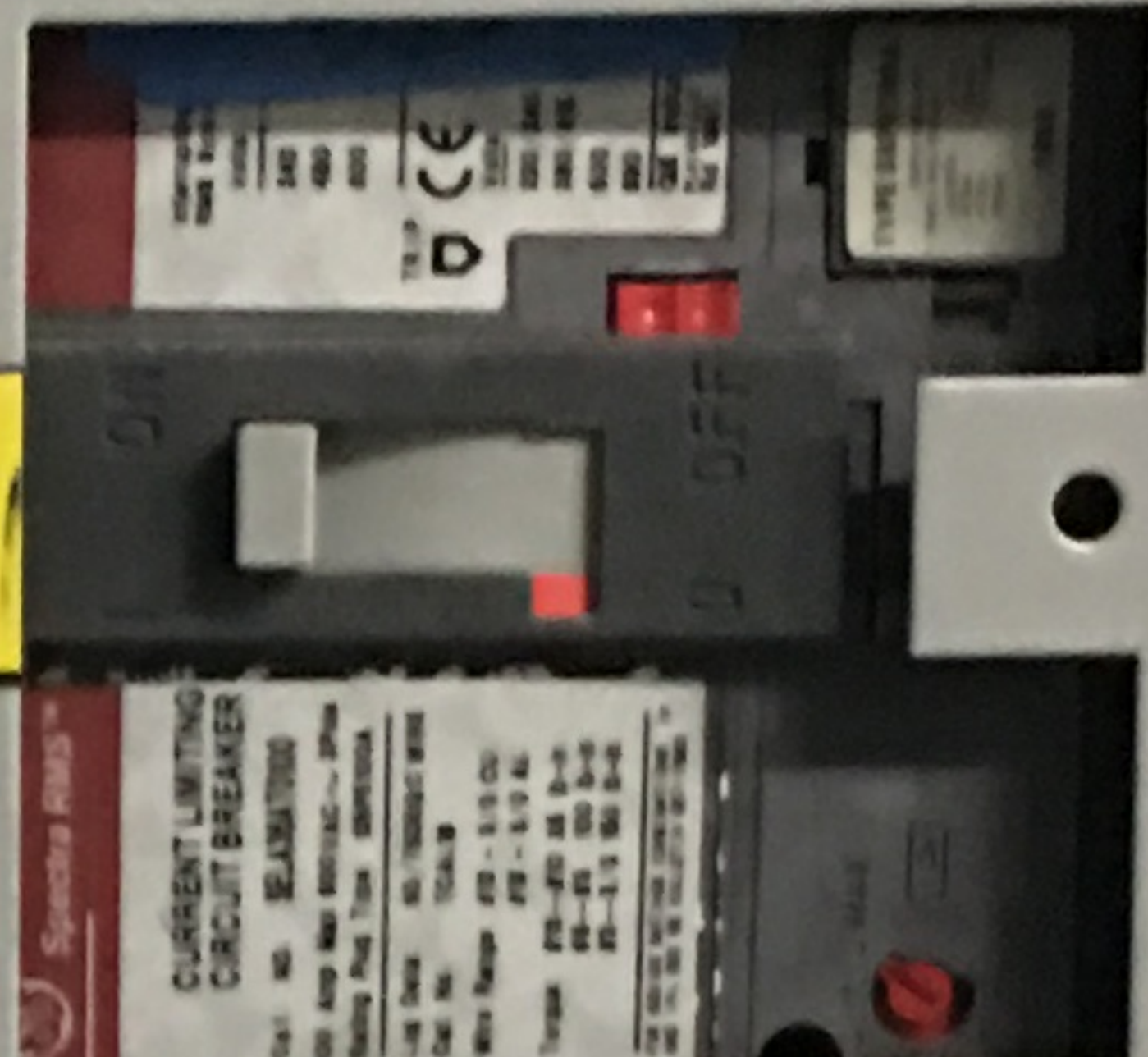

SPARE

LP-ELS-4B

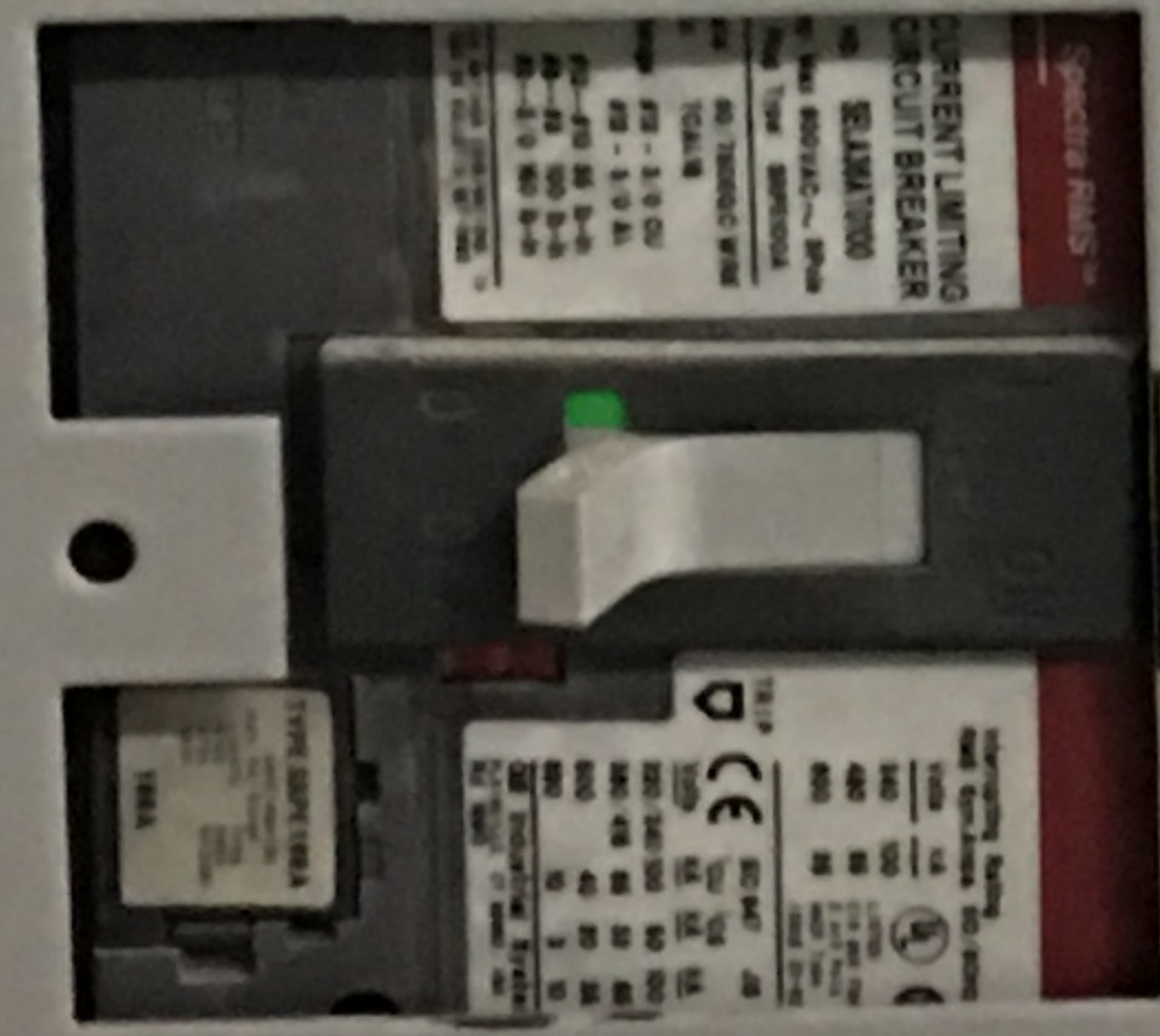

SPARE

SPARE

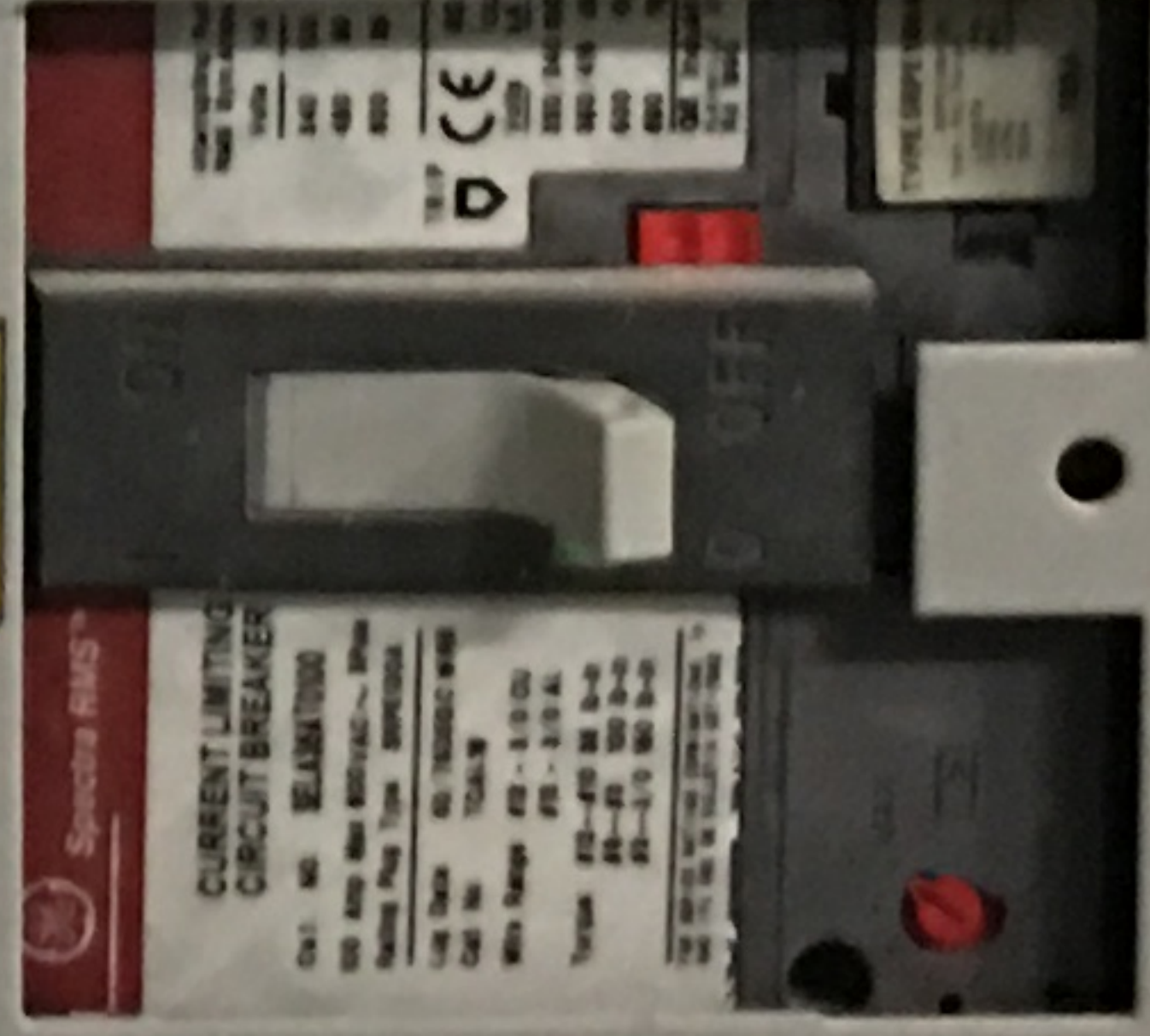

SPARE

Spectra RMS™

**CURRENT LIMITING
CIRCUIT BREAKER**

1. NO. SELA36A10100
Amp Max 600VAC ~ 3Pole
Plug Type: SRPE100A

2. Data: 60/75DEGC WIRE
3. No: TCAL18

4. Range: #12 - 3/0 CU
#12 - 3/0 AL

5. Range: #12--#10 35 Ib-In
#8--#3 100 Ib-In
#2--3/0 150 Ib-In

6. SEE SE RATINGS COMBINATIONS, 1P
7. SEE SE BULLETIN SET-7882

Interrupting Rating
RMS Sym.Amps, 50/60H

Volts	KA
240	100
480	85
600	25

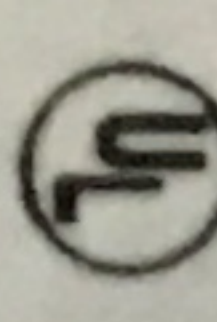

LISTED
CIR BRK FI
2 or 3 Pole
HCCR Type
ISSUE 2D-1

TRIP

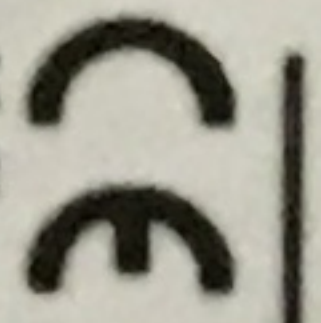

IEC 947 JIS
CU CS KA KA

Volts	KA	KA	KA
220/240/100	50	100	100
380/416	65	33	6
600	40	20	21
990	10	3	10

GE Industrial Systems
PLAINVILLE, CT 06062, USA
Rd 1950

TYPE SRPE100A

Inst. Adj. Range
775A
998B
M1298F
188A