

DIMENSIONING

1. WHEN A ROOM/BUILDING/OBJECT CENTERLINE IS INDICATED, ONLY ONE SIDE OF ELEMENT MAY BE DIMENSIONED

2. DOOR LOCATION
DOORS ARE LOCATED BY ONE OF THE FOLLOWING:
A. ONE JAMB FACE LOCATED BY A PARTITION AT RIGHT ANGLE.

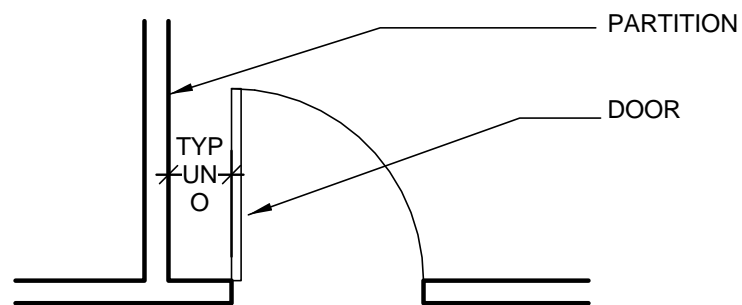

B. AS DIMENSIONED

3. PARTITION FINISH FACE ON COLUMN OR GRID LINE WILL NOT BE DIMENSIONED ON SMALL SCALE PLANS BUT WILL BE DRAWN ACCORDINGLY ON LARGER SCALE DRAWINGS.

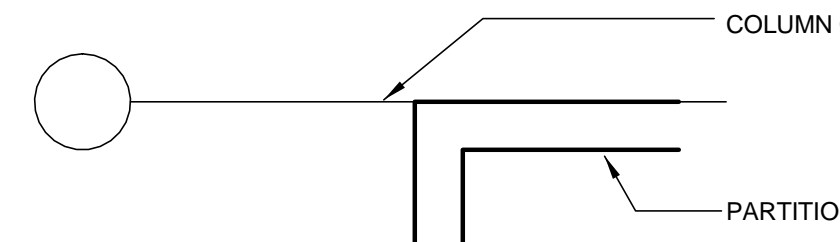

4. PARTITIONS WITH FINISH FACE FLUSH WITH FINISH FACE OF COLUMN WILL NOT BE DRAWN ON SMALL SCALE PLANS BUT WILL BE DRAWN ACCORDINGLY ON LARGER SCALE DRAWINGS.

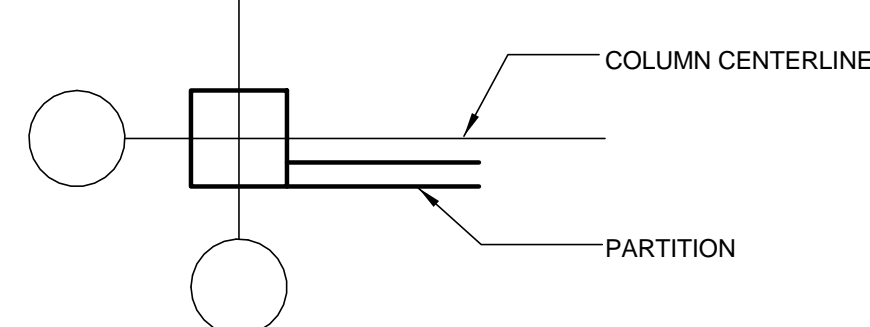

5. PARTITIONS CENTERED ON COLUMNS OR GRID LINES WILL NOT BE DIMENSIONED ON SMALL SCALE PLANS BUT WILL BE DRAWN ACCORDINGLY ON LARGER SCALE DRAWINGS.

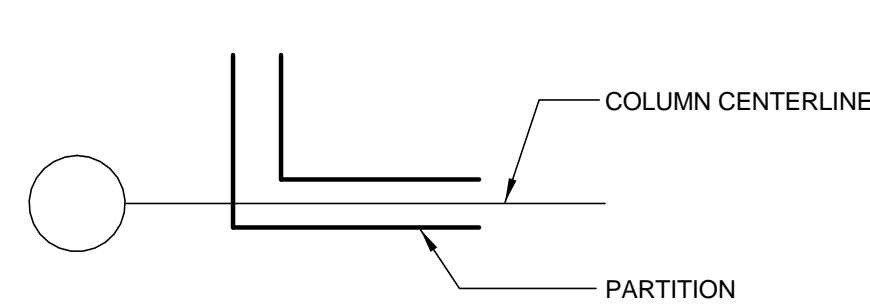

6. PARTITIONS ARE DIMENSIONED TO FACE OF STUDS, FACE OF CMU AND FACE OF BLOCK UNLESS INDICATED OTHERWISE

7. DIMENSIONS ARE INDICATED ON DRAWINGS. DO NOT SCALE DRAWINGS

DRAWING SYMBOL LEGEND

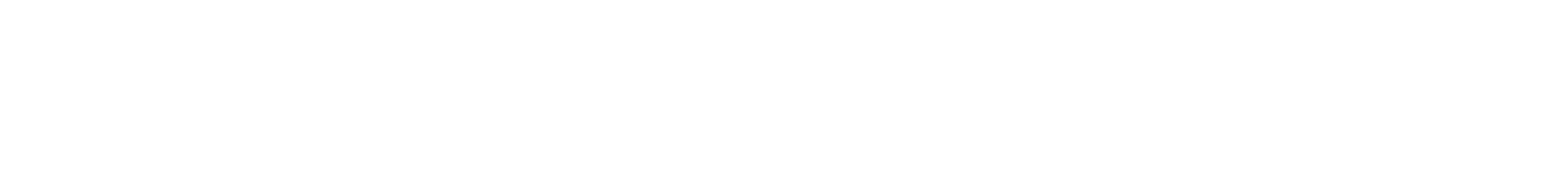
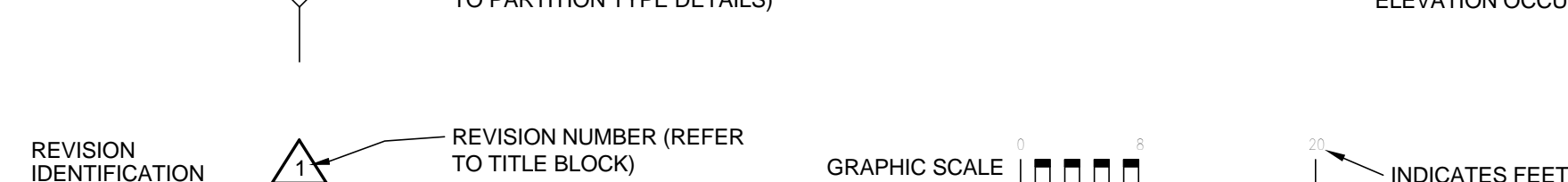
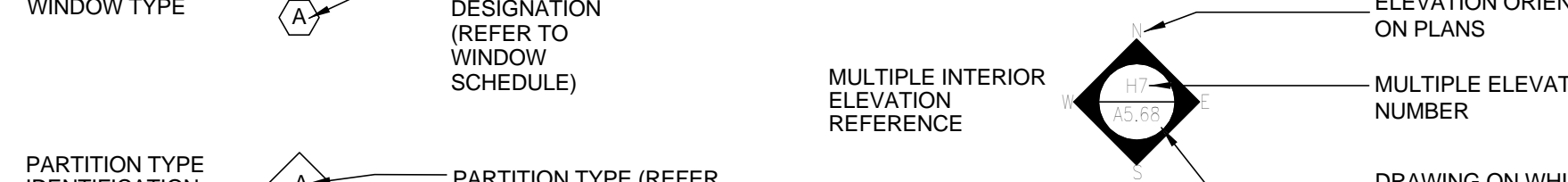
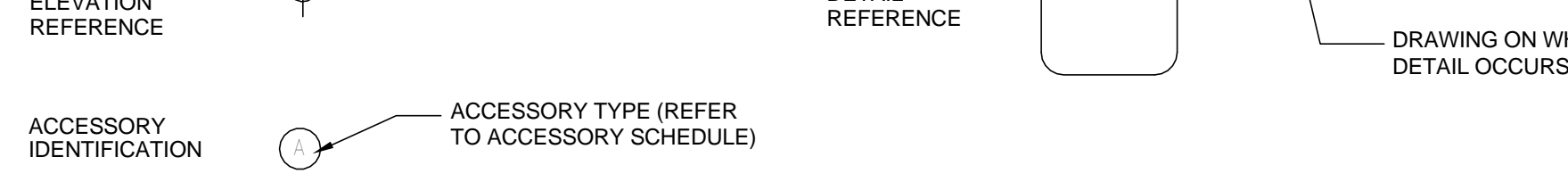
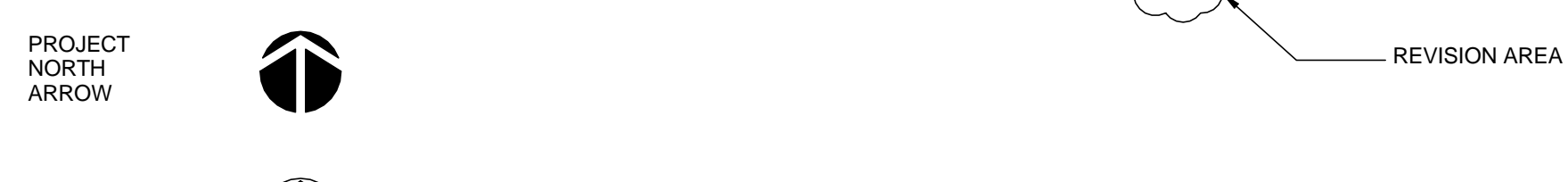
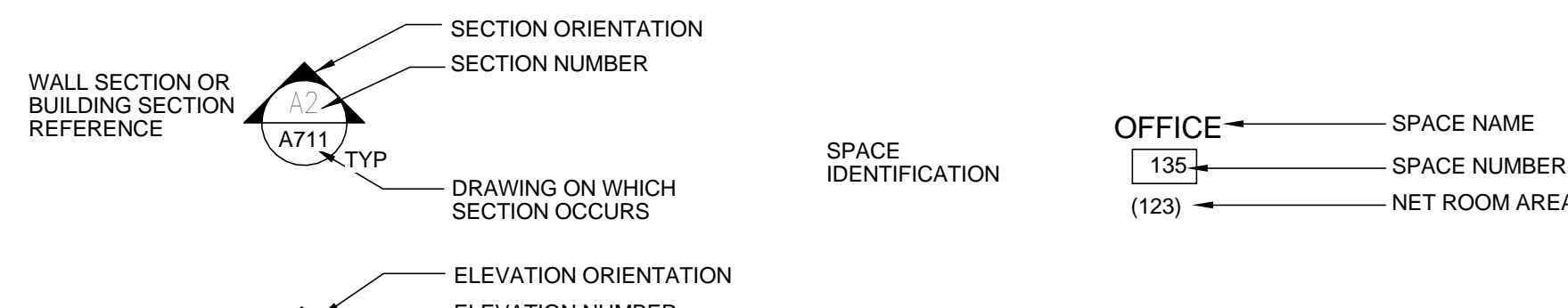
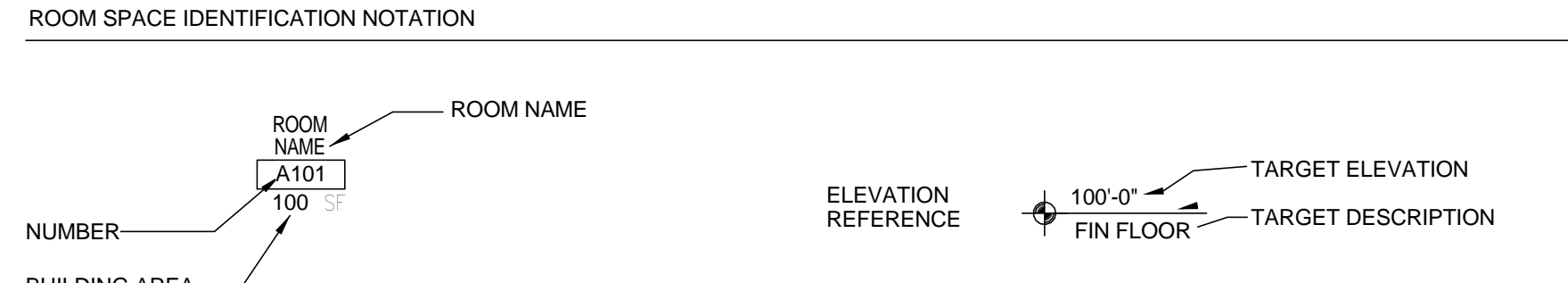
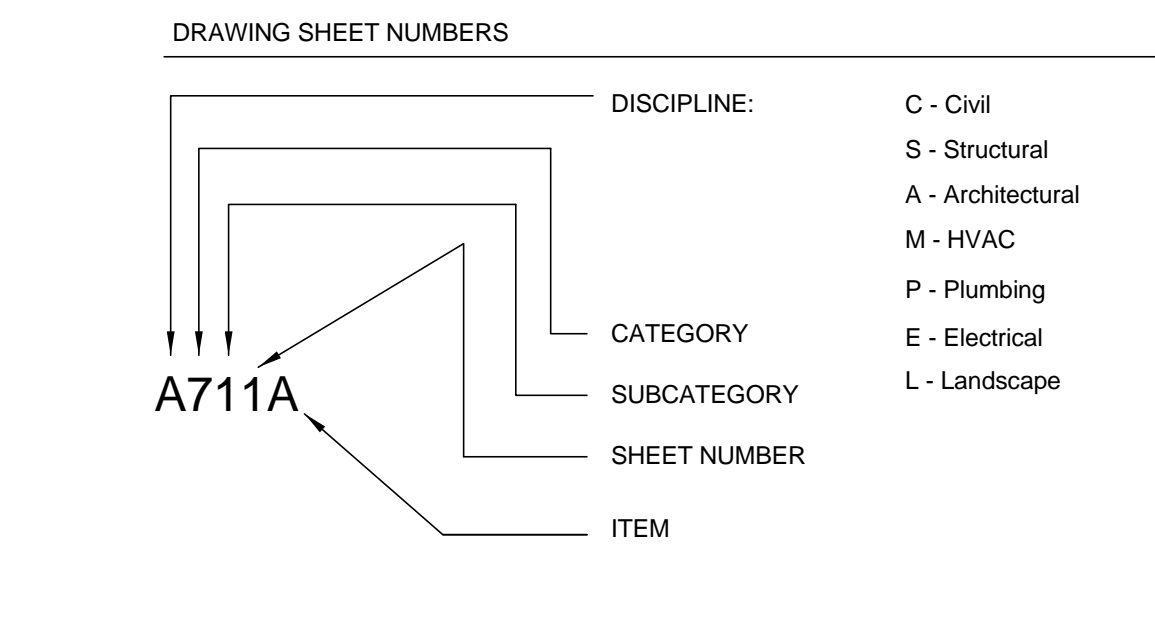

MATERIALS LEGEND

	EARTH		DISCONTINUOUS ROUGH LUMBER
	CONCRETE		CONTINUOUS ROUGH LUMBER
	FINISH LUMBER		CONCRETE MASONRY UNITS
	PLYWOOD		RIGID INSULATION
	STEEL		GYPSUM BOARD / GROUT FILL
	BATT INSULATION		POROUS FILL

DRAWING FORMAT

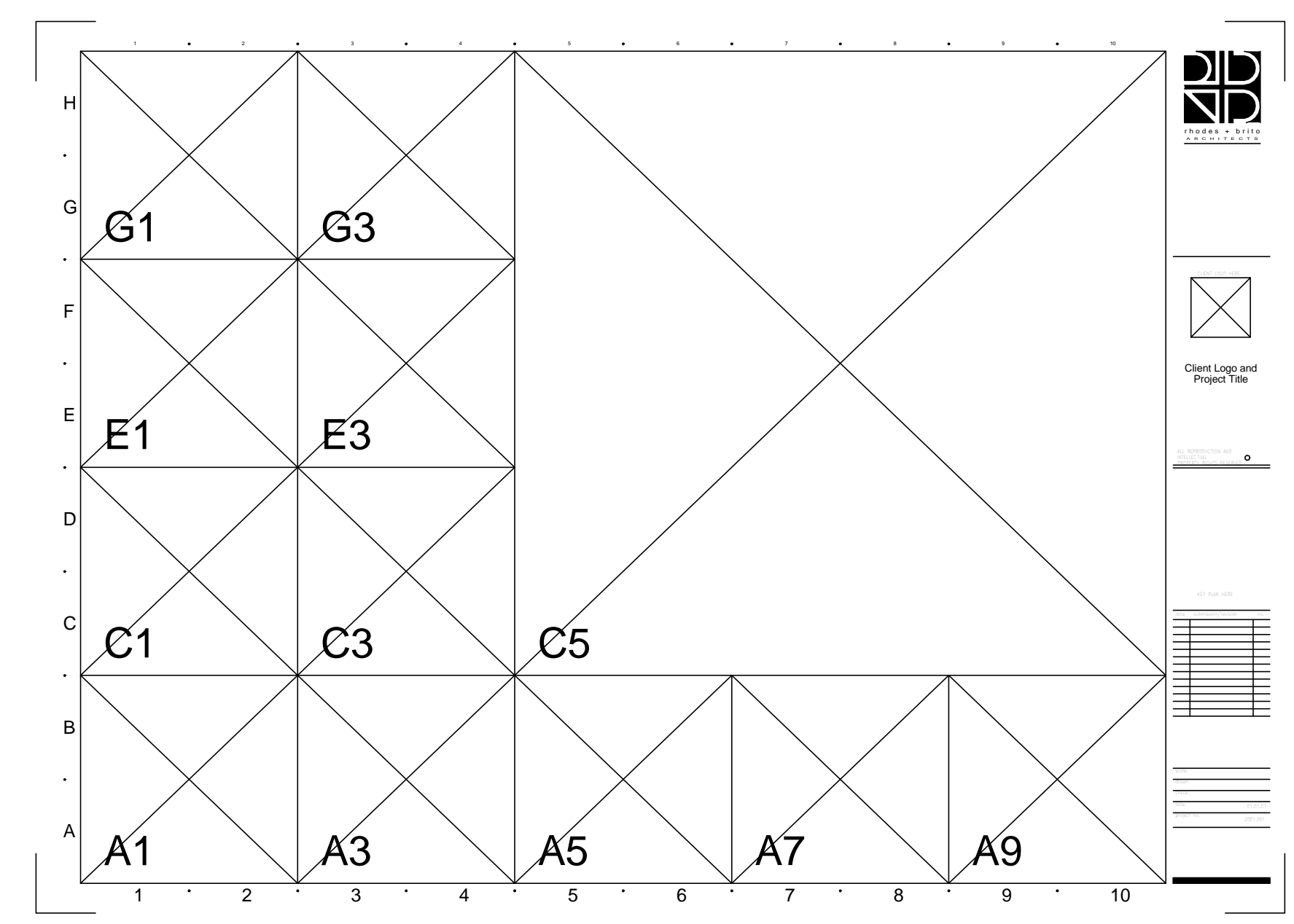

EACH SHEET IS DIVIDED INTO A GRID. AN ALPHA-NUMERIC GRID COORDINATE SYSTEM IS USED TO ORGANIZE THE DRAWING TITLES. DRAWING TITLES ARE NUMBERED ACCORDING TO ITS LOCATION ON THE GRID. THE LOWER LEFT HAND CORNER GRID OF THE DRAWING IS USED AS THE IDENTIFICATION NUMBER (SEE DIAGRAM).

LIST OF ABBREVIATIONS

AB ANCHOR BOLT	AC AIR CONDITIONING	ACC ACCESS	ACPL ACOUSTICAL PLASTER	ACT ACOUSTICAL TILE	AD AREA DRAIN	ADD ADDENDUM	ADJ ADJUSTABLE	AEE ARCHITECT/ENGINEER	AFF ABOVE FINISHED FLOOR	AHU AIR HANDLING UNIT	ALT ALTERNATE	ALUM ALUMINUM	ANC ANCHORAGE	AND ANDIZED	ANP ACCESS PANEL	APROX APPROXIMATE	ASB ASBESTOS	ASPH ASPHALT	AUTO AUTOMATIC	AV AUDIO VISUAL	CAB CABINET	CAT CATEGORY	CB CAST BASIN	C/C CENTER TO CENTER	CCO CURB FOOT	CG CORNER GUARD	CHAM CHAMFER	C/H CEILING HEIGHT	CI CAST-IN-PLACE	CIP CAST-IN-PLACE	CIR CIRCLE	ADJ ADJUSTABLE	CEK CALK	CLS CLEARANCE	CLOS CLOSURE	CMU CONC MASONRY UNIT	CONTR CENTER	CONTRNSKOUNTERSNIK CLEAN OUT	CO CLEAN OUT	CONC CONCRETE	CONN CONNECTION	CONSTR CONSTRUCTION	CONT CONTINUOUS	CONTR (CONTRACTOR)	COMPT COMPARTMENT	CORR CORRUGATED	CP CENTER POINT	CPCI CONTRACTOR PROVIDED	CONTR (CONTRACTOR)	CR CONTRACTOR INSTALLED	CRS CHROMIUM (PLATED)	CSMT COURSE(S)	CSM CASEMENT	CRANM CERAMIC TILE	CYD CUBIC YARD	DBL DOUBLE	DEM DEMOLISH	DEP DEPRESSED	DEPT DEPARTMENT	DF DRINKING FOUNTAIN	DIAM DIAMETER	DIA DIAGONAL	DIW DIMENSION	DISP DISPENSER	DIV DR DIVISION DOOR	DN DOWN	DP DAMP PROOFING	DR DOOR	DRB DRAIN BOARD	DS DOWN SPOUT	DTL DETAIL	DWG DRAWING	DWR DRAWER	E EAST	EA EACH	EB EXPANSION BOLT	EIB EXTERIOR INSULATION	EFS FINISH SYSTEM	EJ EXPANSION JOINT	EL ELEVATION	ELEC ELECTRICAL	ENCL ENCLOSED	ENGR ENGINEER	EQ ELECTRICAL POWERBOARD	EQU EQUAL	ESC ESCALATOR	EST ESTIMATE	EWG ELECTRIC WATER COOLER	EXC EXISTING	EXP EXPANDED (EXPANSION)	EXT EXTERIOR	FA FIRE ALARM	FAS FASTEN FASTENER	FB FACE BRICK	FBO FURNISHED BY OTHERS	FD FLOOR DRAIN	FE FIRE EXTINGUISHER	FEC FIRE EXTINGUISHER CABINET	FEE FINISHED FLOOR ELEVATION	FLG FLASHING	FJ FJUT	FLX FLEXIBLE	FLR FLOOR	FLUP FLOURESCENT	FND FOUNDATION	FPC FACE OF CONCRETE	FOS FACE OF FINISH	FPM FACE OF MASONRY	FPS FACE OF STUDS	FPR FIREPROOF	FPL FLOOR PLATE	FR FRAME(DING)	FRC FIRE-RESISTANT COATING	FRP FIBERGLASS REINFORCED	FRS FRST	FRS FULL SIZE	FT FT	FTG FOOTING	FUT FUTURE	FUR FURRING	FURN FURNITURE/FURNISHINGS	GA GAUGE	GALV GALVANIZED	GRAB GRAB BAR	GC GENERAL CONTRACTOR	GENL GENERAL	GIR GALVANIZED IRON	GKT GLASS	GLAM GLUE LAMINATED	GPS GALVANIZED PIPE	GSS GALVANIZED STEEL SHEET	GWB GYPSUM WALL BOARD	GYP GYPSUM	GYPBD GYPSUM BOARD	HB HOSE BIBB	HBD HARDBOARD	HC HOLLOW CORE	HD HEAD DUTY	HDS HEADER	HJT HEAD JOINT	HMM HOLLOW METAL	HR HORIZONTAL	HP HIGH POINT	HR HOUR	HW HARDWARE	HT HEIGHT	HDT HEAD HEIGHT	HTG HEATING	HVAC HEATING/VENTILATING/AIR CONDITIONING	HWD HARDWOOD	HOT HOT WATER	HWH HEATER	IBC INSULATED BY CONTRACTOR	ID INSIDE DIAMETER	INCL INSULATION (INCHES)	INFO INFORMATION	INSUL INSULATION	INT INTERIOR	INV INVERT	IPS IRON PIPE SIZE	LAB LABORATORY	LAM LAMINATE	LAV LAVATORY	LB LAG BOLT	LBL LABEL	LF LINEAR FOOT	LH LEFT HAND	LL LIVE LOAD	LS LUMP SUM	LT LIGHT	LVL LAMINATED VENEER LUMBER	LVR LOUVER	M METER	MAS MASONRY	MAT MATERIAL	MAX MAXIMUM	MC MISCELLANEOUS CHANNEL	MECH MECHANICAL	MED MEDIUM	MEMB MEMBRANE	MEP MECHANICAL/ELECTRICAL/PLUMBING	MET METAL	MFR MANUFACTURER	MIN MINIMUM	MIR MIRROR	MISC MISCELLANEOUS	MM MILLIMETER	MN MEMBER	MTO METAL THRESHOLD MOUNTED	N NOT APPLICABLE	NA NATIONAL GEODETIC	NIC VERTICAL DATUM	NO NOT IN CONTRACT	NOM NOMINAL	NTS NOT TO SCALE	ON CENTER	OD OUTSIDE DIAMETER	OPC OFFICE	OPH OPPOSITE HAND	OPCI OWNER PROVIDED CONDITIONING	OPG OWNER PROVIDED	OPOI OWNER INSTALLED	OPP OPPOSITE ROOF DRAIN	OS OUTSIDE OVERALL	PC PRE CAST	PCC PRE CAST CONCRETE	PCE POUNDS PER GIC FOOT	PERIM PERIMETER	PERM PER FINISHED	PH PLATE GLASS	PI PHASE	PJ PANEL JOINT	PL PROPERTY LINE/PLATE	PLAM PLASTER	PLS PLASTIC LAMINATE	PLD POUNDS PER LINEAL FOOT	PLB PLUMBING	PLY PLYWOOD	PNT PANEL	PNT TONGUE AND GROOVE	PNTD PAINTED	POL POLISHED	PR PAIR/PROPOSAL REQUEST	PREFAB PREFABRICATED (ID)	PRELIM PRELIMINARY	PRF PREFORMED	PWF POUNDS PER SQUARE FOOT	PSI POUNDS PER SQUARE INCH	PT POINT/PRESSURE TREATED	PTN PARTITION	PVC POLYVINYL CHLORIDE	PVMT PAVEMENT	QTR QUARRY TILE QUARTER	R RISER	RA RETURN AIR	RAD RADIUS	RB RUBBER BASE	REF REFLECTED CEILING PLAN	REFR REFRIGERATOR	REG REGISTER	REIN REINFORCE(D),(ING)	REQ REQUIRED	RES RESILIENT	RET RETURN	REV REVISION(S),(ID)	RFH ROOF HATCH	RFL RAIN LEADER	RHS RIGHT HAND	RFI REQUEST FOR INFO	RM ROOM	ROOF ROOF OPENING	ROW RIGHT OF WAY	RV RAIN WATER CONDUCTOR REVERSE(SIDE)	S SOUTH	SC SOLID CORE SCHEDULE	SECT SECTION	SECT SECTION	SG SQUARE FOOT	SH SHEET GLASS	SHLV SHELVING	SHT SHEET	SHV VARNISH	SHTH SHEATHING	SM SIMILAR	SN STEEL JOIST	SO SLEEVE	SOL SEALER	SP SLAB ON GRADE	SPC SOUND PROOF	SPCR SPACER	SPEC SPECIAL	SPEK SPEAKER	SPR SPECIAL (SPEAKER)	SQL SQUARE INCH	SO SQUARE	SQY SQUARE YARD	STA STANDARD	SS STAINLESS STEEL	STR STEEL	STD STANDARD	STL STEEL	STOR STORAGE	STR STRUCTURAL	SUS SUSPENDED	SW WOOD	W/W WOOD GLASS	WB WOOD BASE	WD WOOD	WG WIRED GLASS	WH WALL HUNG	WHB WHEEL BUMPER	WI WINDOW	WM WIRED MESH	WO WITHOUT	WPF WATER PROOFING	WR WATER REPELLENT	WST WATER STOP	WSCT WAINSCOT	WT WALL TO WALL	WTF WELDED WIRE FABRIC	UC UNDERCUT	UL UNDERWRITERS LABORATORY	UNF UNFINISHED	UNO UNLESS NOTED OTHERWISE	UR URINAL
----------------	---------------------	------------	-------------------------	---------------------	---------------	--------------	----------------	------------------------	--------------------------	-----------------------	---------------	---------------	---------------	-------------	------------------	-------------------	--------------	--------------	----------------	-----------------	-------------	--------------	---------------	----------------------	---------------	-----------------	--------------	--------------------	------------------	-------------------	------------	----------------	----------	---------------	--------------	-----------------------	--------------	------------------------------	--------------	---------------	-----------------	---------------------	-----------------	--------------------	-------------------	-----------------	-----------------	--------------------------	--------------------	-------------------------	-----------------------	----------------	--------------	--------------------	----------------	------------	--------------	---------------	-----------------	----------------------	---------------	--------------	---------------	----------------	----------------------	---------	------------------	---------	-----------------	---------------	------------	-------------	------------	--------	---------	-------------------	-------------------------	-------------------	--------------------	--------------	-----------------	---------------	---------------	--------------------------	-----------	---------------	--------------	---------------------------	--------------	--------------------------	--------------	---------------	---------------------	---------------	-------------------------	----------------	----------------------	-------------------------------	------------------------------	--------------	---------	--------------	-----------	------------------	----------------	----------------------	--------------------	---------------------	-------------------	---------------	-----------------	----------------	----------------------------	---------------------------	----------	---------------	-------	-------------	------------	-------------	----------------------------	----------	-----------------	---------------	-----------------------	--------------	---------------------	-----------	---------------------	---------------------	----------------------------	-----------------------	------------	--------------------	--------------	---------------	----------------	--------------	------------	----------------	------------------	---------------	---------------	---------	-------------	-----------	-----------------	-------------	---	--------------	---------------	------------	-----------------------------	--------------------	--------------------------	------------------	------------------	--------------	------------	--------------------	----------------	--------------	--------------	-------------	-----------	----------------	--------------	--------------	-------------	----------	-----------------------------	------------	---------	-------------	--------------	-------------	--------------------------	-----------------	------------	---------------	------------------------------------	-----------	------------------	-------------	------------	--------------------	---------------	-----------	-----------------------------	------------------	----------------------	--------------------	--------------------	-------------	------------------	-----------	---------------------	------------	-------------------	----------------------------------	--------------------	----------------------	-------------------------	--------------------	-------------	-----------------------	-------------------------	-----------------	-------------------	----------------	----------	----------------	------------------------	--------------	----------------------	----------------------------	--------------	-------------	-----------	-----------------------	--------------	--------------	--------------------------	---------------------------	--------------------	---------------	----------------------------	----------------------------	---------------------------	---------------	------------------------	---------------	-------------------------	---------	---------------	------------	----------------	----------------------------	-------------------	--------------	-------------------------	--------------	---------------	------------	----------------------	----------------	-----------------	----------------	----------------------	---------	-------------------	------------------	---------------------------------------	---------	------------------------	--------------	--------------	----------------	----------------	---------------	-----------	-------------	----------------	------------	----------------	-----------	------------	------------------	-----------------	-------------	--------------	--------------	-----------------------	-----------------	-----------	-----------------	--------------	--------------------	-----------	--------------	-----------	--------------	----------------	---------------	---------	----------------	--------------	---------	----------------	--------------	------------------	-----------	---------------	------------	--------------------	--------------------	----------------	---------------	-----------------	------------------------	-------------	----------------------------	----------------	----------------------------	-----------

APPLICABLE CODES

- FLORIDA BUILDING CODE (FBC) 2014 EDITION AND AMENDMENTS
 - FLORIDA ACCESSIBILITY CODE 2014 EDITION
 - FLORIDA FIRE PREVENTION CODE (FFPC) 2014, 5TH EDITION
- OTHER APPLICABLE CODE CRITERIA, BUT NOT LIMITED TO THE FOLLOWING:
- NFPA 1, "UNIFORM FIRE CODE," 2012 ED., AS MODIFIED BY FFPC
 - NFPA 10, "STANDARD FOR PORTABLE FIRE EXTINGUISHERS," 2013 EDITION
 - NFPA 13, "STANDARD FOR THE INSTALLATION OF SPRINKLER SYSTEMS," 2013 EDITION
 - NFPA 70, "NATIONAL ELECTRICAL CODE," 2008 EDITION
 - NFPA 72, "NATIONAL FIRE ALARM CODE," 2013 EDITION
 - NFPA 80, "STANDARD FOR FIRE DOORS AND FIRE WINDOWS," 2013 EDITION
 - NFPA 101, "LIFE SAFETY CODE," (LSC) 2012 ED., AS MODIFIED BY THE FFPC
 - NFPA 110, "STANDARD ON EMERGENCY AND STREET POWER SYSTEMS," 2013 EDITION.

DRAWING INDEX

REV. NO.	SHEET NAME
G001	COVER SHEET
G002	GENERAL INFORMATION AND DRAWING INDEX
Grand total: 2	

CIVIL

REV. NO.	SHEET NAME
C-100	SPECIFIC PURPOSE SURVEY
C-101	GENERAL NOTES
C-102	DEMOLITION AND EROSION CONTROL PLAN
C-200	PRELIMINARY SITE PLAN
C-300	GRADINGS AND DRAINAGE PLAN
C-500	SITE AND DRAINAGE DETAILS
Grand total: 6	

ELECTRICAL

REV. NO.	SHEET NAME
E100	LEGENDS, ABBREVIATIONS, AND GENERAL NOTES
E201	ELECTRICAL FLOOR PLAN - BITHLO NEIGHBORHOOD CENTER PARKING LOT
Grand total: 2	

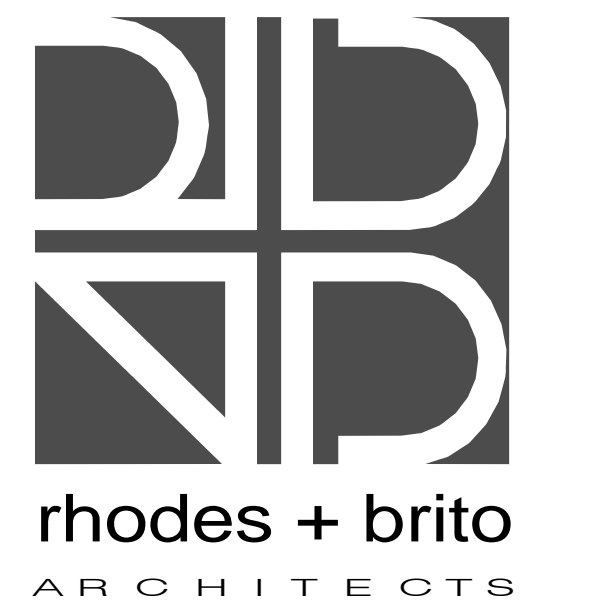

AA0002809
605 E. ROBINSON STREET, SUITE 570
ORLANDO, FL 32801
PH (407) 648 - 7288
www.rhodesbrito.com

Consultants



BITHLO NEIGHBORHOOD FOR CHILDREN AND FAMILIES (NCF)

18566 MADISON AVENUE
ORLANDO, FL 32820

ALL REPRODUCTION AND INTELLECTUAL PROPERTY RIGHTS RESERVED ©

Seal 4/13/2016 9:30:36 AM

MOHAMED SHALABY
AR094103

PERMIT DOCUMENTS

DATE	SUBMISSION / REVISION	NO.

GENERAL INFORMATION AND DRAWING INDEX

SCALE: 12" = 1'-0"

DRAWN BY: CK

CHECK BY: JB

DATE: MARCH 25, 2016

PROJECT NUMBER: 15012-0002

G002

TOPOGRAPHIC SURVEY OF BITHLO CENTER FOR CHILDREN & FAMILIES

LOCATED IN SECTION 22, TOWNSHIP 22 SOUTH, RANGE 32 EAST
ORANGE COUNTY, FLORIDA

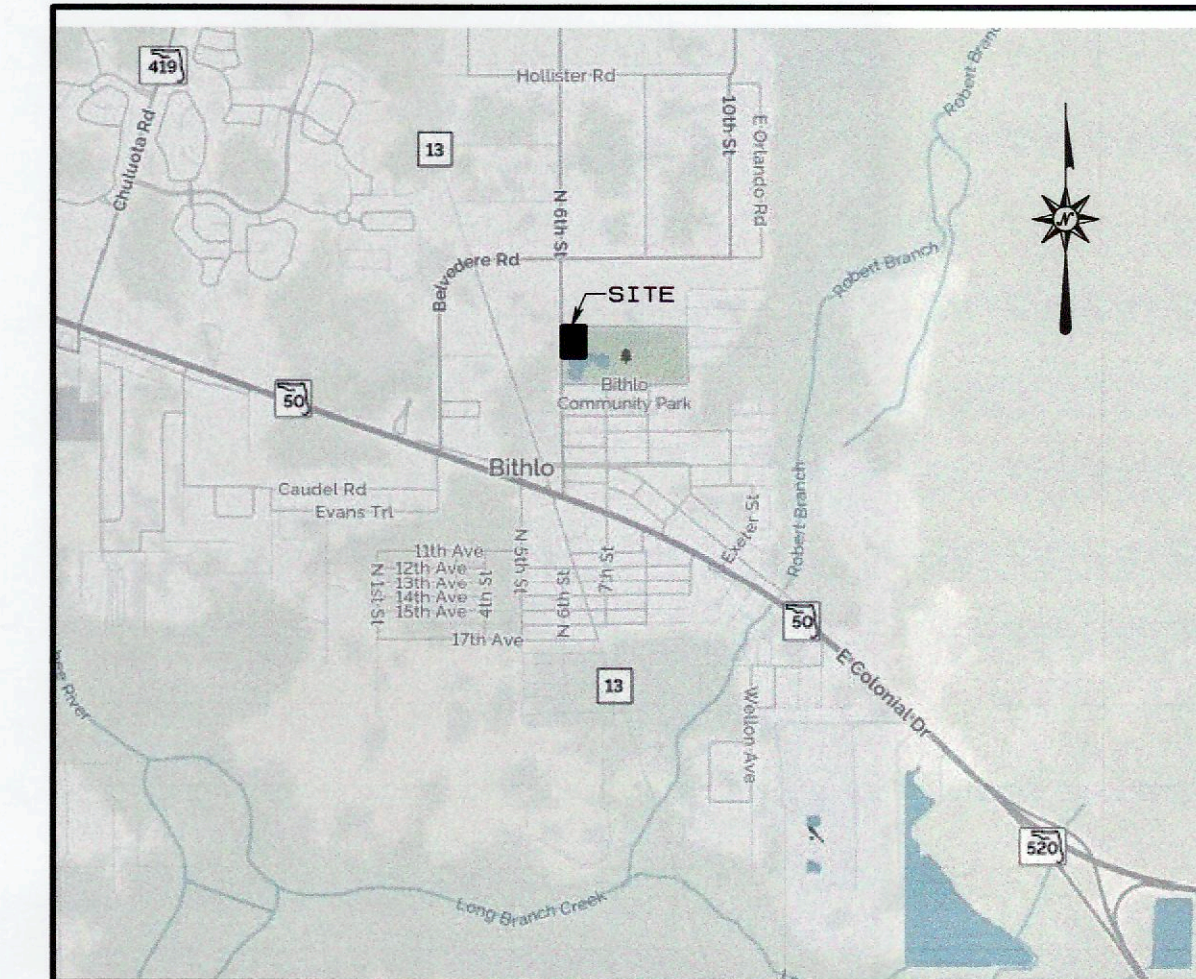
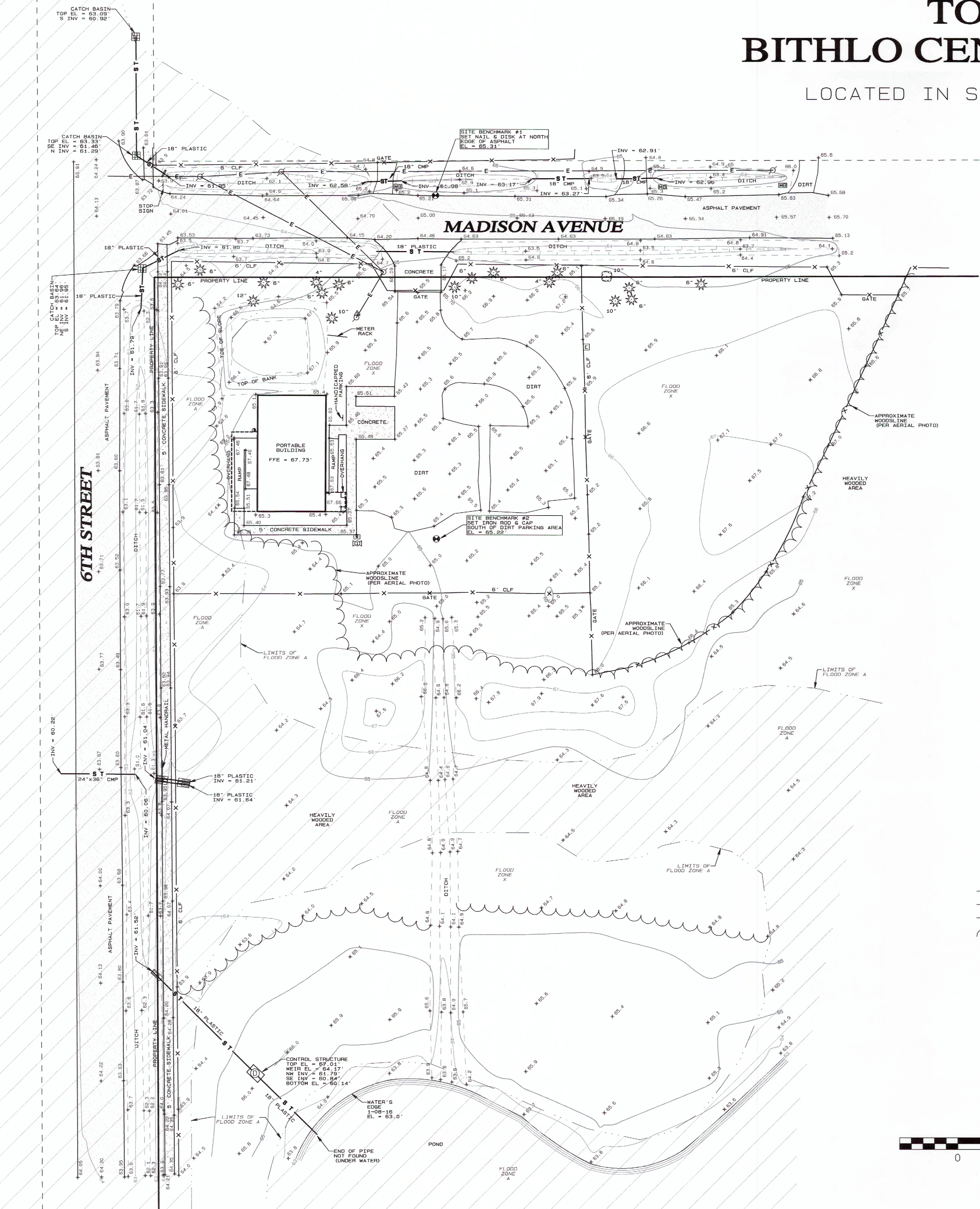

VICINITY MAP



LEGEND

- ⊕ SITE BENCHMARK
- ⊕ CATCH BASIN
- ⊕ STORM MANHOLE
- ⊕ MITERED END SECTION
- ⊕ CLEANOUT
- ⊕ WATER METER
- ⊕ IRRIGATION VALVE
- ⊕ WOOD POWER POLE
- ⊕ CABLE TELEVISION RISER
- ⊕ ELECTRIC BOX
- ⊕ GUY ANCHOR
- ⊕ SIGN
- ⊕ PINE TREE
- ⊕ OAK TREE
- ⊕ MAILBOX
- ⊕ SPOT ELEVATION - HARD SURFACE
- ⊕ SPOT ELEVATION - GROUND SHOT
- ⊕ FENCE LINE
- ⊕ OVERHEAD ELECTRIC LINE
- ⊕ ST- STORM SEWER LINE
- ⊕ WOODSLINE
- ⊕ CMP CORRUGATED METAL PIPE
- ⊕ FFE FINISHED FLOOR ELEVATION
- ⊕ EL ELEVATION
- ⊕ INV INVERT
- ⊕ CLF CHAIN LINK FENCE
- ⊕ LB LICENSED BUSINESS
- ⊕ PSM PROFESSIONAL SURVEYOR & MAPPER

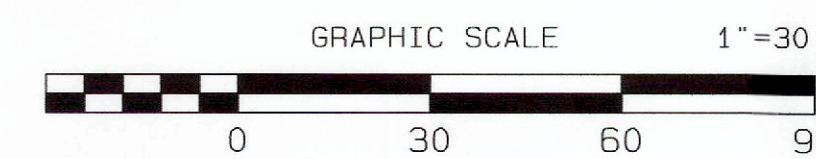

SURVEYOR'S NOTES

1. THIS IS NOT A BOUNDARY SURVEY. THE PARCEL BOUNDARY AND STREET RIGHT-OF-WAY LINES SHOWN HEREON ARE SHOWN PER THE ORANGE COUNTY GIS PARCEL LAYER AND HAVE NOT BEEN FIELD VERIFIED.
2. THIS TOPOGRAPHIC SURVEY WAS PREPARED FOR TR13 CIVIL ENGINEERING. ADDITIONS OR DELETIONS BY ANYONE OTHER THAN THE SIGNING PARTY ARE PROHIBITED WITHOUT THE WRITTEN CONSENT OF LEADING EDGE LAND SERVICES, INC.
3. THIS TOPOGRAPHIC SURVEY IS SUBJECT TO ALL EASEMENTS AND RESTRICTIONS OF RECORD. NO TITLE INFORMATION WAS PROVIDED TO THE SURVEYOR.
4. UNLESS OTHERWISE NOTED, SURVEY MEASUREMENTS AND PLOTTED FEATURES SHOWN ON THIS SURVEY ARE BASED ON ACTUAL FIELD MEASUREMENTS.
5. THE ACCURACY OF THIS SURVEY MEETS OR EXCEEDS STANDARDS SET FORTH IN ADMINISTRATIVE RULE 5J-17 STANDARDS OF PRACTICE FOR SURVEYORS AND MAPPERS.
6. THE VERTICAL DATUM FOR THIS SURVEY IS NORTH AMERICAN VERTICAL DATUM OF 1988 (NAVD 88). THE BENCHMARK THIS SURVEY IS BASED ON IS DESCRIBED AS FOLLOWS: SITE BENCHMARK SHOWN ON PLAN FOR GRADING, DRAINAGE AND PARKING AREAS FOR THE BITHLO PARK CHILDREN'S CENTER PREPARED BY TEK SCIENCE AND ENGINEERING CORPORATION UNDER PROJECT NUMBER 07-950 DATED 6/31/07, PUBLISHED ELEVATION = 65.14 FEET RELATIVE TO THE NATIONAL GEODETIC VERTICAL DATUM OF 1929 (NGVD 29). THIS NGVD 29 ELEVATION WAS CONVERTED TO NAVD 88 USING A LOCAL CONVERSION FACTOR DETERMINED FROM ORANGE COUNTY BENCHMARKS IN THE AREA. SITE BENCHMARKS ARE SHOWN AND DESCRIBED GRAPHICALLY ON THE SURVEY.
7. ONLY VISIBLE IMPROVEMENTS WERE LOCATED AND ARE SHOWN AS PART OF THIS SURVEY. NO ATTEMPT WAS MADE TO LOCATE OR VERIFY SUBSURFACE IMPROVEMENTS OR ENCROACHMENTS.
8. A REVIEW OF FLOOD INSURANCE RATE MAPS FOR ORANGE COUNTY, FLORIDA, INDICATES THAT A PORTION OF THIS PROPERTY LIES WITHIN ZONE A (SPECIAL FLOOD HAZARD AREAS SUBJECT TO 1% ANNUAL CHANCE FLOOD, NO BASE FLOOD ELEVATIONS DETERMINED) AND THAT THE REMAINDER OF THIS PROPERTY LIES WITHIN ZONE X (AREAS DETERMINED TO BE OUTSIDE THE 0.2% ANNUAL CHANCE FLOODPLAIN). THIS INFORMATION WAS TAKEN FROM MAP NUMBER 12095C0315F, REVISED SEPTEMBER 25, 2009. THE LIMITS OF THE FLOOD ZONE SHOWN ON THIS SURVEY ARE BASED ON DIGITAL DATA AVAILABLE FROM STATEWIDE GIS DATABASE.

REVISIONS:

SURVEYOR'S CERTIFICATION
I, THE UNDERSIGNED, FLORIDA LICENSED SURVEYOR AND MAPPER, DO HEREBY CERTIFY THAT I HAVE COMPLETED THIS SURVEY IN ACCORDANCE WITH FLORIDA ADMINISTRATIVE RULE 5J-17 STANDARDS OF PRACTICE FOR SURVEYORS AND MAPPERS.

DATE OF DRAWING: 14 JAN 2016
PROJECT NUMBER: 632-15010
FIELD BOOK NUMBER: LE 1087
DATE: 01/15/2016
JEFFREY D. HOTIUS, PSM #6610

TOPOGRAPHIC SURVEY

OF
BITHLO CENTER FOR CHILDREN & FAMILIES

SECTION 22, TOWNSHIP 22 SOUTH, RANGE 32 EAST
ORANGE COUNTY, FLORIDA

FOR
TR13 CIVIL ENGINEERING

NOT VALID WITHOUT THE SIGNATURE AND THE ORIGINAL RAISED SEAL OF A FLORIDA LICENSED SURVEYOR AND MAPPER

LEADING EDGE LAND SERVICES
11415 PINE BLVD. #100
ORLANDO, FLORIDA 32809
PHONE: (407) 351-6730
FAX: (407) 351-6661
WWW.LEADINGEDGE1S.COM
FLORIDA LICENSED BUSINESS NUMBER LB 6846

C-100

LAST FIELD WORK:	11 JAN 2016
CHECK CHIEF (S):	NAC
COMPUTER FILE:	63210TP.PRO
SCALE:	1" = 30'
SHEET:	1 OF 1

SITE UTILITY NOTES

1. THE LOCATION OF EXISTING UTILITIES, SUCH AS WATER MAINS, SEWERS, GAS LINES, ETC. AS SHOWN ON THE PLANS HAVE BEEN DETERMINED FROM THE BEST AVAILABLE INFORMATION AND IS PROVIDED FOR THE CONVENIENCE OF THE CONTRACTOR. BE ADVISED THAT THE ENGINEER AND OWNER DO NOT ASSUME RESPONSIBILITY FOR THE ACCURACY OF THE LOCATIONS SHOWN. IT SHALL BE THE RESPONSIBILITY OF THE CONTRACTOR TO CONTACT ALL UTILITY COMPANIES FORTY-EIGHT (48) HOURS PRIOR TO COMMENCEMENT OF CONSTRUCTION IN ORDER TO HAVE THE UTILITIES MARKED AND LOCATED IN THE FIELD PRIOR COMMENCEMENT OF ANY WORK.
2. ANY DAMAGE TO UNDERGROUND UTILITIES AND/OR STRUCTURES SHALL BE REPAIRED AT THE CONTRACTORS EXPENSE.
3. ALL MATERIALS AND CONSTRUCTION ARE TO BE IN ACCORDANCE WITH STATE, AND COUNTY STANDARDS AND SPECIFICATIONS.
4. ONSITE WASTEWATER IS SEPTIC. ANY QUESTIONS CONCERNING THE ONSITE SEWAGE SYSTEM SHALL BE ADDRESSED BY THE ORANGE COUNTY HEALTH DEPT. AS APPLICABLE.
5. ONSITE DRINKING WATER SOURCE IS WELL. THE WELL IS OWNED AND MAINTAINED BY THE ORANGE COUNTY PARKS DEPARTMENT.

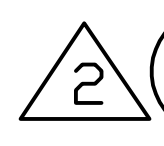

DEMOLITION AND EROSION CONTROL NOTES:

1. CONTRACTOR SHALL COORDINATE WITH ALL UTILITY COMPANIES PRIOR TO START ANY CONSTRUCTION ACTIVITY TO OBTAIN DIG PERMITS, ELECTRICAL PERMITS OR OTHER PERMITS, AS APPLICABLE. CONTRACTOR SHALL ALSO COORDINATE WITH ALL APPLICABLE UTILITY COMPANIES ON THE EXACT LOCATION OF UNDERGROUND UTILITIES AND ANY UTILITY ADJUSTMENT REQUIRED. UTILITY COMPANIES SHALL BE NOTIFIED A MINIMUM OF SEVEN (7) WORKING DAYS PRIOR TO EXCAVATION.
2. THE LOCATION OF EXISTING UTILITIES PROVIDED ON THESE PLANS WERE DEPICTED FROM ACTUAL FIELD MEASUREMENTS AND/OR DERIVED FROM RECORD DRAWINGS THAT WERE VERIFIED FROM THE BEST AVAILABLE SOURCE. IT IS THE CONTRACTOR'S RESPONSIBILITY TO CONFIRM THE LOCATION OF EXISTING UTILITIES PRIOR TO START OF CONSTRUCTION TO DETERMINE IF THERE ARE ANY CONFLICTS WITH THE PROPOSED CONSTRUCTION AND TO COORDINATE WITH UTILITY OWNERS, PROPERTY OWNER, AND ENGINEER OF RECORD TO RESOLVE THESE CONFLICTS. ALL UTILITIES SHALL BE FIELD VERIFIED PRIOR TO START OF CONSTRUCTION.
3. EXISTING ROADWAY BASE MATERIALS, SUCH AS SHELL OR LIMESTONE, MAY BE UTILIZED IN STABILIZATION IF SUITABLE FOR MIXING, AS APPROVED BY THE GEOTECHNICAL ENGINEER.
4. ALL DEBRIS AND WASTE MATERIALS GENERATED BY DEMOLITION ACTIVITIES OR SUBSEQUENT CONSTRUCTION ACTIVITIES SHALL BE DISPOSED OF OFF-SITE IN A LEGAL MANNER AT AN APPROVED DISPOSAL FACILITY. THE CONTRACTOR SHALL OBTAIN ANY AND ALL PERMITS REQUIRED FOR DEMOLITION, INCIDENTAL CONSTRUCTION WORK, EARTHWORK, AND HAULING WASTE MATERIALS AS REQUIRED BY ORANGE COUNTY AND/OR FDEP. ALL ASSOCIATED COSTS AND PERMIT FEES SHALL BE THE RESPONSIBILITY OF THE CONTRACTOR.
5. THE CONTRACTOR SHALL PROVIDE ALL SHEETING, SHORING AND BRACING AS REQUIRED TO PROTECT ADJACENT STRUCTURES AND UTILITIES OR TO MINIMIZE TRENCH WIDTH AS NECESSARY. SHEETING AND SHORING SHALL BE DESIGNED BY A STATE OF FLORIDA REGISTERED P.E., RETAINED BY THE CONTRACTOR.
6. THE CONTRACTOR SHALL FURNISH, ERECT AND MAINTAIN ALL NECESSARY TRAFFIC CONTROL AND SAFETY DEVICES IN ACCORDANCE WITH THE "MANUAL ON UNIFORM TRAFFIC CONTROL DEVICES" AND THE LATEST FLORIDA DEPARTMENT OF TRANSPORTATION "ROADWAY DESIGN STANDARDS".
7. MAINTENANCE OF TRAFFIC: ACCESS FOR LOCAL TRAFFIC WITHIN THE PROJECT LIMITS SHALL BE MAINTAINED AT ALL TIMES, UNLESS APPROVED OTHERWISE BY THE LOCAL CITY, COUNTY, OR STATE FDOT. IF DURING CONSTRUCTION ACCESS FOR LOCAL TRAFFIC IS CHANGED, THE CONTRACTOR SHALL NOTIFY THE GOVERNING AGENCY A MINIMUM OF THREE (3) WORKING DAYS IN ADVANCE. MAINTENANCE OF TRAFFIC SHALL BE IN ACCORDANCE WITH INDEX NO. 600 OF THE STATE OF FLORIDA DEPARTMENT OF TRANSPORTATION (FDOT) ROADWAY AND TRAFFIC DESIGN STANDARDS.
8. SILT SCREENS AND TURBIDITY BARRIERS INSTALLED MUST REMAIN IN PLACE AND MAINTAINED IN GOOD CONDITION AT ALL LOCATIONS SHOWN ON THE APPROVED EROSION CONTROL PLAN AND THE APPROVED STORMWATER POLLUTION PREVENTION PLAN (SWPPP) UNTIL ALL CONSTRUCTION ACTIVITIES ARE COMPLETED, SOILS ARE STABILIZED AND VEGETATION HAS BEEN ESTABLISHED.
9. THE EROSION CONTROL MEASURES SET FORTH IN THESE PLANS ARE INTENDED AS MINIMUM STANDARDS. ANY ADDITIONAL EROSION CONTROL MEASURES REQUIRED BY ORANGE COUNTY, FDEP, SURMMD, OR FDOT BEYOND THAT WHICH HAS BEEN SPECIFIED ON THE PLANS SHALL BE CONSIDERED AS INCLUDED WITHIN THIS CONTRACT. 10.
10. ALL EROSION AND SEDIMENT CONTROL WORK SHALL CONFORM TO THE DESIGN STANDARDS OF ORANGE COUNTY, SURMMD, FDEP, AND THE FDOT.
11. EROSION AND SEDIMENT CONTROL MEASURES ARE TO BE PLACED PRIOR TO START OF CONSTRUCTION. SEDIMENTATION CONTROL PRACTICES WILL BE APPLIED AS A PERIMETER DEFENSE AGAINST ANY TRANSPORTATION OF SILT OFF OF THE SITE.
12. SEDIMENT MATERIALS FROM WORK ON THIS PROJECT SHALL BE CONTAINED AND NOT ALLOWED TO COLLECT ON ANY OFF-PERIMETER AREAS OR DISCHARGE INTO WATERWAYS. THESE INCLUDE BOTH NATURAL AND MAN-MADE OPEN DITCHES, STREAMS, STORM DRAINS, LAKES AND PONDS.
13. DAILY INSPECTIONS SHALL BE MADE BY THE CONTRACTOR TO DETERMINE THE EFFECTIVENESS OF EROSION/SEDIMENT CONTROL EFFORTS. ANY NECESSARY REMEDIES SHALL BE PERFORMED WITHOUT DELAY.
14. ALL MUD, DIRT OR OTHER MATERIALS TRACKED OR SPILLED ONTO EXISTING PUBLIC OR PRIVATE ROADS AND FACILITIES, DUE TO CONSTRUCTION SHALL BE PROMPTLY REMOVED BY THE CONTRACTOR.
15. THE CONTRACTOR SHALL BE RESPONSIBLE FOR ENSURING THAT ALL THE REQUIRED CONSTRUCTION PERMITS HAVE BEEN OBTAINED PRIOR TO COMMENCING WORK.
16. THE CONTRACTOR SHALL MAINTAIN TREE PROTECTION MEASURES THROUGHOUT DURATION OF CONSTRUCTION ACTIVITIES. THE CONTRACTOR MAY NOT BE ALLOWED TO STORE MATERIALS OR EQUIPMENT, INCLUDING VEHICULAR PARKING, UNDER THE CANOPY OF TREES OR WITHIN TREE PROTECTED AREAS.
17. INGRESS AND EGRESS TO THE SITE DURING CONSTRUCTION IS ALLOWED ONLY THROUGH APPROVED SITE DRIVEWAYS.
18. THE STORMWATER POLLUTION PREVENTION PLAN (SWPPP) SHALL BE AVAILABLE ON-SITE AT ALL TIMES DURING CONSTRUCTION. THE CONTRACTOR SHALL PREPARE WEEKLY INSPECTION REPORTS PER FDEP.

GRADING AND DRAINAGE NOTES

1. EXISTING TOPOGRAPHY AND ROADWAY RIGHT-OF-WAY DATA SHOWN ARE BASED UPON TOPOGRAPHIC SURVEY BY LEADING EDGE LAND SERVICES, INC.
2. ALL GRADING AND SITE PREPARATION WILL CONFORM TO SPECIFICATIONS AS RECOMMENDED IN THE REPORT OF GEOTECHNICAL INVESTIGATION PREPARED BY ARDAMAN & ASSOCIATES, INC.
3. THE CONTRACTOR SHALL VERIFY EXISTING TOPOGRAPHIC DATA LOCATIONS OF EXISTING UTILITIES, AND ALL OTHER SITE CONDITIONS PRIOR TO START OF CONSTRUCTION.
4. ALL CONSTRUCTION WITHIN STREET RIGHTS-OF-WAY SHALL CONFORM TO APPLICABLE STATE AND LOCAL JURISDICTIONAL REQUIREMENTS.
5. ALL OPEN DRAINAGE SWALES SHALL BE GRASSED, AND RIP RAP MUST BE PLACED AS NECESSARY TO CONTROL EROSION (WHERE APPLICABLE).
6. THE CONTRACTOR IS RESPONSIBLE FOR STRIPPING AND STOCKPILING OF TOPSOIL. THE CONTRACTOR ALSO RESPONSIBLE FOR SPREADING 4" OF TOPSOIL ON LANDSCAPE AREAS AND REMOVING ALL EXCESS TOPSOIL FROM THE SITE.
7. GRADING CONTRACTOR SHALL PROVIDE AND INSTALL TOPSOIL IN DISTURBED AREAS TO BE GRASSED, TO INCLUDE PAVEMENT SHOULDERS AND DETENTION AREAS.
8. FOR BENCHMARK INFORMATION REFER TO THE TOPOGRAPHIC SURVEY PLAN SHEET C-100.
9. ALL GRADES SHOWN ARE FINISHED GRADES UNLESS NOTED OTHERWISE.
10. INLET ELEVATIONS AND MANHOLE ELEVATIONS ARE TOP OF RIM. (WHERE APPLICABLE)
11. ALL MATERIALS, INSTALLATION, AND TESTING SHALL BE IN ACCORDANCE WITH ORANGE COUNTY AND THE FLORIDA DEPARTMENT OF TRANSPORTATION STANDARD SPECIFICATIONS FOR ROAD AND BRIDGE CONSTRUCTION. WHERE THE SPECIFICATIONS CONFLICT, THE MOST STRINGENT SPECIFICATION SHALL APPLY.
12. COORDINATE VALUES, IF SHOWN, ARE BASED ON A LOCAL GRID ESTABLISHED BY THE SURVEYOR.
13. ALL AREAS DISTURBED BY CONSTRUCTION ACTIVITIES SHALL BE GRADED TO ORIGINAL GROUND LINES AND FINISHED WITH ARGENTINE BAHIA SOD UNLESS NOTED OTHERWISE ON THE PLANS. THE CONTRACTOR SHALL MAINTAIN ALL AREAS UNTIL FINAL ACCEPTANCE.
14. SUBSURFACE INFORMATION FOR THIS PROJECT WAS OBTAINED FOR DESIGN PURPOSES AND MAY NOT BE AN ADEQUATE REPRESENTATION OF ACTUAL CONDITIONS AT TIME OF CONSTRUCTION. INFORMATION SHOWN, INCLUDING WATER LEVELS, REPRESENT EXISTING CONDITIONS AT THE SPECIFIC BORING LOCATIONS AND AT THE TIME THE BORINGS WERE PERFORMED.
15. ALL REFERENCES TO PROPOSED CONSTRUCTION INDICATES CONSTRUCTION INCLUDED IN THIS CONTRACT.
16. ANY DIFFERING SITE CONDITIONS FROM THAT WHICH IS REPRESENTED HEREON, WHETHER ABOVE, ON OR BELOW THE SURFACE OF THE GROUND, SHALL BE BROUGHT TO THE IMMEDIATE ATTENTION OF THE ENGINEER OR ARCHITECT OF RECORD, IN WRITING, AND WITHIN 48 HOURS OF DISCOVERY. NO CLAIM FOR EXPENSES INCURRED BY THE CONTRACTOR DUE TO SUCH DIFFERING CONDITIONS WILL BE ALLOWED IF HE OR SHE FAILS TO PROVIDE WRITTEN NOTIFICATION.

NOTES PERTAINING TO AIR QUALITY CONTROL MEASURES

1. NO PERSON SHALL CAUSE, LET, SUFFER, ALLOW, OR PERMIT THE EMISSIONS OF UNCONFINED PARTICULATE MATTER FROM ANY ACTIVITY, INCLUDING VEHICULAR MOVEMENT, TRANSPORTATION OF MATERIALS, CONSTRUCTION, ALTERATION, DEMOLITION OR WRECKING, OR INDUSTRIALLY RELATED ACTIVITIES SUCH AS LOADING, UNLOADING, STORING, OR HANDLING, WITHOUT TAKING REASONABLE PRECAUTIONS TO PREVENT SUCH EMISSIONS.
2. REASONABLE PRECAUTIONS TO PREVENT SUCH EMISSIONS ARE LISTED IN ORANGE COUNTY CODE, REFER TO ORANGE COUNTY CODE CHAPTER 15: ENVIRONMENTAL CONTROL, ARTICLE III- AIR QUALITY CONTROL, 15-89.1 (b).

UTILITY SEPARATION NOTES

LOCATION OF PUBLIC WATER SYSTEM MAINS IN ACCORDANCE WITH F.A.C. RULE 62-555.314

OTHER PIPE	HORIZONTAL SEPARATION	CROSSINGS (1)	JOINT SPACING @ CROSSINGS (FULL JOINT CENTERED)
STORM SEWER, STORMWATER FORCE MAIN, RECLAIMED WATER (2)	3 FT. MINIMUM	12 INCHES IS THE MINIMUM, EXCEPT FOR STORM SEWER, THEN 6 INCHES IS THE MINIMUM AND 12 INCHES IS PREFERRED	ALTERNATE 3 FT. MINIMUM
VACUUM SANITARY SEWER	10 FT. PREFERRED 3 FT. MINIMUM	12 INCHES PREFERRED 6 INCHES MINIMUM	ALTERNATE 3 FT. MINIMUM
GRAVITY OR PRESSURE SANITARY SEWER, SANITARY SEWER FORCE MAIN, RECLAIMED WATER (4)	10 FT. PREFERRED 6 FT. MINIMUM (3)	12 INCHES IS THE MINIMUM, EXCEPT FOR GRAVITY SEWER, THEN 6 INCHES IS THE MINIMUM AND 12 INCHES IS PREFERRED	ALTERNATE 6 FT. MINIMUM
ON-SITE SEWAGE TREATMENT AND DISPOSAL SYSTEM	10 FT. MINIMUM	---	---

(1) WATER MAIN SHOULD CROSS ABOVE OTHER PIPE. WHEN WATER MAIN MUST BE BELOW OTHER PIPE, THE MINIMUM SEPARATION IS 12 INCHES.
 (2) RECLAIMED WATER REGULATED UNDER PART III OF CHAPTER 62-610, F.A.C.
 (3) 3 FT. FOR GRAVITY SANITARY SEWER WHERE THE BOTTOM OF THE WATER MAIN IS LAID AT LEAST 6 INCHES ABOVE THE TOP OF THE GRAVITY SANITARY SEWER.
 (4) RECLAIMED WATER NOT REGULATED UNDER PART III OF CHAPTER 62-610, F.A.C.
 DISCLAIMER - THIS DOCUMENT IS PROVIDED FOR YOUR CONVENIENCE ONLY. PLEASE REFER TO F.A.C. RULE 62-555.314 FOR ADDITIONAL CONSTRUCTION REQUIREMENTS.



rhodes + brito
ARCHITECTS
AA0002809
605 E. ROBINSON STREET, SUITE 750
ORLANDO, FL 32801
PH (407) 648-7288
www.rhodesbrito.com

Consultants



BITHLO NEIGHBORHOOD CENTER FOR CHILDREN AND FAMILIES (NCF)

18566 MADISON AVENUE
ORLANDO, FL 32820

ALL REPRODUCTION AND INTELLECTUAL PROPERTY RIGHTS RESERVED ©

Seal 3/21/2016 4:59:23 PM

CONSTANCE A. OWENS, P.E., LEED AP
FLORIDA LICENSE #54842

PERMIT DOCUMENTS

DATE	SUBMISSION / REVISION	NO.
04/04/16	SURMMD	1
05/24/16	ORANGE COUNTY COMMENTS	2

GENERAL NOTES

SCALE: AS SHOWN
 DRAWN BY: SAH
 CHECK BY: CAO
 DATE: MARCH 25, 2016
 PROJECT NUMBER: 15012-0002

C-101

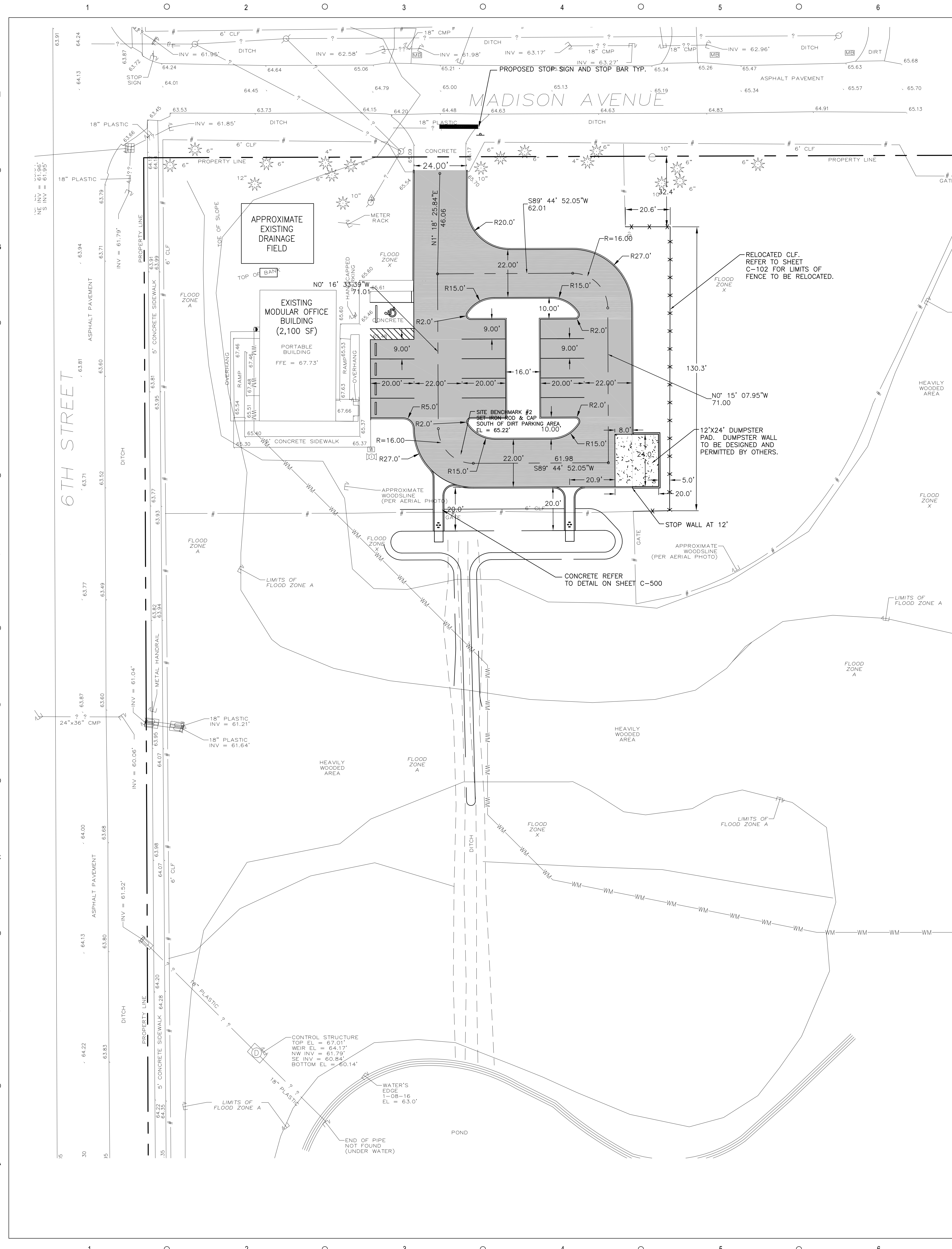

- PROJECT DATA:**
- EXISTING ZONING: R-T-2
 - PROPOSED ZONING: R-T-2
 - FUTURE LAND USE: P/R
 - BUILDING AREA: 2,100 GSF (EXISTING)
 - GROSS/NET ACREAGE: 37.88 ACRES (1,649,984 SF)
 - CONSTRUCTION PLAN PHASING: THIS DEVELOPMENT SHALL BE CONSTRUCTED IN ONE PHASE.
 - STORMWATER UTILITY SERVICE: STORMWATER RETENTION SHALL COMPLY WITH ORANGE COUNTY SUBDIVISION REGULATIONS AND THE ST JOHN'S RIVER WATER MANAGEMENT DISTRICT (SJRWD) REGULATIONS.
 - SOIL TYPES: 44 - SMYRNA-SYMRNA
 - PARKING REQUIREMENTS: PARKING SPACES REQUIRED = 2,100 SF X 1 SPACE/200 SF = 11
PARKING SPACES PROVIDED = 15
 - ALL STRIPING SHALL BE LEAD-FREE THERMOPLASTIC
 - IMPERVIOUS/PERVIOUS RATIO:

BITHLO PARK CHILDRENS CENTER - SJRWD PERMIT DATA: (PERMIT #40-095-27606-4)

BUILDING:	2,100 SF
DECKS/RAMPS:	575 SF
CONCRETE:	1,209 SF
STABILIZED SUB-GRADE:	8,644 SF
TOTAL:	12,528 SF

BITHLO NEIGHBORHOOD CENTER FOR CHILDREN AND FAMILIES (PREVIOUSLY REFERRED TO AS BITHLO PARK CHILDRENS CENTER)

BUILDING:	2,100 SF
DECKS/RAMPS:	575 SF
CONCRETE:	1,779 SF
STABILIZED SUB-GRADE:	10,466 SF
TOTAL:	14,900 SF**

** MASTER PLAN PERMIT ALLOWS FOR 15,900 SF OF DEVELOPMENT PERMIT #40-095-27606-4

UTILITY PROVIDERS:
 WATER SUPPLY - ORANGE COUNTY PARKS (ONSITE WELL)
 SEWER - SEPTIC
 POWER - DUKE ENERGY

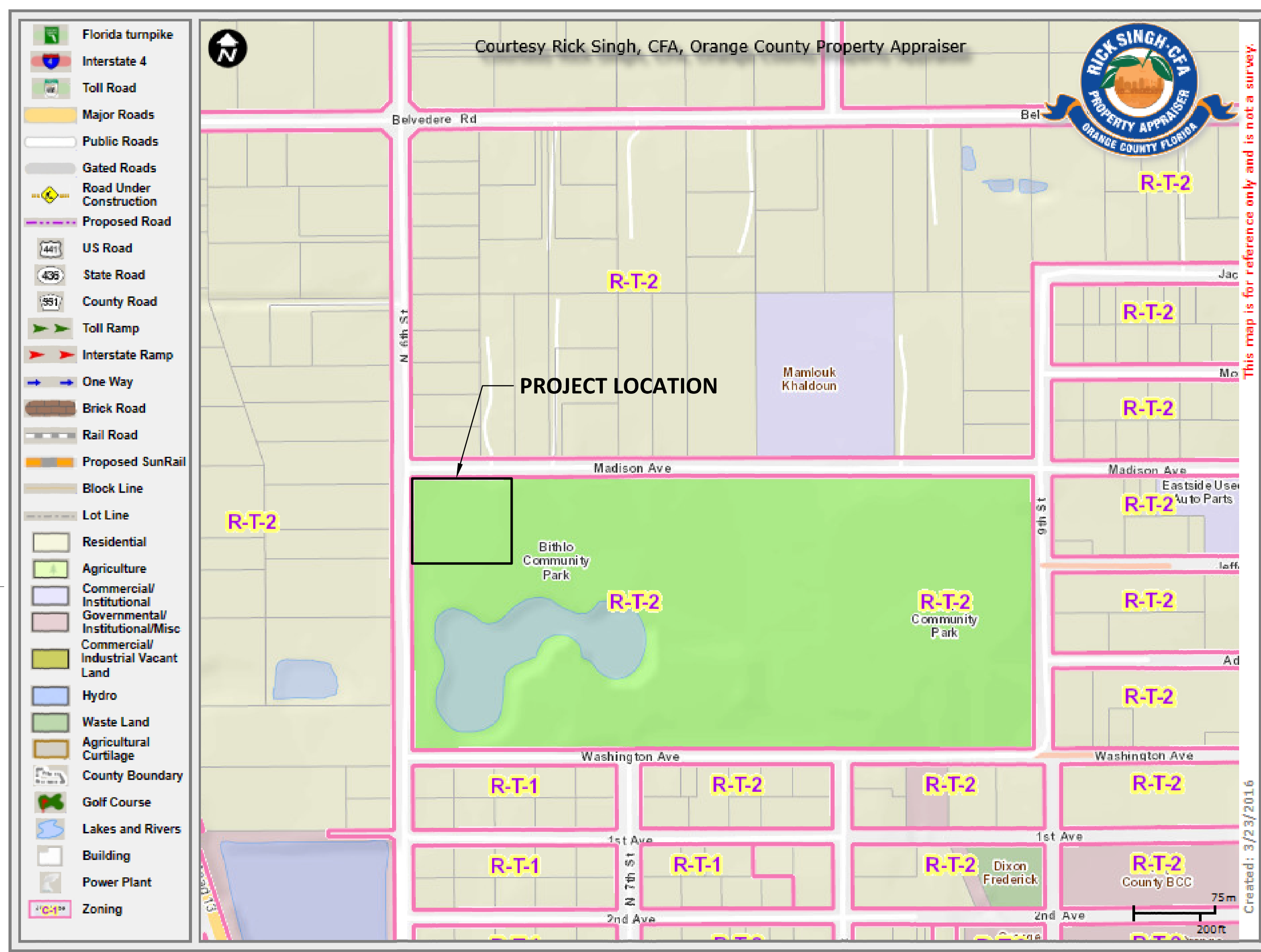

ZONING MAP

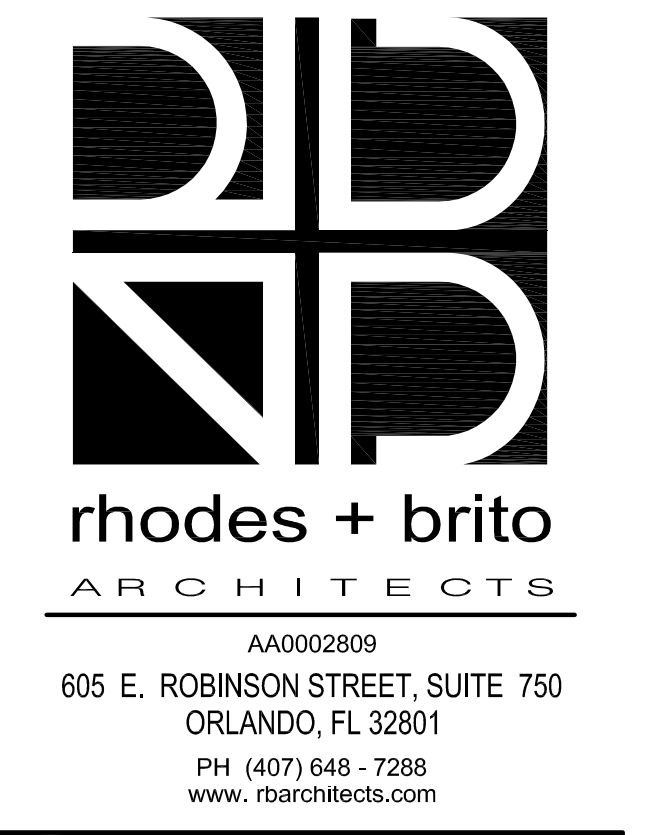

BITHLO NEIGHBORHOOD CENTER FOR CHILDREN AND FAMILIES (NCF)

18566 MADISON AVENUE
ORLANDO, FL 32820
ALL REPRODUCTION AND INTELLECTUAL PROPERTY RIGHTS RESERVED ©
Seal 3/21/2016 4:59:23 PM

CONSTANCE A. OWENS, P.E., LEED AP
FLORIDA LICENSE #54842
PERMIT DOCUMENTS

DATE	SUBMISSION / REVISION	NO.
04/04/16	SJRWD	1
05/24/16	ORANGE COUNTY COMMENTS	2

SITE PLAN

SCALE: AS SHOWN
 DRAWN BY: SAH
 CHECK BY: CAO
 DATE: MARCH 25, 2016
 PROJECT NUMBER: 15012-0002

C-200

LEGEND

- PHOTOCELL
- EXISTING PANEL
- EXISTING SERVICE DISCONNECT
- UTILITY METER
- POLE-MOUNTED AREA LIGHT

ABBREVIATIONS

A	AMPERE	MA	MILLIAMPERES
ABB	ANIMATION BREAKOUT BOX	MSB	MONITOR BREAKOUT BOX
AC	AIR CONDITIONING	MCB	MAIN CIRCUIT BREAKER
AC	ALTERNATE CURRENT	MCC	MOTOR CONTROL CENTER
AF	AMPERE FRAME WHEN USED WITH CIRCUIT BREAKER	MCM	1000 CIRCULAR MILLS
AFF	ABOVE FINISHED FLOOR	MECH	MECHANICAL
AH	AIR HANDLER	MIC	MICROPHONE
AIC	AMPERE INTERRUPTING CAPACITY	MIN	MINIMUM
AM & CS	AUTOMATIC MONITORING & CONTROL SYSTEM	MISC	MISCELLANEOUS
AT	AMPERE TRIP	MLO	MAIN LUGS ONLY
ATSS	AUTOMATIC TRANSFER SWITCH	MM	MULTI-MODE
AUX	AUXILIARY	MFD	MOUNTED
AWG	AMERICAN WIRE GAUGE	N/A	NON-AUTOMATIC
BC	BARE COPPER	NO	NORMALLY CLOSED
BWR	BREAKER	NF	NON-USED
BOH	BACK-OF-HOUSE	NFPA	NATIONAL FIRE PROTECTION ASS.
C	CONDUIT	NO	NORMALLY OPEN
CA	CABINET	NTS	NOT TO SCALE
CAB	CABLE	OLS	OVERLOADS
CATSE	CATEGORY-SE	OC	ON CENTER
CC	CABLE CONDUCTORS	P	POLE
CKT	CIRCUIT	PB	PULLBOX
CMH	COMMUNICATION MANHOLE	PNL	PANEL
CO	CONDUIT ONLY	PR	PAIR
CPB	COMMUNICATION PULLBOX	PVC	POLYVINYL CHLORIDE
CUC	COMMON USER CABLE	PWR	POWER
CUTC	COMMON USER TERMINAL CABINET	POC	POINT OF CONNECTION
COMM	COMMUNICATION	POS	POINT OF SALES
D	DEEP	REF	REFERENCE
DACS	DIGITAL ANIMATION CONTROL SYSTEM	RIS	RIGID GALVANIZED STEEL
DC	DIMMING CABINET	RM	ROOM
DISC	DISCONNECT	RMS	ROOT-MEAN-SQUARE
DN	DOWN	TRU	REMOTE TERMINAL UNIT
DPST	DOUBLE POLE SINGLE THROW	RFT	RECEFTABLE
DPDT	DOUBLE POLE DOUBLE THROW	SBS	SOUND BREAKOUT BOX
EER	ELECTRICAL EQUIPMENT ROOM	SDB	SOUND DISTRIBUTION BOX
ELECT	ELECTRICAL	SM	SPECIFICATIONS
ELEV	ELEVATION	SPKR	SPEAKER
EMT	ELECTRICAL METALLIC TUBING	SPST	SINGLE POLE SINGLE THROW
EP	EXPLOSION PROOF	SR	SOUND RACK
EQUIP	EQUIPMENT	SST	STAINLESS STEEL
EXIST	EXISTING	ST	SHUNT TRIP
F	FUSE	SW	SWITCH
FACP	FIRE ALARM CONTROL PANEL	SWBD	SWITCHBOARD
FBO	FURNISHED BY OWNER	TEL	TELEPHONE
FDR	FEEDER	TP	TWISTED PAIR CABLE
FLA	FULL LOAD AMPERES	TB	TELEPHONE TERMINAL BOARD
GFI	GROUND FAULT INTERRUPT	TYP	TYPICAL
GRD	GROUND	V	VOLT
H	HIGH	W	WATT, WIRE, WIDE
HP	HORSEPOWER	WP	WEATHERPROOF
HZ	HERTZ	XFMR	TRANSFORMER
IC	INTERCOM		
IG	ISOLATED GROUND		
IMC	INTERMEDIATE METAL CONDUIT		
JB	JUNCTION BOX		
KV	KILOVOLT		
KVA	KILOVOLT AMPERES		
KW	KILOWATT		
L	LENGTH, LONG		
LTG	LIGHTING		

CODE AUTHORITY:

- ELECTRICAL: 2011 NATIONAL ELECTRICAL CODE
- 2014 FLORIDA BUILDING CODE

DEMOLITION NOTES:

1. THE CONTRACTOR SHALL VISIT AND CAREFULLY EXAMINE THOSE PORTIONS OF THE BUILDING AND SITE AFFECTED BY THIS WORK BEFORE SUBMITTING PROPOSAL, SO AS TO BECOME FAMILIAR WITH EXISTING WORK. SUBMISSION OF A PROPOSAL WILL BE CONSIDERED AS EVIDENCE THAT SUCH EXAMINATION HAS BEEN MADE AND LATER CLAIMS FOR LABOR, EQUIPMENT OR MATERIALS REQUIRED BECAUSE OF DIFFICULTIES ENCOUNTERED WILL NOT BE RECOGNIZED. IT IS TO BE UNDERSTOOD THAT UNFORESEEN CONDITIONS EXIST AND NEW WORK MAY NOT BE FIELD LOCATED EXACTLY AS SHOWN ON THE DRAWINGS. COORDINATION WITH OTHER TRADES IN EQUIPMENT ROUTING AS DETERMINED DURING CONSTRUCTION AND AS DIRECTED BY THE ARCHITECT/ENGINEER MAY BE NECESSARY AND ALL REQUIRED COORDINATION BETWEEN TRADES SHALL BE CONSIDERED AS PART OF THIS CONTRACT. IT IS ALSO UNDERSTOOD THAT THE PLANS ARE NOT COMPLETELY TO SCALE. FIELD VERIFY DIMENSIONS OF ALL EXISTING CONDITIONS, PRIOR TO BID AND INCLUDE ANY DEVIATIONS IN THE CONTRACT.
2. ALL DEVICES AND EQUIPMENT NOT SHOWN AND IN AREAS OUTSIDE OF THE SCOPE OF WORK SHALL REMAIN ACTIVE UNLESS OTHERWISE NOTED. INSTALL TEMPORARY SERVICES AS REQUIRED TO MAINTAIN CONTINUITY TO EXISTING DEVICES AND EQUIPMENT THAT REMAIN.
3. ALL EQUIPMENT AND MATERIAL REMOVED AND NOT REUSED SHALL BE TURNED OVER TO THE OWNER OR AT THE OWNERS REQUEST DISPOSED OF BY THE CONTRACTOR.
4. ALL ELECTRICAL DEVICES THAT ARE REMOVED SHALL BE REMOVED AS DIRECTED BY THE OWNER, AND CEILING OR WALL SHALL BE PATCHED OR PAINTED AS DIRECTED BY ARCHITECT.
5. ALL EXISTING ELECTRICAL EQUIPMENT IS NOT SHOWN. IT IS THE CONTRACTORS RESPONSIBILITY TO BECOME FAMILIAR WITH ALL EXISTING CONDITIONS PRIOR TO BID, AND INCLUDE IN HIS BID THE REMOVAL OF ALL EQUIPMENT, CONDUIT, WIRE, ETC. THAT IS NOT BEING REUSED BACK TO ITS SOURCE.
6. ALL CONCRETE, WALL PATCHING, CEILING REPAIR, AND OTHER GENERAL WORK REQUIRED FOR INSTALLING THE ELECTRICAL SYSTEMS AND TO REPAIR TO "LIKE NEW CONDITION" TO BE PROVIDED AND INSTALLED BY ELECTRICAL CONTRACTOR. (COORDINATE WITH GENERAL CONTRACTOR).
7. PROVIDE AND INSTALL ANY ADDITIONAL HANGERS/SUPPORTS REQUIRED TO ACCOMMODATE ANY EQUIPMENT RELOCATION.
8. COORDINATE ALL CEILING MOUNTED DEVICES WITH ARCHITECTURAL REFLECTED CEILING AND WORK OF ALL OTHER TRADES.
9. REUSE EXISTING RACEWAY AND OUTLETS WITHIN EXISTING WALL PARTITIONS WHERE POSSIBLE. WHERE EXISTING RACEWAY CANNOT BE REUSED, PROPOSE AS PART OF THE BID A MEANS EQUIVALENT TO THE DESIGN INTENT. FINAL APPROVAL TO BE MADE BY THE ARCHITECT, ENGINEER, OR OWNERS REPRESENTATIVE PRIOR TO INSTALLATION.

GENERAL NOTES:

1. ALL ELECTRICAL WORK SHALL CONFORM TO ALL STATE, LOCAL, AND NATIONAL ELECTRICAL CODES. SEE CODE AUTHORITY SECTION OF THIS SHEET FOR FURTHER DETAIL.
2. ALL EQUIPMENT ELECTRICAL CHARACTERISTICS SHALL BE VERIFIED WITH EQUIPMENT MANUFACTURER.
3. ITEMS OF SPECIFIC MANUFACTURERS SHALL BE INSTALLED IN STRICT ACCORDANCE WITH MANUFACTURER'S PRINTED INSTRUCTIONS AND/OR MANUFACTURER'S REPRESENTATIVE'S DIRECTIONS.
4. COORDINATE THE INSTALLATION OF ALL EQUIPMENT WITH OTHER CONTRACTORS.
5. ALL AREAS DISTURBED BY WORK SHALL BE RESTORED TO A CONDITION EQUAL TO ORIGINAL OR AS DETERMINED BY THE OWNER.
6. THE CONTRACTOR SHALL PROVIDE RACEWAYS, WIRING, AND CONNECTIONS FOR ALL CONTROL, CIRCUITS AND INTERLOCK.
7. ALL ELECTRICAL CONDUIT AND CONDUCTORS DISCONNECTED AND NOT TO BE REUSED SHALL BE REMOVED.
8. CONTRACTOR SHALL FIELD VERIFY ALL EXISTING CONDITIONS BEFORE STARTING WORK. IF ONLY A PORTION OF AN EXISTING CIRCUIT IS BEING REMOVED FOR DEMOLITION, CONTINUITY SHALL BE MAINTAINED TO THE REST OF THE REMAINING CIRCUIT.
9. ALL BRANCH CIRCUITS SHALL CONSIST OF 2 #12 AWG CONDUCTORS PLUS 1 #12 AWG GROUND, UNLESS OTHERWISE SHOWN.
10. ALL RACEWAYS SHALL BE RUN IN NEAT AND WORKMANLIKE MANNER AND SHALL BE PROPERLY SUPPORTED IN ACCORDANCE WITH CODES LISTED ON THIS SHEET. NO PVC SHALL BE ALLOWED ANYWHERE EXCEPT UNDERGROUND OR IN SLAB. PVC CONDUIT SHALL BE USED UNDERGROUND, RIGID STEEL ELBOWS SHALL BE USED ON ALL CONDUIT SIZES AT LOCATIONS PENETRATING CONCRETE FLOOR SLAB OR NOTED ELSEWHERE ON CONSTRUCTION DOCUMENTS. MINIMUM DEPTH OF UNDERGROUND CONDUIT IS 24" TO TOP OF CONDUIT.
11. ALL RACEWAY RUNS, PRIOR TO TERMINATION AT BRANCH PANEL, SHALL BE CAPPED DURING THE COURSE OF CONSTRUCTION BUT NOT UNTIL WIRES ARE PULLED IN AND COVERS ARE IN PLACE. NO CONDUCTORS SHALL BE PULLED INTO RACEWAYS UNTIL CONSTRUCTION WORK, WHICH MIGHT DAMAGE THE RACEWAYS, HAS BEEN COMPLETED.
12. CONTRACTOR TO PROVIDE NYLON PULL CORD IN ALL EMPTY RACEWAYS.
13. ALL CUTTING AND PATCHING AS A RESULT OF NEW CONSTRUCTION OR DEMOLITION SHALL BE PERFORMED IN A WORKMANLIKE MANNER, AND SHALL BE AS DIRECTED BY THE ARCHITECT.
14. THE ELECTRICAL DRAWINGS ARE SCHEMATIC ONLY. COORDINATE EXACT LOCATIONS AND DETAILS OF ELECTRICAL EQUIPMENT, CONDUITS, ETC. WITH THE OWNER.
15. CONSTRUCTION DOCUMENTS REPRESENT DESIGN INTENT. IT IS NOT THE INTENT OF THE DRAWINGS AND SPECIFICATIONS TO IDENTIFY EACH AND EVERY DETAIL OF THE ELECTRICAL CONSTRUCTION. PROVIDE ALL NECESSARY EQUIPMENT AND LABOR FOR A COMPLETE AND FULLY FUNCTIONAL ELECTRICAL SYSTEM.
16. CONTRACTOR SHALL FIELD VERIFY ALL EXISTING CONDITIONS, LOCATIONS, AND DIMENSIONS SHOWN ON DRAWINGS AND SHALL NOTIFY THE ENGINEER/ARCHITECT OF ANY DISCREPANCIES PRIOR TO THE START OF WORK.
17. THE ENGINEER HAS MADE EVERY EFFORT TO PROPERLY ADDRESS ALL RELATED TRADES AND IT IS THE RESPONSIBILITY OF EACH INDIVIDUAL CONTRACTOR (AS PART OF THEIR BASE BID) TO THOROUGHLY REVIEW ALL DESIGN DOCUMENTS BEFORE WORK IS TO BEGIN. IN CASE OF A CONFLICT, NOTIFY THE ARCHITECT/ENGINEER IMMEDIATELY TO COORDINATE ANY DISCREPANCY.
18. ALL ELEVATIONS NOTED ON THE CONTRACT DRAWING ARE RELATIVE TO THE FINISHED FLOOR UNLESS NOTED OTHERWISE.
19. REPAIR AND REFRESH ALL AREAS AFFECTED BY RENOVATION WORK BACK TO THEIR ORIGINAL CONDITION AS NEW AND IN AN ACCEPTABLE MANNER TO OWNER / ARCHITECT, WITH NO ADDITIONAL COST TO OWNER.
20. IF ASBESTOS IS ENCOUNTERED STOP WORK IN THAT AREA AND IMMEDIATELY CONTACT THE OWNER.
21. ALL PROJECT SUBMITTALS SHALL BE SUBMITTED AND RETURNED MARKED REVIEWED OR REVIEWED AS NOTED PRIOR TO ORDERING/ INSTALLATION OF ANY PRODUCT / SERVICE.
22. ALL MATERIALS AND ASSEMBLIES SHALL BE NEW AND FREE OF DEFECTS, UNLESS OTHERWISE NOTED AND SHALL BEAR THE UNDERWRITER'S LABORATORIES (UL) LABEL OR BE LABELED OR LISTED WITH AN APPROVED NATIONALLY RECOGNIZED ELECTRICAL TESTING AGENCY.
23. CONTRACTOR SHALL ASSUME THAT ALL ELECTRICAL EQUIPMENT, RACEWAYS, CONDUCTORS, ETC. SHOWN ON THE DRAWINGS SHALL BE FURNISHED AND INSTALLED BY THE CONTRACTOR UNLESS SPECIFICALLY NOTED AS EXISTING.
24. CONTRACTOR SHALL REVIEW AND COORDINATE THE ELECTRICAL CONSTRUCTION WITH OTHER TRADES, EQUIPMENT SUPPLIERS AND THE OWNER.
25. ALL WIRE SHALL BE STRANDED COPPER CONDUCTORS, 600V RATED, TYPE THHN/THWN, UNLESS OTHERWISE NOTED. ALL INTERIOR CONDUITS SHALL BE ELECTRICAL METALLIC TUBING (EMT), RIGID METAL CONDUIT (RMC) OR FLEXIBLE METAL CONDUIT (FMT), UNLESS OTHERWISE NOTED.
26. CONTRACTOR SHALL PERMANENTLY IDENTIFY ALL WIRING WITH THE SOURCE AND CIRCUIT AT ALL ELECTRICAL EQUIPMENT, PULL AND JUNCTION BOXES AND ELECTRICAL TERMINATIONS PROVIDED OR ASSOCIATED WITH THIS CONSTRUCTION.
27. WHERE CONDUITS PENETRATE FIRE RATED WALLS OR FLOORS, PROVIDE FIRE STOPPING THAT IS AN UNDERWRITER'S LABORATORIES LISTED SYSTEM AND CONFORMS TO THE FLORIDA BUILDING CODE.
28. CONTRACTOR SHALL PATCH AND REPAIR ALL DAMAGED SURFACES AND AREAS WHERE EQUIPMENT WAS REMOVED OR MODIFIED, TO MATCH EXISTING CONDITIONS.
29. ALL NEW CONDUITS TO BE CONCEALED IN WALL WHERE POSSIBLE. ALL CONDUITS IN CEILING TO BE PAINTED TO MATCH SURROUNDING MATERIAL.
30. ALL BRANCH CIRCUIT SHALL BE CONCEALED UNLESS OTHERWISE NOTED.

EXISTING CONDITIONS GENERAL NOTES:

1. VISIT AND CAREFULLY EXAMINE THOSE PORTIONS OF THE BUILDING AND SITE AFFECTED BY THIS WORK BEFORE SUBMITTING PROPOSALS, SO AS TO BECOME FAMILIAR WITH EXISTING CONDITIONS AND DIFFICULTIES THAT WILL AFFECT EXECUTION OF THE WORK. SUBMISSION OF A PROPOSAL WILL BE CONSIDERED AS EVIDENCE THAT SUCH EXAMINATION HAS BEEN MADE AND LATER CLAIMS FOR LABOR, EQUIPMENT OR MATERIALS REQUIRED BECAUSE OF DIFFICULTIES ENCOUNTERED WILL NOT BE RECOGNIZED.
2. UTILITIES AND SERVICES INDICATED ARE TAKEN FROM FIELD INVESTIGATION. IT IS TO BE UNDERSTOOD THAT UNFORESEEN CONDITIONS EXIST AND NEW WORK MAY NOT BE FIELD LOCATED EXACTLY AS SHOWN ON THE DRAWINGS. COOPERATION WITH OTHER TRADES IN ROUTING AND/OR BURIAL DEPTHS, AS DETERMINED DURING CONSTRUCTION AND AS DIRECTED BY THE ARCHITECT/ENGINEER, MAY BE NECESSARY. IT IS ALSO UNDERSTOOD THAT THE PLANS ARE NOT COMPLETELY TO SCALE. THIS CONTRACTOR IS TO FIELD VERIFY DIMENSION OF ALL SITE UTILITIES, ETC. PRIOR TO BID.
3. ELECTRICAL CONTRACTOR SHALL TRACE LIGHTING AND POWER BRANCH CIRCUITS TO IDENTIFY CIRCUITS SERVING AREA WITHIN SCOPE OF WORK. PROVIDE UPDATED TYPEWRITTEN PANEL SCHEDULES AT COMPLETION OF WORK.
4. REMOVE EXISTING POWER, LIGHTING, SYSTEMS, MATERIAL, AND EQUIPMENT WHICH ARE MADE OBSOLETE OR WHICH INTERFERE WITH THE CONSTRUCTION OF THE PROJECT.
5. REINSTALL ANY SUCH POWER, LIGHTING, SYSTEMS, MATERIALS AND EQUIPMENT WHICH ARE REQUIRED TO REMAIN ACTIVE FOR THE FACILITY TO BE FULLY FUNCTIONAL.
6. EXISTING OUTLET BOXES AND CONDUIT WHICH ARE LOCATED PROPERLY FOR NEW WORK MAY BE REUSED FOR NEW DEVICES AND WIRE.
7. ALL CONDUIT AND WIRE REMOVED SHALL BE TAKEN BACK TO THE SOURCE OF SUPPLY UNLESS OTHERWISE NOTED.
8. INSTALL A BLANK COVER PLATE WHERE REQUIRED.
9. ALL UNUSED RACEWAYS WITHIN ACCESSIBLE SPACES SHALL BE COMPLETELY REMOVED. REMOVE ALSO ASSOCIATED CONDUCTORS, JUNCTION BOXES, FASTENERS AND SUPPORTS.

ELECTRICAL SPECIFICATIONS-DIVISION 26:

SECTION 26000 - GENERAL PROVISIONS

- A. PROVIDE ALL LABOR, MATERIALS AND EQUIPMENT FOR A COMPLETE AND PROPERLY OPERATING ELECTRICAL SYSTEM. INCLUDE NECESSARY FEES AND PERMITS WITHIN BASE BID.
- B. CODES AND STANDARDS: ALL ELECTRICAL WORK SHALL BE IN STRICT COMPLIANCE WITH THE PROVISIONS OF THE LOCAL GOVERNMENT AUTHORITY, AND THE NATIONAL ELECTRIC CODE, 2011 EDITION. ALL MATERIALS SHALL BE NEW AND FREE FROM DEFECTS, AND SHALL BEAR THE UNDERWRITER'S LABORATORIES LABEL, OR BE LABELED OR LISTED WITH AN APPROVED NATIONALLY RECOGNIZED ELECTRICAL TESTING AGENCY.
- C. CONTRACTOR SHALL THOROUGHLY INVESTIGATE SITE BEFORE BIDDING. NO CHANGES WILL BE ALLOWED IN CONTRACT PRICE FOR WORK REQUIRED TO COMPLY WITH EXISTING CONDITIONS.
- D. ALL ELECTRICAL WORK SHALL BE DONE IN A NEAT AND WORKMANLIKE MANNER.
- E. CONTRACTOR SHALL SCHEDULE ALL DOWN-TIME WITH THE OWNER PRIOR TO BEGINNING THE WORK. PREMIUM/OVERTIME RATES MAY BE REQUIRED AND MUST BE INCLUDED IN BASE BID.
- F. CONTRACTOR SHALL THOROUGHLY REVIEW CONSTRUCTION DOCUMENTS. WHEN CONFLICTS ARISE WITHIN CONSTRUCTION DOCUMENTS, CONTRACTOR SHALL NOTIFY ENGINEER PRIOR TO SUBMITTING A BID. SUBMISSION OF A BID SHALL INDICATE THAT CONTRACTOR THOROUGHLY REVIEWED CONSTRUCTION DOCUMENTS. WHEN ENGINEER IS NOT AVAILABLE, OR TIME DOES NOT PERMIT, CONTRACTOR SHALL INCLUDE THE MOST STRINGENT (COSTLY) REQUIREMENTS WITHIN BASE BID.
- G. ELECTRICAL CONTRACTOR SHALL BE RESPONSIBLE FOR PROVIDING MANUFACTURERS, SUB-CONTRACTORS, VENDORS, AND SUPPLIERS WITH A COPY OF THESE SPECIFICATIONS.
- H. GUARANTEE ALL ELECTRICAL SYSTEM MATERIALS AND WORKMANSHIP TO BE FREE FROM DEFECTS FOR A PERIOD OF ONE (1) YEAR FROM THE DATE OF FINAL ACCEPTANCE AND PROPERLY CORRECT LATENT DEFECTS ARISING WITHIN THIS PERIOD UPON NOTIFICATION BY THE OWNER'S REPRESENTATIVE WITHOUT ADDITIONAL COMPENSATION.
- I. DAILY REMOVE REFUSE AND DEBRIS ACCUMULATING FROM ELECTRICAL CONSTRUCTION AND PRIOR TO ACCEPTANCE OF THIS WORK, LEAVE THE PREMISES "BROOM CLEAN" INsofar AS AFFECTED BY ELECTRICAL WORK.
- J. EQUIPMENT AND DESIGN OF SYSTEMS INDICATED ON THE DESIGN DRAWINGS AND WITHIN THESE SPECIFICATIONS SHALL BE CONSIDERED AS "SPECIFIED STANDARD" OF QUALITY. NO SUBSTITUTIONS SHALL BE MADE WITHOUT WRITTEN APPROVAL OF THE ENGINEER AT LEAST 10 DAYS PRIOR TO BID DATE.
- K. ANY DEVIATION FROM SPECIFIED EQUIPMENT THAT AFFECT THE INSTALLATION, OPERATION, PERFORMANCE, QUALITY OR LONGEVITY OF THE ELECTRICAL SYSTEMS AS DEFINED HEREIN, SHALL BE REPLACED BY THE ELECTRICAL CONTRACTOR WITH NO ADDITIONAL COST TO THE OWNER. IN ADDITION, ELECTRICAL CONTRACTOR SHALL PROVIDE THE ENGINEER WITH FLOOR PLANS SHOWING PHOTOMETRIC CALCULATIONS FOR ANY ELECTRICAL CONTRACTOR FURNISHED LIGHTING FIXTURE CHANGES FOR APPROVAL AT LEAST 10 DAYS PRIOR TO BID DATE.

SECTION 26050 - BASIC MATERIALS AND METHODS

- A. RACEWAYS AND FITTINGS: ALL RACEWAYS AND FITTINGS SHALL BE GALVANIZED RIGID STEEL OR INTERMEDIATE METAL CONDUIT WITH LOCKNUTS AND BUSHINGS. WITH THE EXCEPTION THAT WHERE SPECIFICALLY ALLOWED BY THE NATIONAL ELECTRICAL CODE AND APPLICABLE LOCAL CODES, ELECTRICAL METALLIC TUBING (E.M.T.) MAY BE USED FOR ALL INTERIOR EXPOSED AND CONCEALED WORK WHERE IT IS NOT SUBJECT TO PHYSICAL DAMAGE OR CORROSION. FITTINGS SHALL BE STEEL COMPRESSION TYPE. INSTALL EXPANSION FITTINGS IN RACEWAYS A MAXIMUM OF 200 FEET APART OR WHEREVER STRUCTURAL EXPANSION JOINTS ARE CROSSED.
- B. CONDUCTORS: FEEDER AND BRANCH CIRCUIT CONDUCTORS SHALL BE THWN COPPER (MINIMUM SIZE #12 UNLESS OTHERWISE NOTED). NO ALUMINUM SHALL BE PERMITTED UNLESS SPECIFICALLY NOTED OTHERWISE. INSTALL ALL WIRING IN CONDUIT OR APPROVED RACEWAYS UNLESS OTHERWISE INDICATED. PROVIDE #10AWG FOR BRANCH CIRCUITS OVER 100 FEET IN LENGTH TO ACCOUNT FOR VOLTAGE DROP. PROVIDE #10 AWG GROUND TO CORRESPOND. ALL BRANCH CIRCUITS SHALL CARRY A GROUNDING/EQUIP CONDUCTOR, AND BE WIRED WITH COLOR-CODED WIRE WITH THE SAME COLOR USED FOR A PHASE THROUGHOUT. COLOR-CODE SHALL BE AS FOLLOWS:
120/208 VOLT: PHASE A - BLACK; PHASE B - RED; PHASE C - BLUE; NEUTRAL - WHITE; GROUND - GREEN.
- C. FINAL CONNECTIONS TO MOTORS OR EQUIPMENT SUBJECT TO VIBRATION SHALL BE MADE UP WITH GREEN/TIGHT FLEXIBLE GALVANIZED STEEL CONDUIT IN WET OR DAMP LOCATIONS. LOCATE ALL DEVICES AND EQUIPMENT WHERE SHOWN ON DRAWINGS. ALL DIMENSIONS SHOWN ON THE DRAWINGS ARE FROM FINISHED FLOOR TO THE CENTER OF THE DEVICE UNLESS OTHERWISE INDICATED. STANDARD MOUNTING HEIGHTS ARE AS FOLLOWS:
DEVICES HEIGHT AFF AT DEVICE CENTER
1. ELECTRICAL OUTLETS 18"
2. ELECTRICAL OUTLETS ABOVE COUNTER 42"
3. COMMUNICATION OUTLETS 18"
4. LIGHT SWITCHES 42"
5. THERMOSTATS SEE MECHANICAL SPECIFICATIONS

- D. MATERIALS SHALL BE NEW AND UNUSED AND THE CATALOGUED PRODUCTS OF MANUFACTURERS REGULARLY ENGAGED IN THE PRODUCTION OF SUCH MATERIALS. THE MATERIALS SHALL BE OF THE MANUFACTURER'S LATEST STANDARD DESIGN THAT COMPLEX WITH THE SPECIFICATION REQUIREMENTS.
- E. LIGHTING FIXTURES SHALL BE AS SHOWN ON THE DRAWING AND SHALL BE FURNISHED WITH LAMPS INSTALLED.
- F. ALL GROUNDING SHALL CONFORM TO ARTICLE 250 OF THE NEC, THE DRAWINGS, AND THE LOCAL CODE ENFORCEMENT AUTHORITIES HAVING JURISDICTION.
- G. FIREPROOF ALL OPENINGS IN FIRE RATED WALLS BY AN UL APPROVED SYSTEM.
- H. PROVIDE FOR REVIEW AND APPROVAL FIVE (5) COPIES OF CUT SHEETS AND SCHEDULES FOR ALL ELECTRICAL EQUIPMENT FURNISHED BY THE ELECTRICAL CONTRACTOR IN A 3-RING BINDER WITH A FRONT PAGE FOR EACH CATEGORY WITH SPACE FOR ENGINEERS STAMP AND COMMENTS. LOOSE CUTSHEETS WILL BE REJECTED.
- I. CONDUIT PENETRATIONS THROUGH FIRE RATED PARTITIONS SHALL BE SEALED USING APPROVED FIRE STOPPING COMPOUND. REFER TO ARCHITECTURAL FLOOR PLAN FOR LOCATION OF FIRE RATED PARTITIONS.
- J. ELECTRICAL CONTRACTOR MAY COMBINE CIRCUITS IN A COMMON RACEWAY AS LONG AS CONDUCTORS ARE DERATED AS PER NEC TABLE 310-15. SHARED NEUTRAL SHALL NOT BE ALLOWED.
- K. ELECTRICAL CONTRACTOR SHALL INCLUDE CUTTING AND PATCHING FOR THE INSTALLATION OF HISHER WORK WITHIN BASE BID.
- L. CLEAN ALL LIGHT FIXTURES, LAMPS AND LENSES AND PANELBOARD INTERIORS PRIOR TO FINAL ACCEPTANCE.
- M. PROVIDE DSK FILE ON CAD 2009 RELEASE WITH "AS BUILT" ELECTRICAL DRAWINGS AT THE COMPLETION OF THE PROJECT.
- N. CONTRACTOR REPRESENTS THAT HIS BID IS BASED UPON THE MANUFACTURER'S MATERIALS AND EQUIPMENT DESCRIBED IN THE CONTRACT DOCUMENTS.

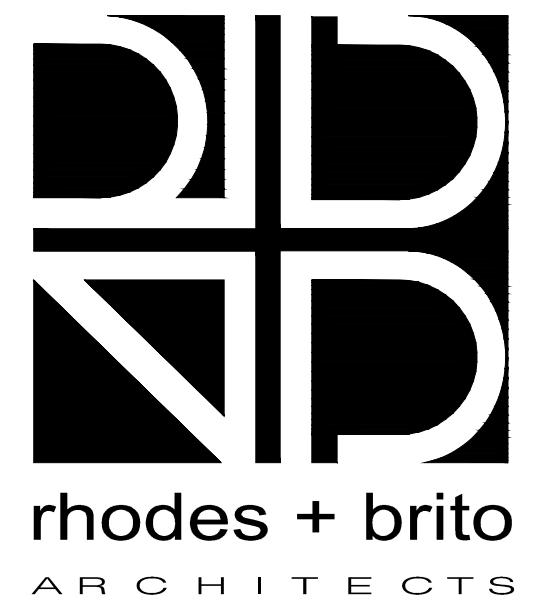

rhodes + brito
ARCHITECTS
AA0002809
605 E. ROBINSON STREET, SUITE 150
ORLANDO, FL 32801
PH (407) 648 - 7288
www.rhodesbrito.com

Consultants

NAME: ALVIN C. JAMES
REG #: 62471

BITHLO NEIGHBORHOOD FOR CHILDREN AND FAMILIES (NCF)

18566 MADISON AVENUE
ORLANDO, FL 32820

ALL REPRODUCTION AND INTELLECTUAL PROPERTY RIGHTS RESERVED ©

Seal 3/21/2016 4:59:23 PM

PERMIT DOCUMENTS

DATE	SUBMISSION / REVISION	NO.

Electrical Floor Plan - Bithlo Neighborhood Center Parking Lot

SCALE: os shown
DRAWN BY: TC
CHECK BY: AJ
DATE: MARCH 25, 2016
PROJECT NUMBER: 15012-0002

E100



CS Engineers, Inc.
600 E. Robinson Street, Suite 210
Orlando, Florida 32801
Phone: 407.422.1118
Fax: 407.641.5118
www.cs06.com
CSA No. 7602

