

CONSTRUCTION PLANS FOR: LITTLE EGYPT / RING ROAD GRAVITY SEWER IMPROVEMENT PROJECT

INDEX OF SHEETS

SHEET NO.	SHEET DESCRIPTION
G-1	COVER SHEET
G-2	GENERAL NOTES & VICINITY MAP
C-1	PLAN AND PROFILE
C-2 - C-3	CONSTRUCTION DETAILS
C-4	ASSET TABLES

BOARD OF COUNTY COMMISSIONERS

TERESA JACOBS
ORANGE COUNTY MAYOR

S. SCOTT BOYD
DISTRICT 1

JENNIFER THOMPSON
DISTRICT 4

BRYAN NELSON
DISTRICT 2

TED B. EDWARDS
DISTRICT 5

PETE CLARKE
DISTRICT 3

VICTORIA O.SIPLIN
DISTRICT 6

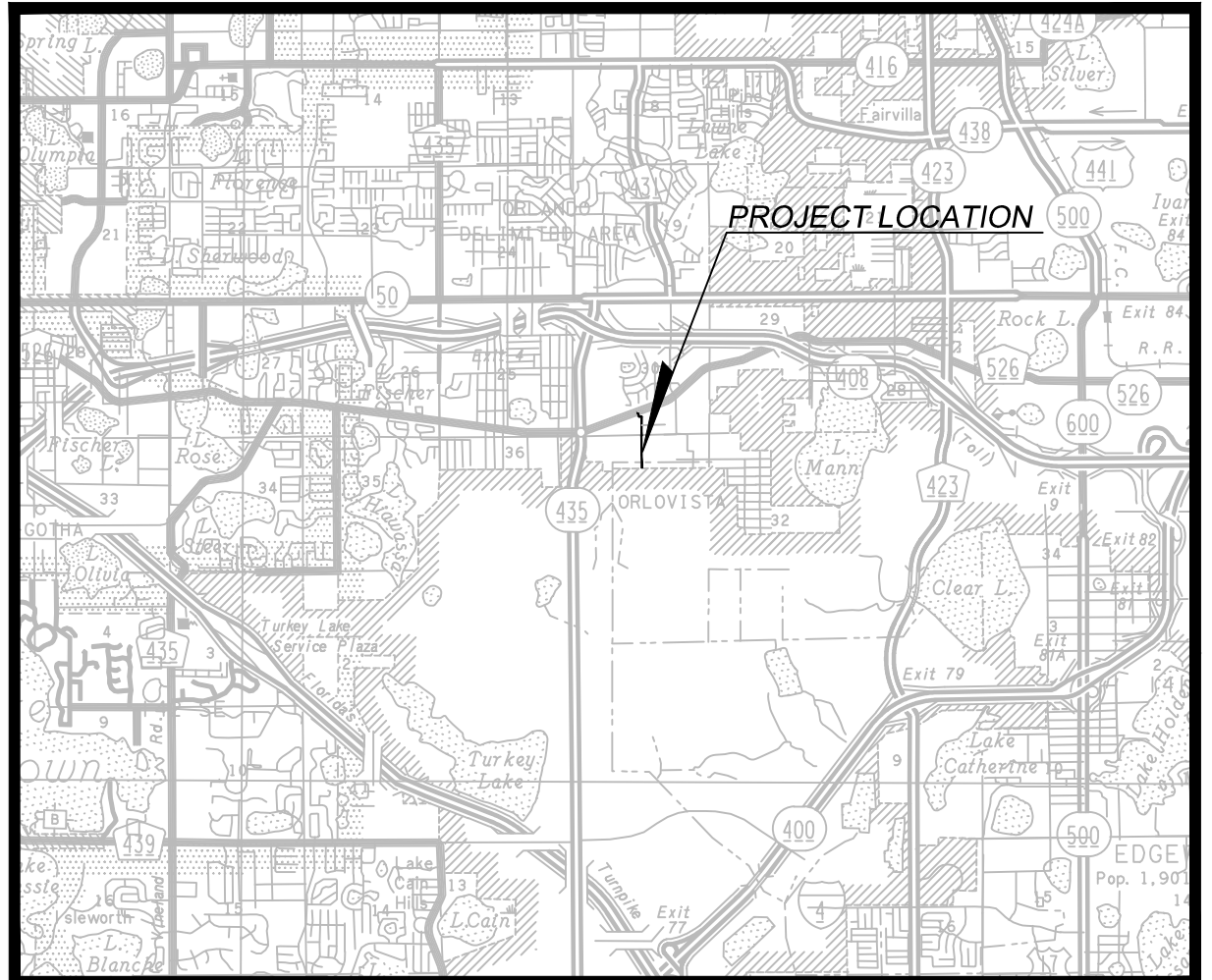

VICINITY MAP
N.T.S.

AJIT LALCHANDANI
COUNTY ADMINISTRATOR

RAYMOND E. HANSON, P.E.
DIRECTOR ORANGE COUNTY UTILITIES DEPARTMENT

PREPARED BY:
CPH, INC.
1117 East Robinson Street, Orlando, FL 32801
Phone: 407.425.0452 Fax: 407.648.1036
Certificate of Authorization No. 3215

ORANGE COUNTY UTILITIES DEPARTMENT
ENGINEERING DIVISION
ORANGE COUNTY, FLORIDA

COUNTY SEQUENCE NUMBER: 85506
ORANGE COUNTY CAPITAL NUMBER: 1505-10
BID SET

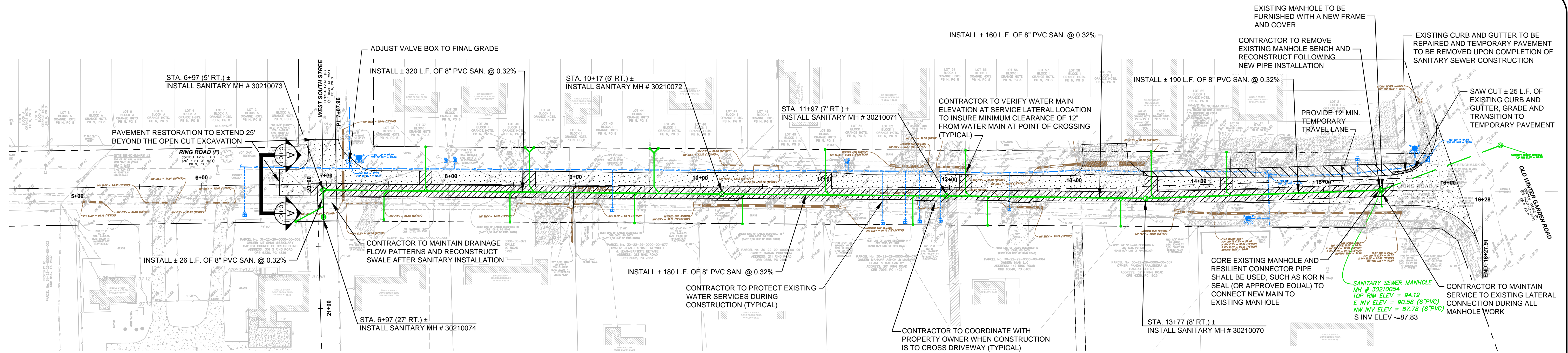

NOTES:

- ONE LANE OF TRAFFIC IS TO BE MAINTAINED AT ALL TIMES. THE CONTRACTOR IS TO REFERENCE FDOT STANDARD INDICES 602 AND 603 OR SIMILARLY APPLICABLE INDICES FOR THE MAINTENANCE OF THE TRAFFIC DURING CONSTRUCTION.
- NOT MORE THAN 300 LINEAL FEET OF OPEN TRENCH SHALL BE ALLOWED AT ANY TIME DURING CONSTRUCTION
- HIGH EARLY STRENGTH CONCRETE SHALL BE USED FOR PERPENDICULAR ROAD CROSSING, AND TEMPORARY PAVING AS SHOWN IN THE DETAIL ON SHEET C-3. SOIL CEMENT ROAD BASE IS TO BE USED UNDER ROADWAY ASPHALT INSTALLED OVER SEWER MAIN, AS SHOWN IN THE TYPICAL ROADWAY PAVEMENT SECTION DETAIL.
- THE CONTRACTOR IS TO COORDINATE WITH THE PROPERTY OWNERS REGARDING THE EXECUTION OF RIGHT OF ENTRY DOCUMENTATION. SEPTIC SYSTEM ABANDONMENT AND LATERAL INSTALLATION ON PRIVATE PROPERTY IS TO BE COORDINATED WITH INDIVIDUAL PROPERTY OWNERS THROUGH INDIVIDUALLY EXECUTED LICENSE AGREEMENTS.
- CONTRACTOR SHALL BE RESPONSIBLE TO LOCATE SEPTIC TANKS AND HOME CONNECTIONS PRIOR TO CONSTRUCTION OF THE SEWER MAIN. TYPICAL LATERAL INSTALLATION AND SEPTIC ABANDONMENT PROCEDURES ARE CONTAINED ON DETAIL SHEET C-3.
- CONTRACTOR SHALL LOCATE SERVICE LATERAL AT EACH MAIN TO CORRESPOND WITH HOUSE SERVICE LOCATIONS, IN ACCORDANCE WITH THE PROJECT SPECIFICATIONS.
- CONTRACTOR SHALL BE RESPONSIBLE FOR CONSTRUCTION OF NEW SERVICE LATERALS FROM CLEANOUT AT RIGHT OF WAY LINE TO THE HOUSE SERVICE LOCATION. THIS WORK SHALL BE PERFORMED BY FLORIDA LICENSED PLUMBERS.
- EXISTING SIDEWALKS ARE NOT TO BE DISTURBED. IF SIDEWALKS ARE DISTURBED, CONTRACTOR IS TO RESTORE SIDEWALKS TO CURRENT ADA AND ORANGE COUNTY STANDARDS.
- CONTRACTOR IS TO VERIFY THE EXISTING DRAINAGE DITCHES AND ROADWAY SLOPING ARE NOT CHANGED DURING CONSTRUCTION.
- CONTRACTOR IS TO LIMIT TIME ON PRIVATE PROPERTY TO A MAXIMUM OF 10 BUSINESS DAYS. IF CONTRACTOR IS TO EXCEED THIS LIMIT, WRITTEN NOTIFICATION/JUSTIFICATION IS TO BE PROVIDED TO THE OWNER AND ORANGE COUNTY FOR APPROVAL.

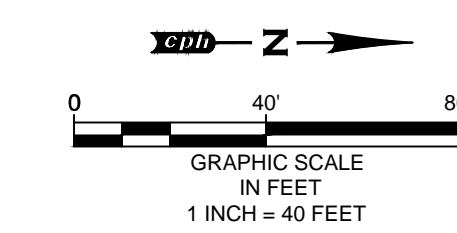

LEGEND

- OPEN CUT AND RESTORE ROADWAY (10' WIDE, TYPICAL)
- MILLING AND RESURFACING
- TEMPORARY PAVEMENT
- PROPOSED OCU GRAVITY MAIN
- PROPOSED OCU SANITARY MANHOLE
- PROPOSED SINGLE SERVICE LATERAL
- PROPOSED DOUBLE SERVICE LATERAL
- EXISTING OCU SANITARY MANHOLE AND PIPE
- RIGHT OF WAY LINE
- EXISTING STORM SEWER

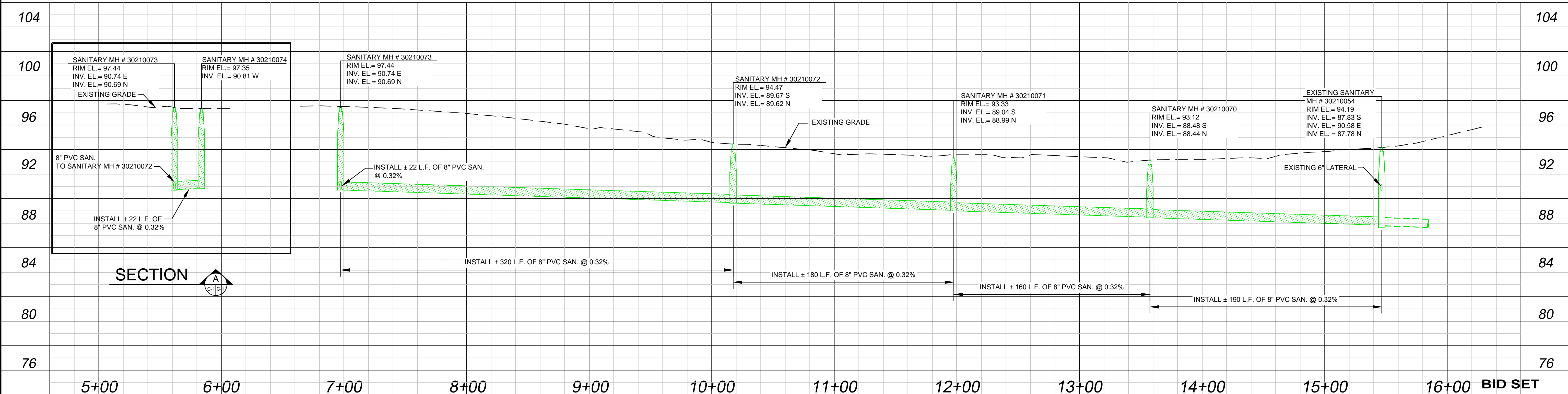

REV	DATE	DESCRIPTION

LINE IS 2 INCHES
AT FULL SIZE
(IF NOT SCALE ACCORDINGLY)

ORANGE COUNTY UTILITIES DEPARTMENT ENGINEERING DIVISION
9150 CURRY FORD ROAD ORLANDO, FL. 32825

cph
www.cphcorp.com
1117 East Robinson Street - Orlando, FL 32801 - Phone: 407.425.0452

A Full Service A & E Firm
Architects M/E/P
Engineers Planners
Environmental Surveyors
Landscape Architects Traffic/Transportation
Licenses:
Eng. C.O.A. No. 3215
Survey L.B. No. 7143
Arch. Lic. No. AA2600926
Landscape Lic. No. LC0000298

LITTLE EGYPT / RING ROAD GRAVITY SEWER IMPROVEMENT PROJECT

DAVID E. MAHLER
PROFESSIONAL ENGINEER
FLORIDA LICENSE #50041

OCU FILE NO.: ####
DESIGNED BY: PVH
DRAWN BY: GNP
CHECKED BY: DEM
CADD FILE: 028505 Plans

SCALE: AS SHOWN
DRAWING NO.:
C-1
SHEET: 3 OF 6

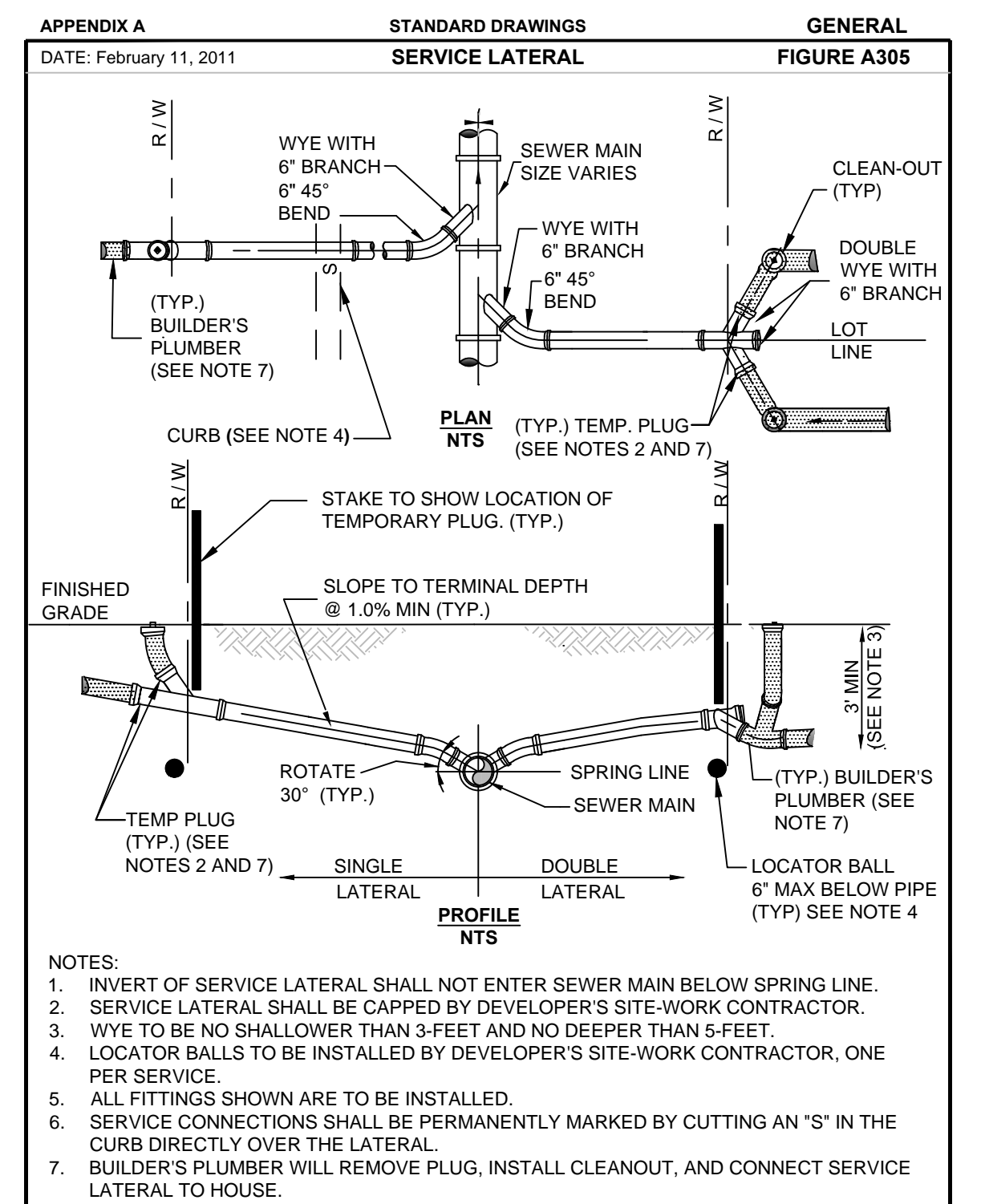
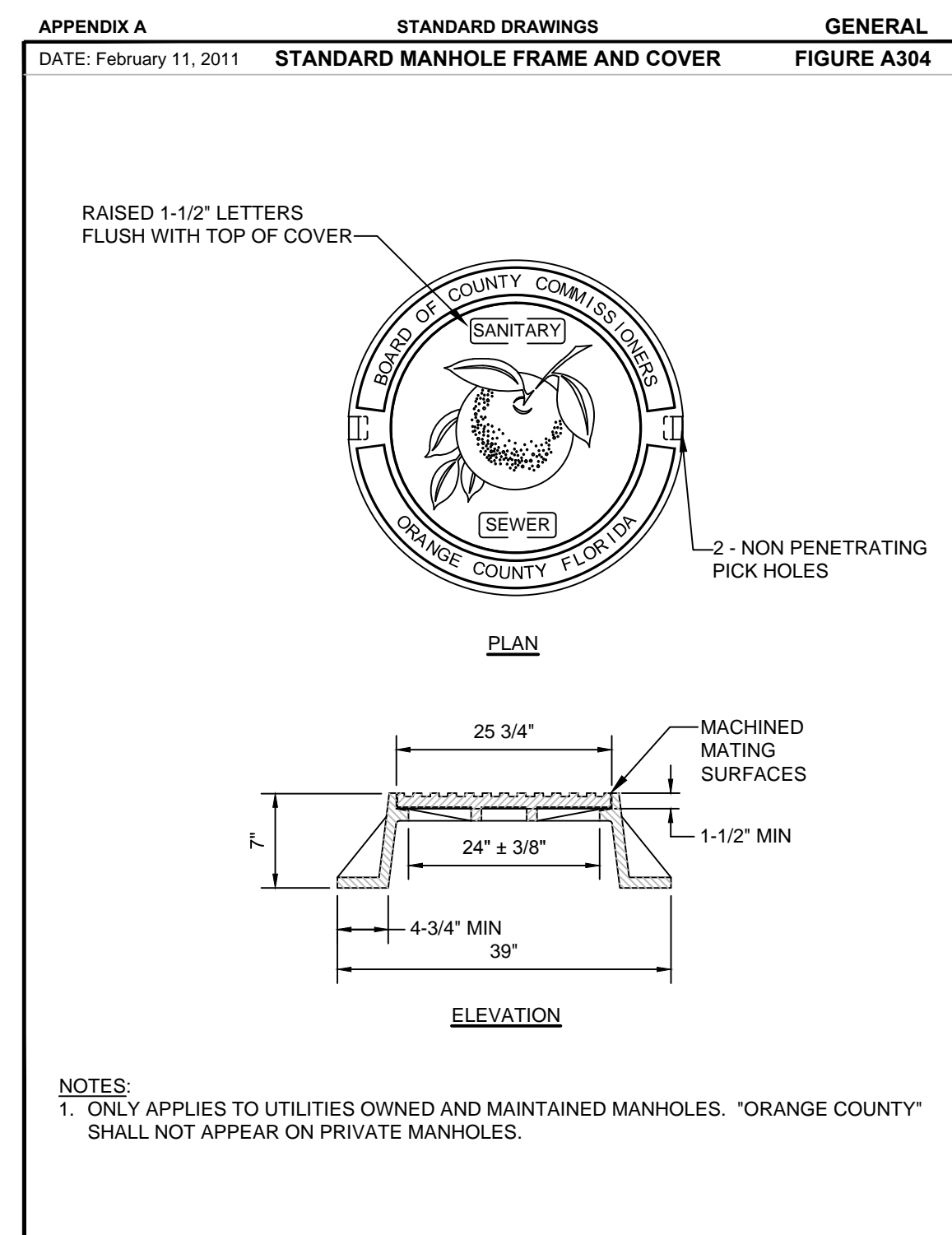
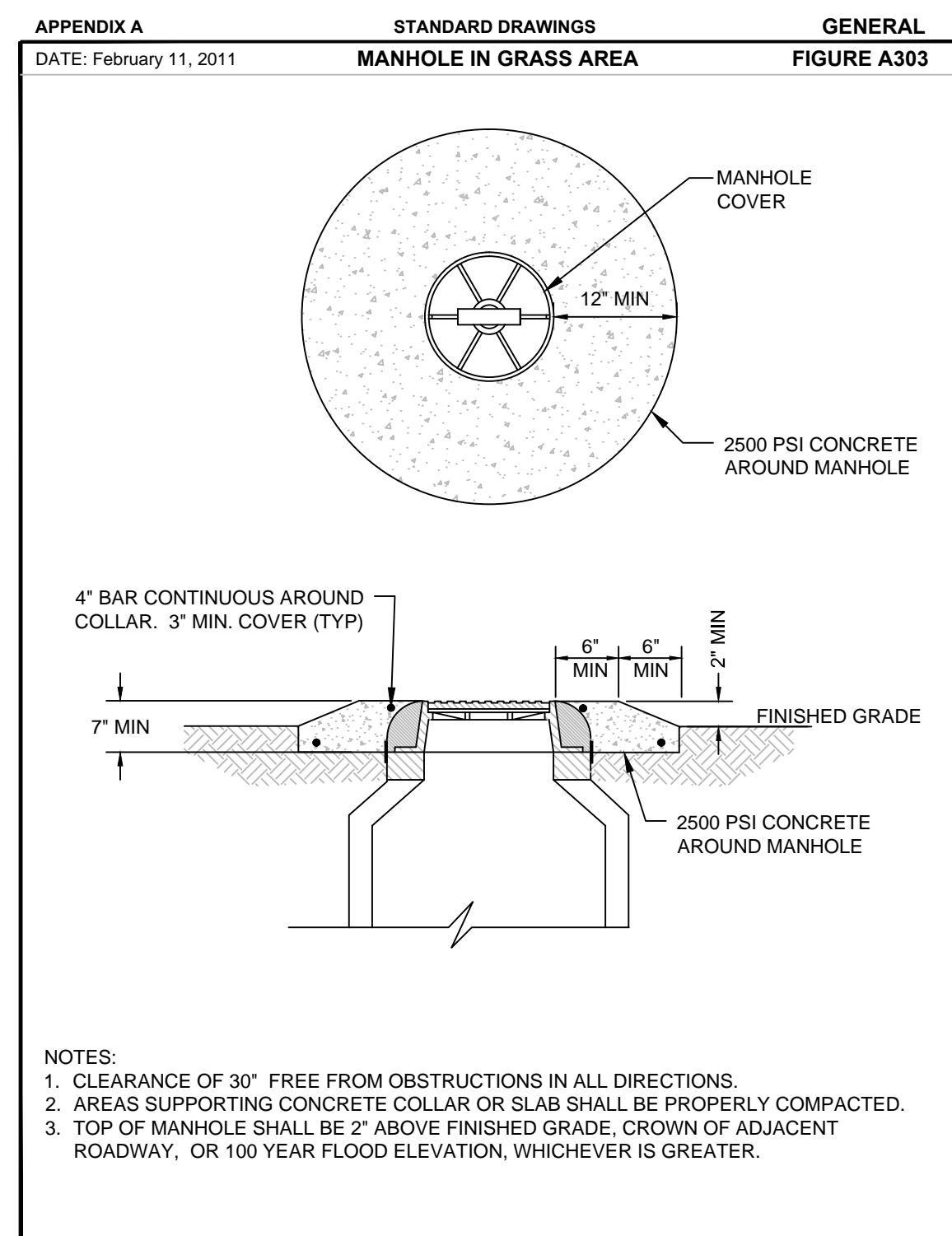
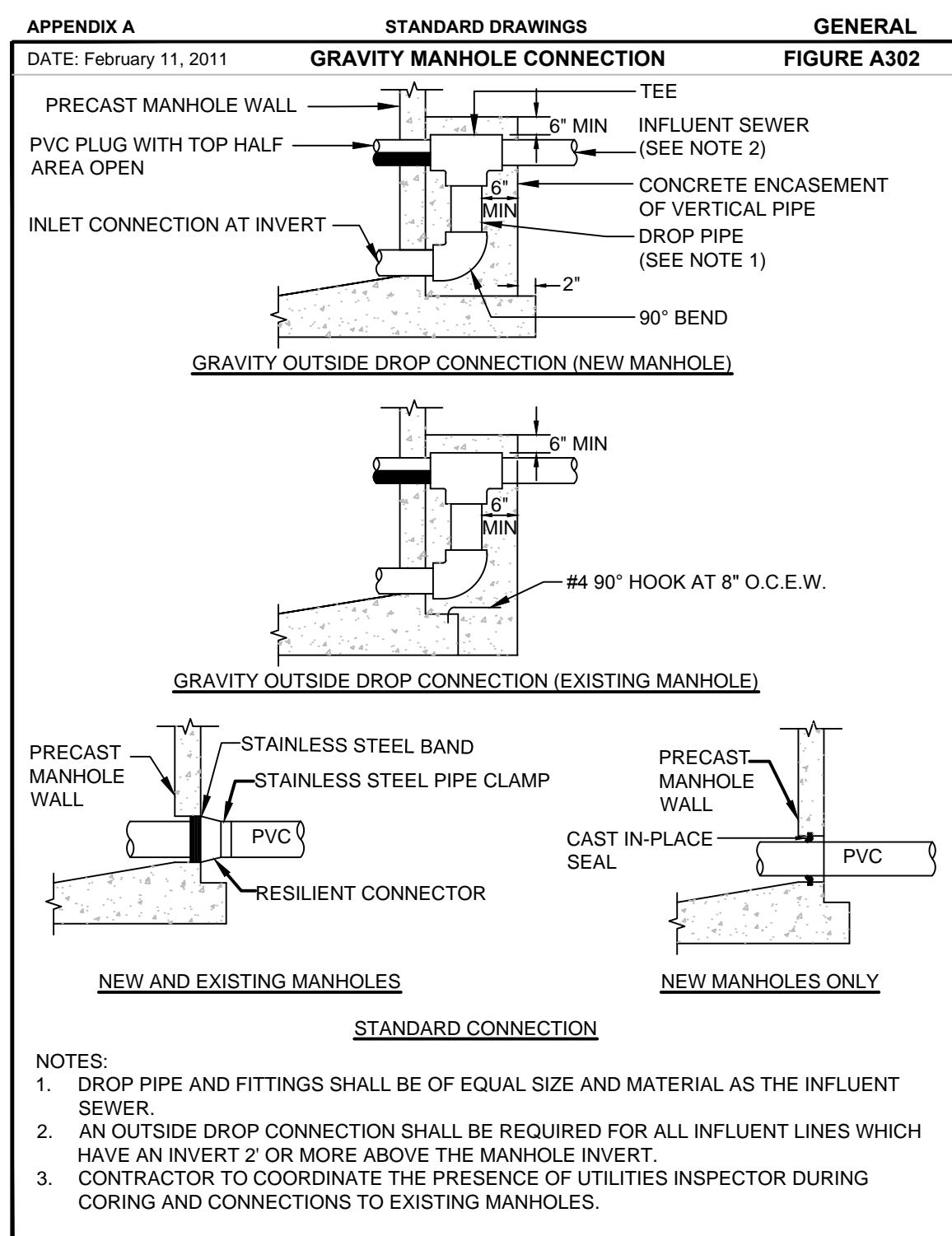
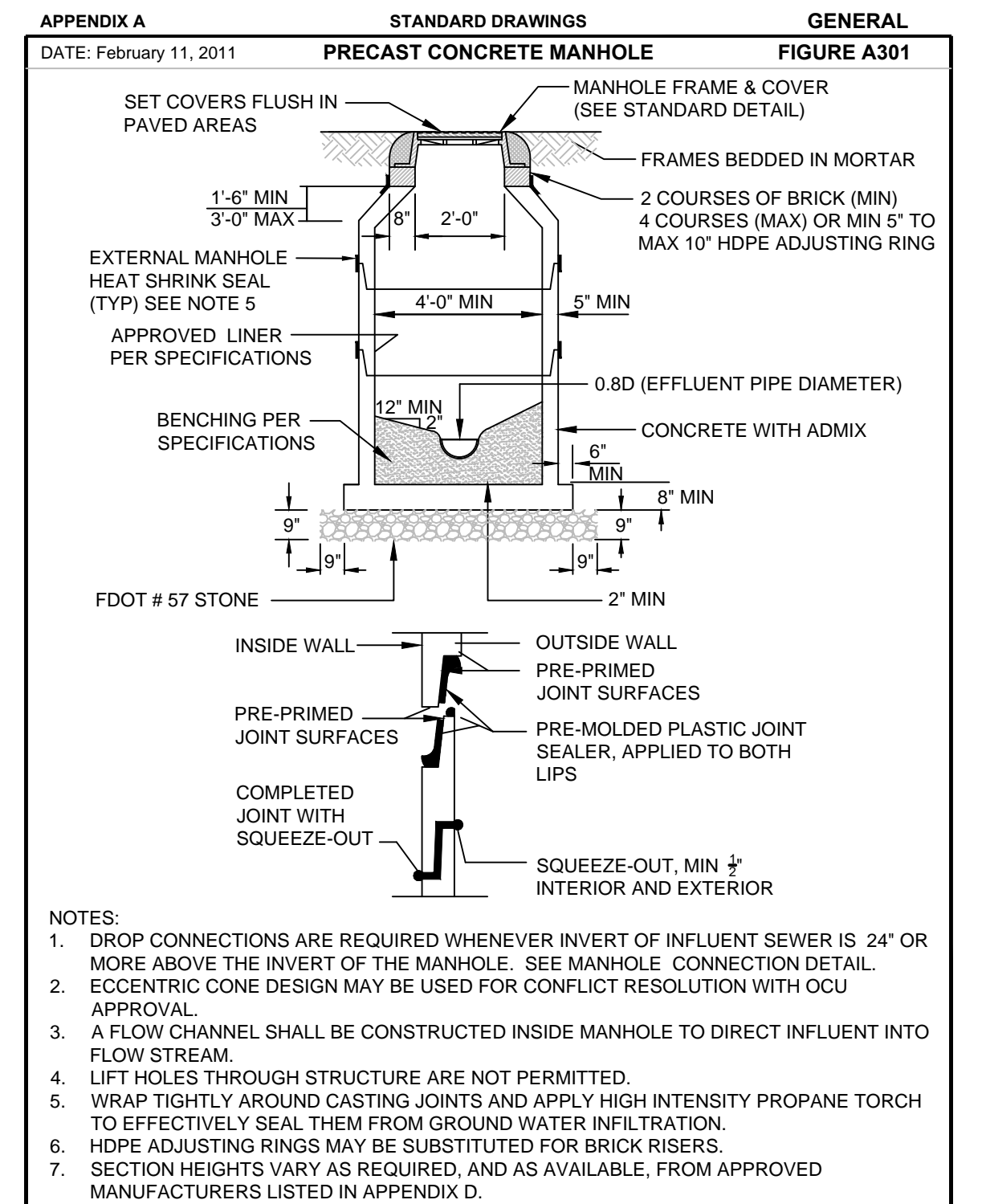
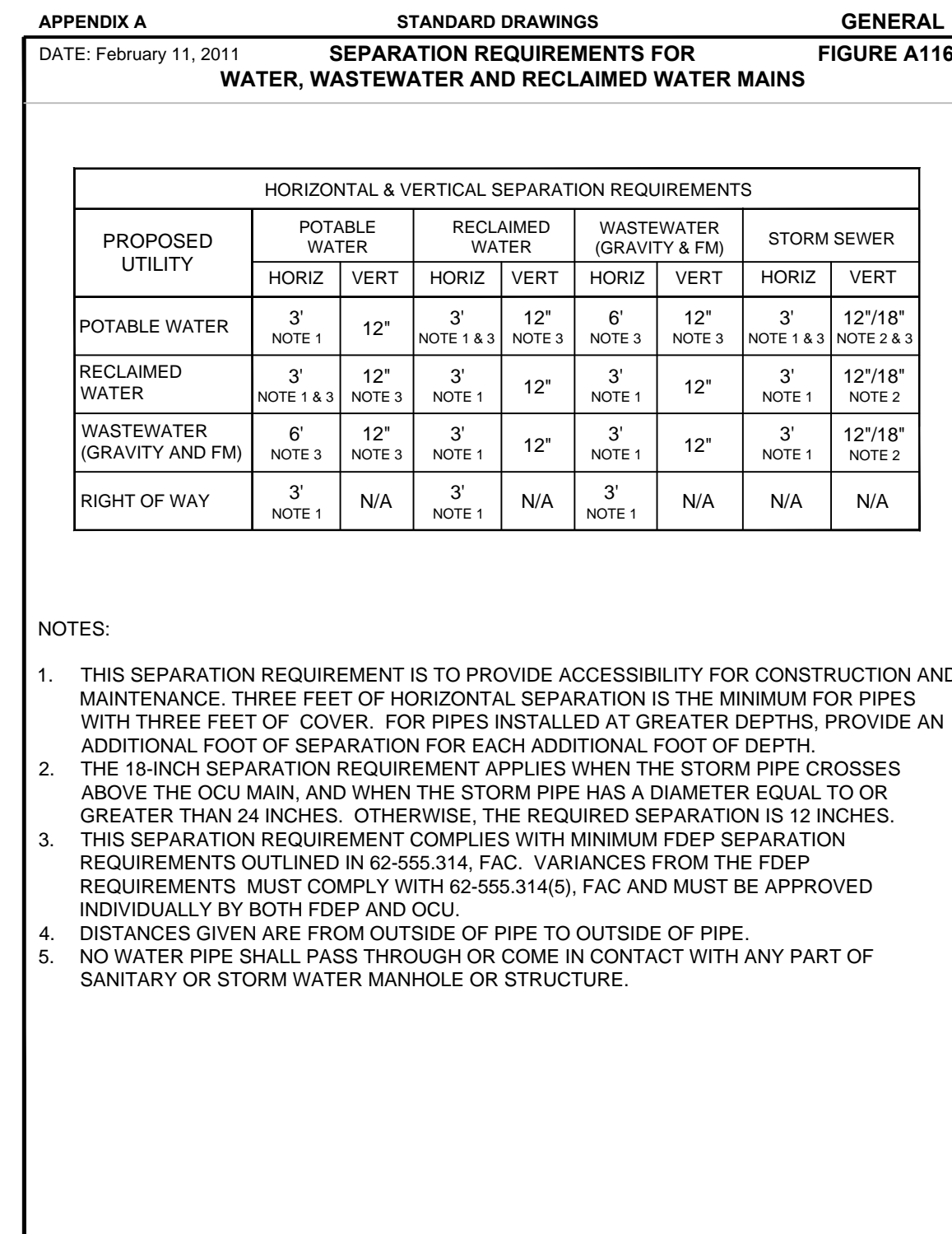
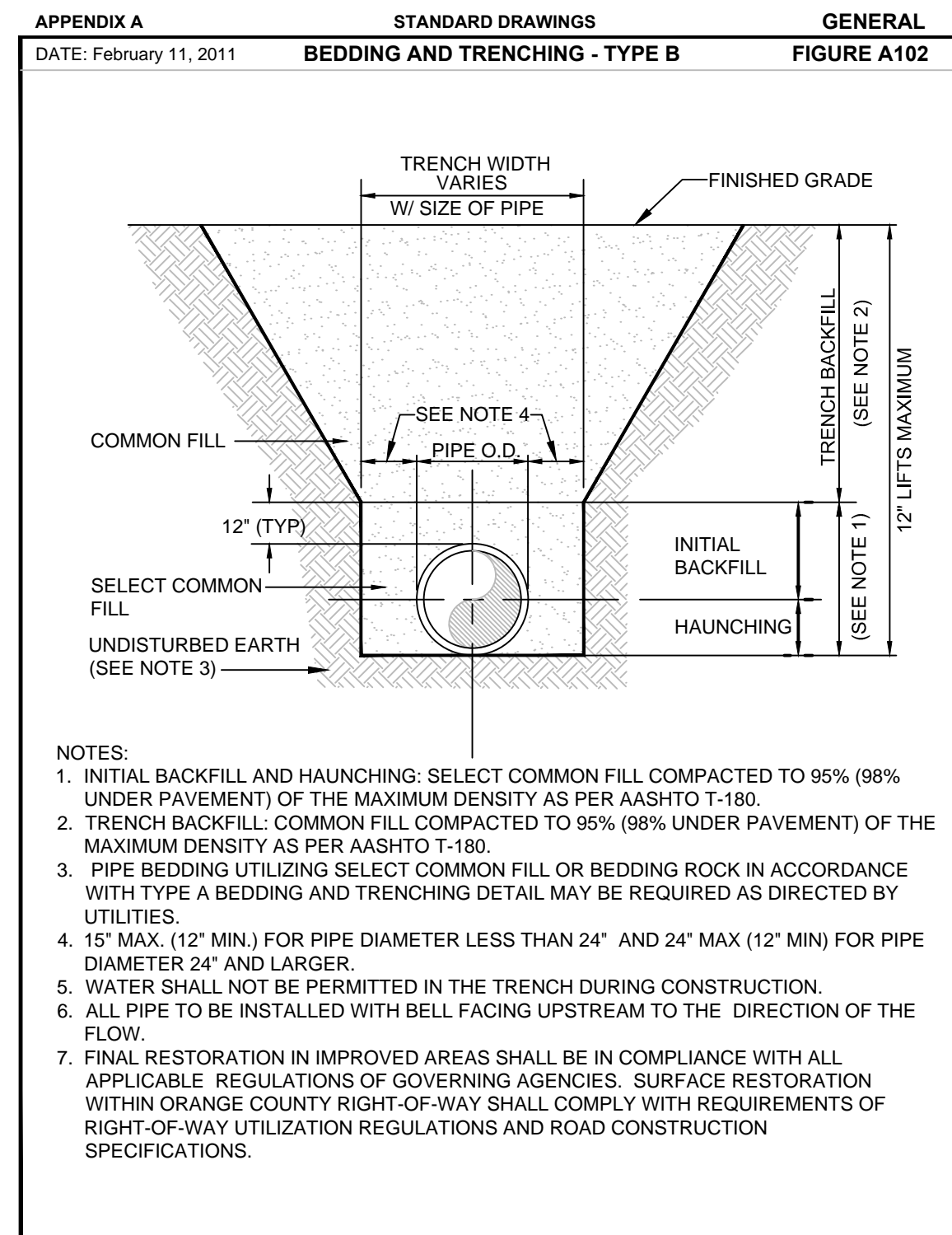
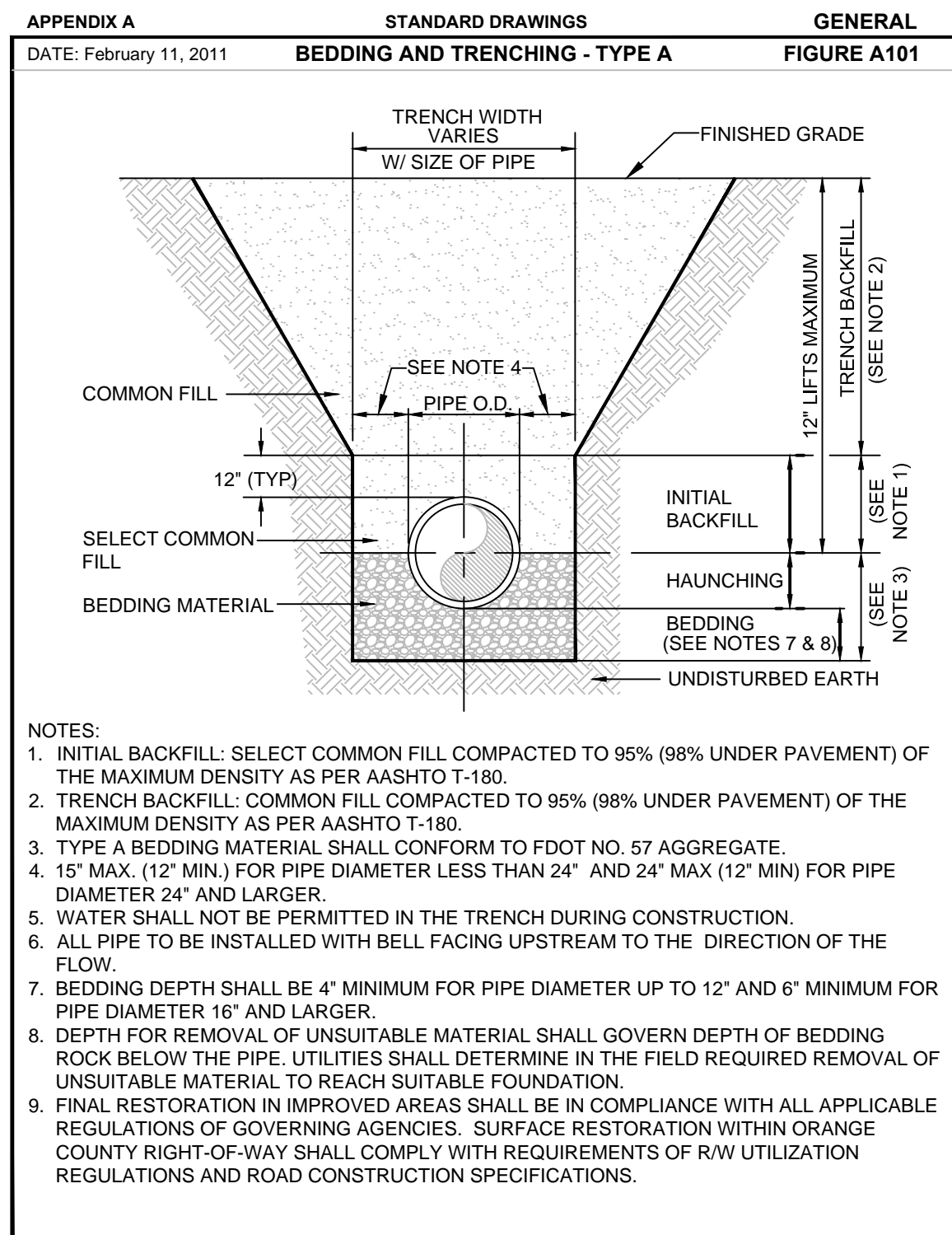

REV	DATE	DESCRIPTION

LINE IS 2 INCHES
AT FULL SIZE
(IF NOT SCALE ACCORDINGLY)

ORANGE COUNTY UTILITIES DEPARTMENT ENGINEERING DIVISION
9150 CURRY FORD ROAD ORLANDO, FL. 32825

cph A Full Service A & E Firm
Architects Engineers Environmental Landscape Architects Traffic/Transportation
M/E/P Planners Surveyors
www.cphcorp.com
1117 East Robinson Street - Orlando, FL 32801 - Phone: 407.425.0452

CONSTRUCTION DETAILS
LITTLE EGYPT / RING ROAD
SANITARY SEWER
IMPROVEMENT PROJECT

OCU FILE NO.:
DESIGNED BY: PVH
DRAWN BY: GNP
CHECKED BY: DEM
CADD FILE: 028505 Cover

BID SET
SCALE: N.T.S.
DRAWING NO.:
C-2
SHEET: 4 OF 6

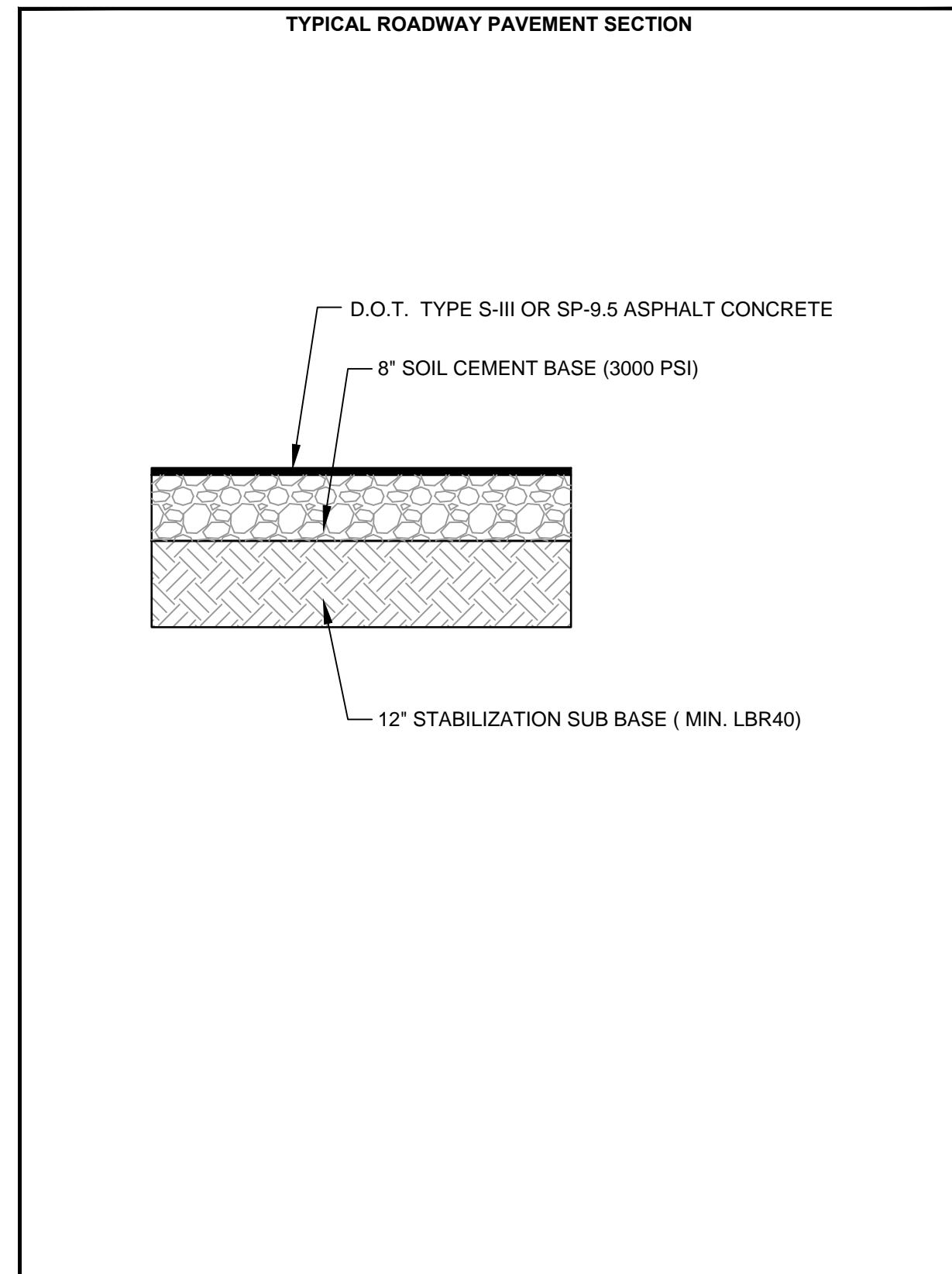
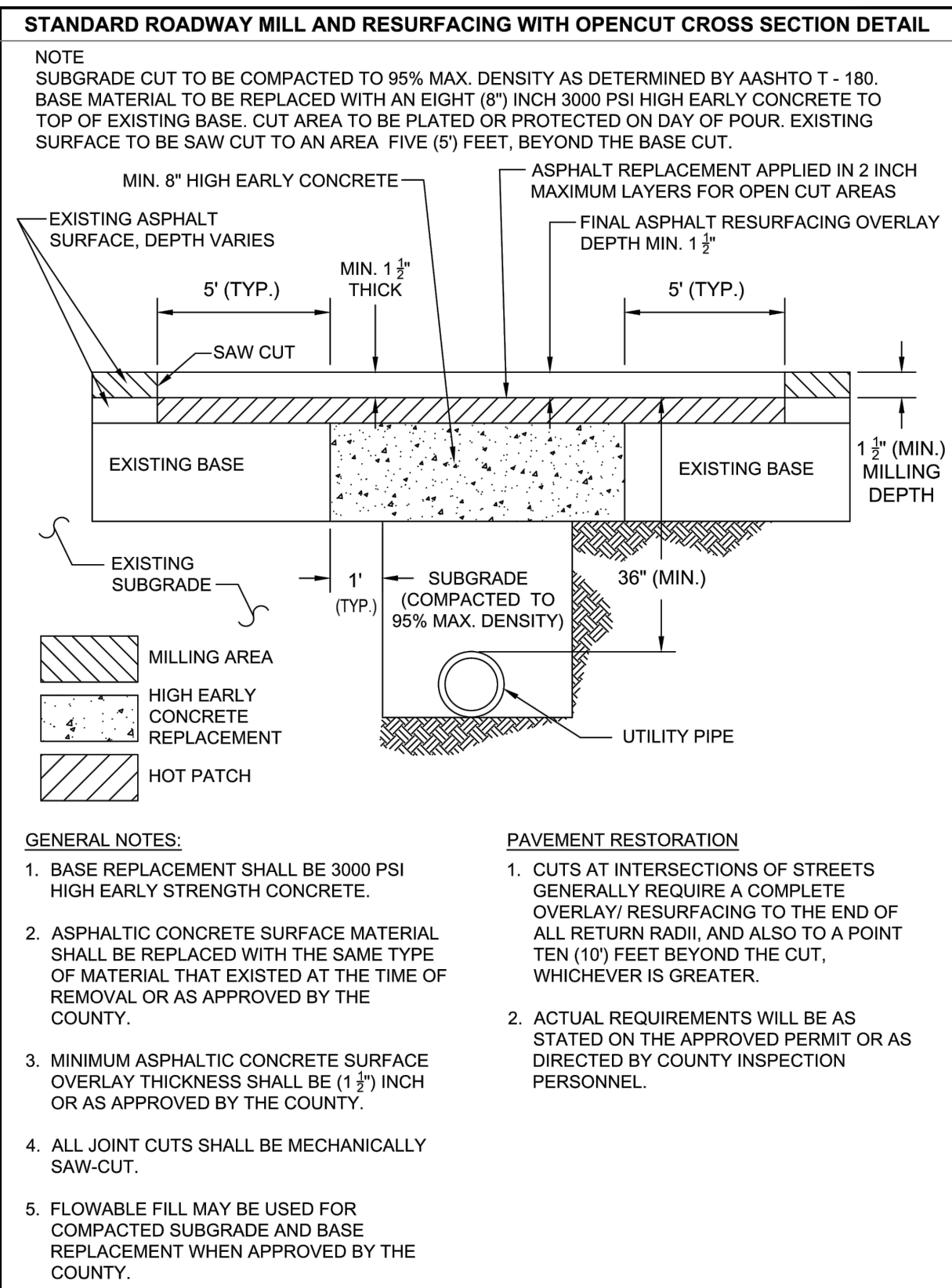

ORANGE COUNTY UTILITIES
STANDARDS AND CONSTRUCTION SPECIFICATIONS MANUAL

APPENDIX A STANDARD DRAWINGS GRAVITY R/R
DATE: August 2012 FLEXIBLE PIPE CONNECTION TO HDPE LINED MANHOLE FIGURE A609

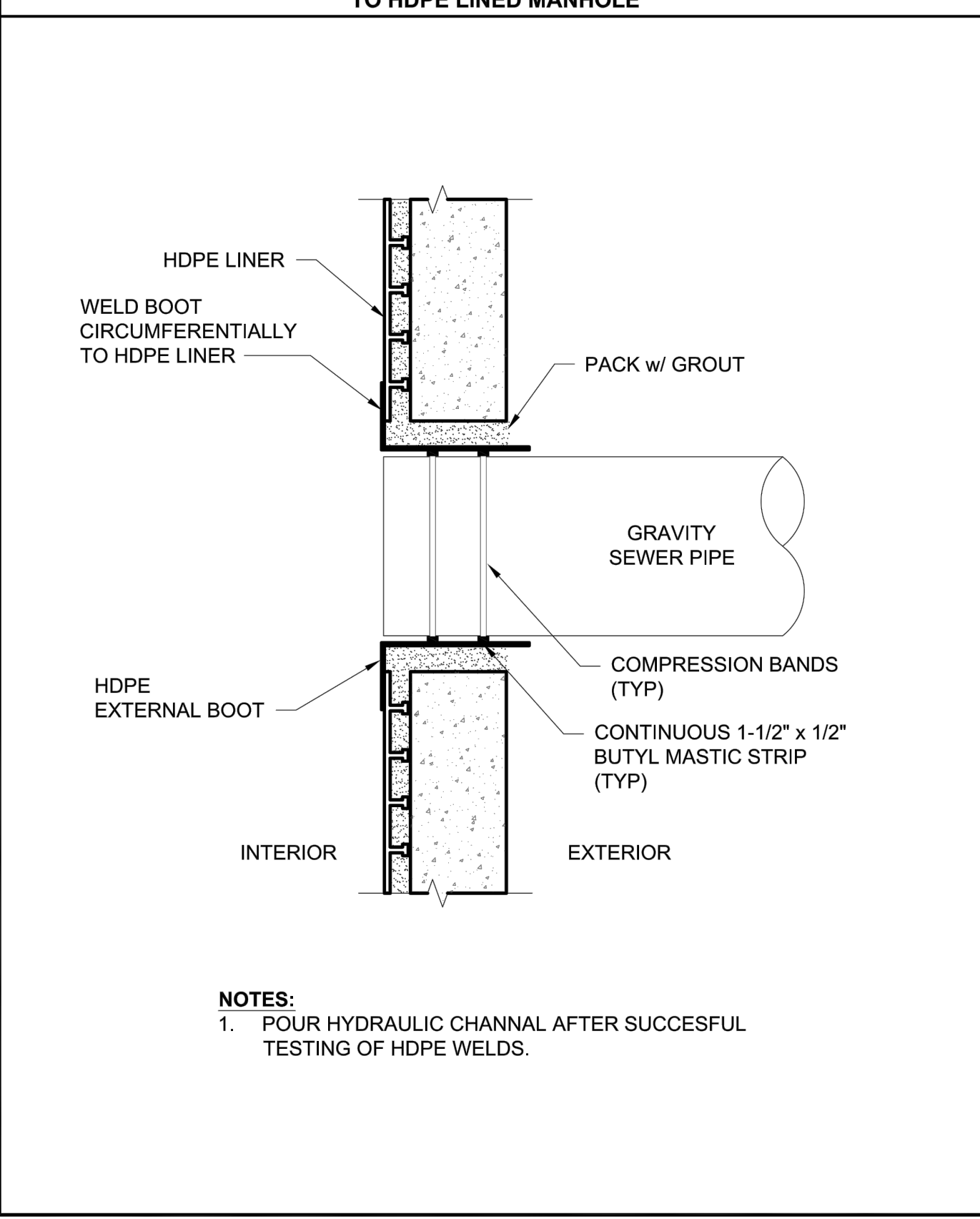

ORANGE COUNTY UTILITIES
STANDARDS AND CONSTRUCTION SPECIFICATIONS MANUAL

APPENDIX A STANDARD DRAWINGS GRAVITY R/R
DATE: ASPHALT PAVEMENT RESTORATION AT MANHOLE FRAME AND COVER REPLACEMENT FIGURE RR-10

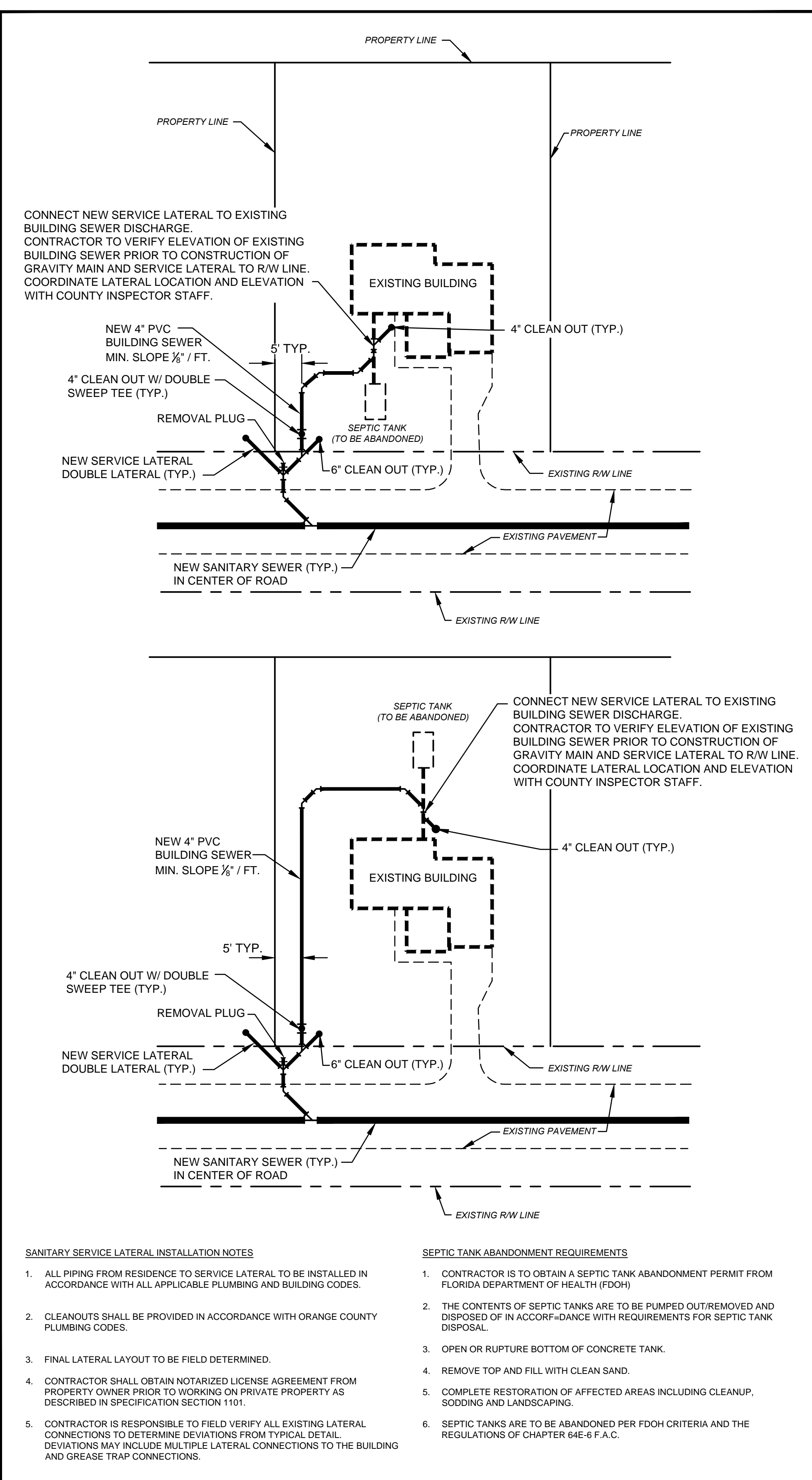
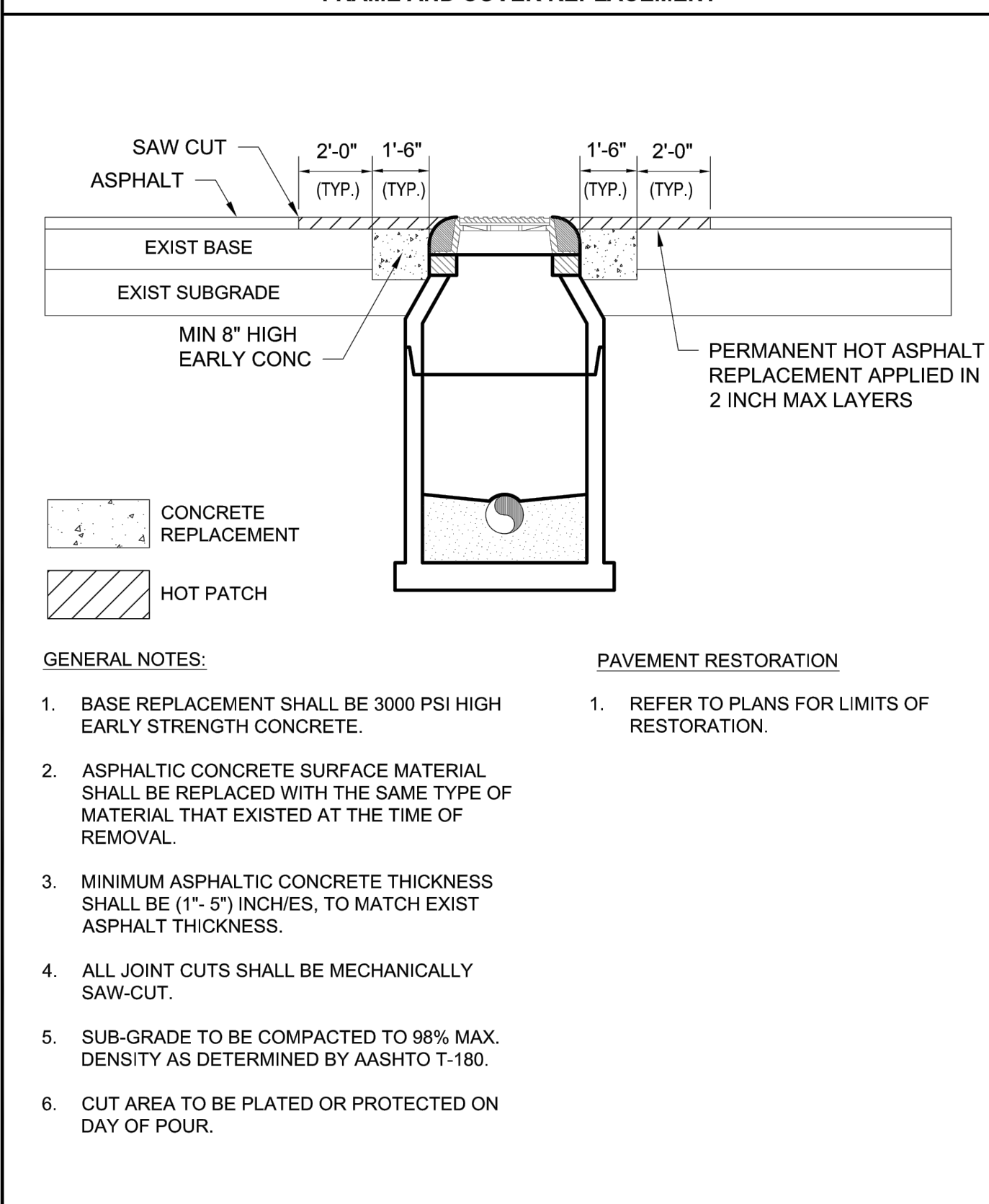

REV	DATE	DESCRIPTION

LINE IS 2 INCHES
AT FULL SIZE
(IF NOT SCALE ACCORDINGLY)

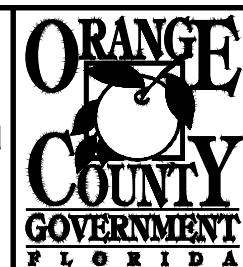

ORANGE COUNTY UTILITIES DEPARTMENT
ENGINEERING DIVISION
9150 CURRY FORD ROAD ORLANDO, FL. 32825



A Full Service A & E Firm
Architects M/E/P
Engineers Planners
Environmental Surveyors
Landscape Architects Traffic/Transportation
www.cphcorp.com
1117 East Robinson Street - Orlando, FL 32801 - Phone: 407.425.0452

Licenses:
Eng. C.O.A. No. 3215
Survey L.B. No. 7143
Arch. Lic. No. AA2600926
Landscape Lic. No. LC0000298

CONSTRUCTION DETAILS
LITTLE EGYPT / RING ROAD
SANITARY SEWER
IMPROVEMENT PROJECT

DAVID E. MAHLER
PROFESSIONAL ENGINEER
FLORIDA LICENSE #50141

OCU FILE NO.:
DESIGNED BY: PVH
DRAWN BY: GNP
CHECKED BY: DEM
CADD FILE: 028505 Cover

SCALE: N.T.S.
DRAWING NO.:
C-3
SHEET: 5 OF 6

BID SET

SANITARY MANHOLE ASSET TABLE								
Manhole ID	Plan Sheet	Easting	Northing	Rim Elevation	INVERT EL. N	INVERT EL. E	INVERT EL. S	INVERT EL. W
MH 30210054	C-1	511349.207	1529320.42	94.19	87.78	90.58	87.83	
MH 30210070	C-1	511355.781	1529131.277	93.12	88.44		88.48	
MH 30210071	C-1	511353.783	1528971.32	93.33	88.99		89.04	
MH 30210072	C-1	511352.283	1528791.32	94.47	89.62		89.67	
MH 30210073	C-1	511349.063	1528471.336	97.44	90.69	90.74		
MH 30210074	C-1	511370.771	1528471.641	97.35				90.81

REV	DATE	DESCRIPTION

LINE IS 2 INCHES
AT FULL SIZE
(IF NOT SCALE ACCORDINGLY)

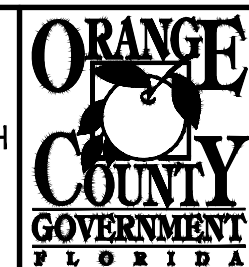

ORANGE COUNTY UTILITIES DEPARTMENT ENGINEERING DIVISION

9150 CURRY FORD ROAD ORLANDO, FL. 32825



A Full Service A & E Firm
Architects M/E/P
Engineers Planners
Environmental Surveyors
Landscape Architects Traffic/Transportation

www.cphcorp.com

1117 East Robinson Street ~ Orlando, FL 32801 ~ Phone: 407.425.0452

Licenses:
Eng. C.O.A. No. 3215
Survey L.B. No. 7143
Arch. Lic. No. AA2600926
Landscape Lic. No. LC0000298

ASSET TABLES
LITTLE EGYPT / RING ROAD
SANITARY SEWER
IMPROVEMENT PROJECT

DAVID E. MAHLER
PROFESSIONAL ENGINEER
FLORIDA LICENSE #50141

OCU FILE NO.:
DESIGNED BY: PVH
DRAWN BY: GNP
CHECKED BY: DEM
CADD FILE: 028505 Cover

SCALE: N.T.S.
DRAWING NO. :
C-4
SHEET: 6 OF 6

BID SET