

**ORANGE COUNTY CONVENTION
CENTER NORTH CULVERT &
GUADRAIL REMEDIATION**

ORANGE COUNTY, FLORIDA

PROJECT LOCATION



VICINITY MAP
NTS

PROJECT DESCRIPTION
NORTH CULVERT &
GUADRAIL REMEDIATION

SHEETS INDEX:
C0 COVER SHEET
C1 DEMOLITION PLAN, SITE PLAN, & DETAIL

OWNER
ORANGE COUNTY CONVENTION CENTER
9800 INTERNATIONAL DRIVE
ORLANDO, FL 32819

CIVIL ENGINEER
DAO CONSULTANTS
1110 E. MARKS STREET
ORLANDO, FL 32803
(407) 898-6872 * FAX (407) 898-3778
CONTACT: SOLANGE DAO, P.E.

REVISIONS



DAO CONSULTANTS, INC.
CERTIFICATE OF AUTHORIZATION NO.: FL #5482
1110 EAST MARKS STREET
ORLANDO, FL 32803
PHONE: (407) 898-6872
FAX: (407) 898-3778

**NORTH CULVERT - GUARD RAIL REMEDIATION
ORANGE COUNTY CONVENTION CENTER
COVER SHEET**

SOLANGE CHIEU DAO
LICENSE
No. 54818
STATE OF
FLORIDA
PROFESSIONAL ENGINEER

NOTE: REPRODUCTION OF THIS PLAN IS INVALID UNLESS ACCOMPANIED BY THE ORIGINAL SET OF PLANS AND EMBOSSED WITH THE ENGINEER'S SEAL AS REFERENCED BY THE PLAN. 23-002, FLORIDA CONSTRUCTION CODE.

- ### DEMOLITION PLAN
1. THE LOCATION OF ANY EXISTING UTILITIES AND PROPOSED FEATURES SHOWN ON THE PLANS HAS BEEN DETERMINED FROM THE BEST AVAILABLE INFORMATION AND ARE PROVIDED AS INFORMATION FOR THE CONVICTION OF CONTRACTOR. THE ENGINEER ASSUMES NO RESPONSIBILITY FOR THE LOCATION OF UTILITIES OR FEATURES NOT SHOWN ON THESE PLANS AND RELATED CONSTRUCTION FROM TO COMMENCEMENT OF CONSTRUCTION UNLESS OTHERWISE NOTED ON THESE PLANS. CONTRACTORS SHALL VERIFY THE LOCATION OF UTILITIES AND FEATURES PRIOR TO CONSTRUCTION AND UNDER THE NEW FOUNDATION OF GUARD RAIL IF NEEDED.
 2. THE GUARD RAIL FOUNDATION SHALL BE CONSTRUCTED TO MATCH EXISTING SLOPE AND ELEVATION OF EXISTING CONCRETE SLOPES.
 3. ACTION SPECIFIC PROTECTION SHALL BE PROVIDED FOR THE PROTECTION OF ALL EXISTING UTILITIES AND FEATURES NOT SHOWN ON THESE PLANS.
 4. ELEVATION OF EXISTING CONCRETE SLOPES SHALL BE MAINTAINED TO MATCH EXISTING SLOPE AND ELEVATION OF EXISTING CONCRETE SLOPES.

DEMOLITION PLAN

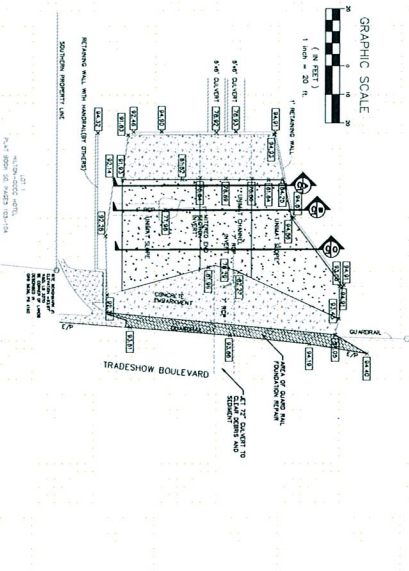
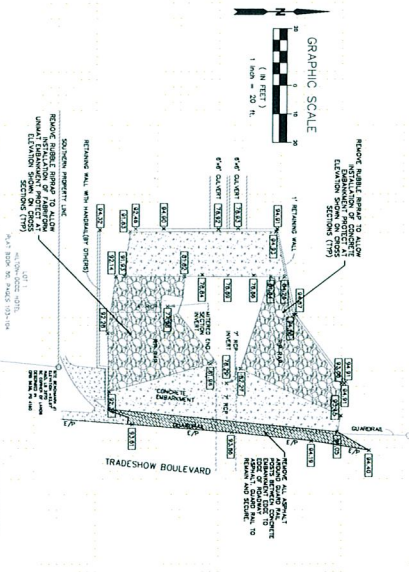

SITE PLAN

- #### SITE NOTES
1. A ROW UTILIZATION PERMIT WILL BE SUBMITTED TO GRANGE CO. PUBLIC WORKS DEPARTMENT FOR REVIEW AND APPROVAL. THE PERMIT SHALL BE IN PLACE BEFORE CONSTRUCTION ACTIVITIES BEGIN. NOT ALL ACTIVITIES WILL BE PERMITTED AT ALL TIMES. THE CONTRACTOR SHALL OBTAIN ALL NECESSARY PERMITS AND APPROVALS BEFORE COMMENCING WORK.
 2. ALL CONSTRUCTION SHALL BE IN ACCORDANCE WITH THE CITY OF ORANGE, FLORIDA, ORDINANCE 2011-11 (AS AMENDED).
 3. ALL CONSTRUCTION SHALL BE IN ACCORDANCE WITH THE CITY OF ORANGE, FLORIDA, ORDINANCE 2011-11 (AS AMENDED).
 4. ALL CONSTRUCTION SHALL BE IN ACCORDANCE WITH THE CITY OF ORANGE, FLORIDA, ORDINANCE 2011-11 (AS AMENDED).
 5. ALL CONSTRUCTION SHALL BE IN ACCORDANCE WITH THE CITY OF ORANGE, FLORIDA, ORDINANCE 2011-11 (AS AMENDED).

GENERAL NOTES

1. THE LOCATION OF ANY EXISTING UTILITIES AND PROPOSED FEATURES SHOWN ON THE PLANS HAS BEEN DETERMINED FROM THE BEST AVAILABLE INFORMATION AND ARE PROVIDED AS INFORMATION FOR THE CONVICTION OF CONTRACTOR. THE ENGINEER ASSUMES NO RESPONSIBILITY FOR THE LOCATION OF UTILITIES OR FEATURES NOT SHOWN ON THESE PLANS AND RELATED CONSTRUCTION FROM TO COMMENCEMENT OF CONSTRUCTION UNLESS OTHERWISE NOTED ON THESE PLANS. CONTRACTORS SHALL VERIFY THE LOCATION OF UTILITIES AND FEATURES PRIOR TO CONSTRUCTION AND UNDER THE NEW FOUNDATION OF GUARD RAIL IF NEEDED.
2. THE GUARD RAIL FOUNDATION SHALL BE CONSTRUCTED TO MATCH EXISTING SLOPE AND ELEVATION OF EXISTING CONCRETE SLOPES.
3. ACTION SPECIFIC PROTECTION SHALL BE PROVIDED FOR THE PROTECTION OF ALL EXISTING UTILITIES AND FEATURES NOT SHOWN ON THESE PLANS.
4. ELEVATION OF EXISTING CONCRETE SLOPES SHALL BE MAINTAINED TO MATCH EXISTING SLOPE AND ELEVATION OF EXISTING CONCRETE SLOPES.
5. ALL CONSTRUCTION SHALL BE IN ACCORDANCE WITH THE CITY OF ORANGE, FLORIDA, ORDINANCE 2011-11 (AS AMENDED).
6. ALL CONSTRUCTION SHALL BE IN ACCORDANCE WITH THE CITY OF ORANGE, FLORIDA, ORDINANCE 2011-11 (AS AMENDED).
7. ALL CONSTRUCTION SHALL BE IN ACCORDANCE WITH THE CITY OF ORANGE, FLORIDA, ORDINANCE 2011-11 (AS AMENDED).
8. ALL CONSTRUCTION SHALL BE IN ACCORDANCE WITH THE CITY OF ORANGE, FLORIDA, ORDINANCE 2011-11 (AS AMENDED).
9. ALL CONSTRUCTION SHALL BE IN ACCORDANCE WITH THE CITY OF ORANGE, FLORIDA, ORDINANCE 2011-11 (AS AMENDED).
10. ALL CONSTRUCTION SHALL BE IN ACCORDANCE WITH THE CITY OF ORANGE, FLORIDA, ORDINANCE 2011-11 (AS AMENDED).
11. ALL CONSTRUCTION SHALL BE IN ACCORDANCE WITH THE CITY OF ORANGE, FLORIDA, ORDINANCE 2011-11 (AS AMENDED).
12. ALL CONSTRUCTION SHALL BE IN ACCORDANCE WITH THE CITY OF ORANGE, FLORIDA, ORDINANCE 2011-11 (AS AMENDED).
13. ALL CONSTRUCTION SHALL BE IN ACCORDANCE WITH THE CITY OF ORANGE, FLORIDA, ORDINANCE 2011-11 (AS AMENDED).
14. ALL CONSTRUCTION SHALL BE IN ACCORDANCE WITH THE CITY OF ORANGE, FLORIDA, ORDINANCE 2011-11 (AS AMENDED).
15. ALL CONSTRUCTION SHALL BE IN ACCORDANCE WITH THE CITY OF ORANGE, FLORIDA, ORDINANCE 2011-11 (AS AMENDED).
16. ALL CONSTRUCTION SHALL BE IN ACCORDANCE WITH THE CITY OF ORANGE, FLORIDA, ORDINANCE 2011-11 (AS AMENDED).
17. ALL CONSTRUCTION SHALL BE IN ACCORDANCE WITH THE CITY OF ORANGE, FLORIDA, ORDINANCE 2011-11 (AS AMENDED).
18. ALL CONSTRUCTION SHALL BE IN ACCORDANCE WITH THE CITY OF ORANGE, FLORIDA, ORDINANCE 2011-11 (AS AMENDED).
19. ALL CONSTRUCTION SHALL BE IN ACCORDANCE WITH THE CITY OF ORANGE, FLORIDA, ORDINANCE 2011-11 (AS AMENDED).
20. ALL CONSTRUCTION SHALL BE IN ACCORDANCE WITH THE CITY OF ORANGE, FLORIDA, ORDINANCE 2011-11 (AS AMENDED).
21. ALL CONSTRUCTION SHALL BE IN ACCORDANCE WITH THE CITY OF ORANGE, FLORIDA, ORDINANCE 2011-11 (AS AMENDED).
22. ALL CONSTRUCTION SHALL BE IN ACCORDANCE WITH THE CITY OF ORANGE, FLORIDA, ORDINANCE 2011-11 (AS AMENDED).
23. ALL CONSTRUCTION SHALL BE IN ACCORDANCE WITH THE CITY OF ORANGE, FLORIDA, ORDINANCE 2011-11 (AS AMENDED).
24. ALL CONSTRUCTION SHALL BE IN ACCORDANCE WITH THE CITY OF ORANGE, FLORIDA, ORDINANCE 2011-11 (AS AMENDED).
25. ALL CONSTRUCTION SHALL BE IN ACCORDANCE WITH THE CITY OF ORANGE, FLORIDA, ORDINANCE 2011-11 (AS AMENDED).
26. ALL CONSTRUCTION SHALL BE IN ACCORDANCE WITH THE CITY OF ORANGE, FLORIDA, ORDINANCE 2011-11 (AS AMENDED).

REVISIONS

NO.	DATE	DESCRIPTION
1		
2		
3		
4		
5		

DAO CONSULTANTS, INC.
 CONSULTANTS
 1110 EAST MARSH STREET
 ORANGE, FLORIDA 32817
 PHONE: (407) 888-6877
 FAX: (407) 888-3776

NORTH CULVERT - SHORELINE AND CHANNEL REMEDIATION ORANGE COUNTY CONVENTION CENTER DEMOLITION PLAN, SITE PLAN, AND DETAILS

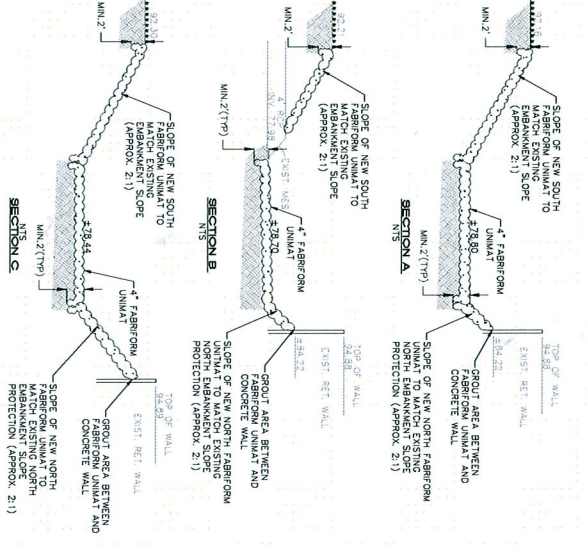

EROSION CONTROL NOTES

1. ALL EROSION CONTROL MEASURES SHALL BE INSTALLED AND MAINTAINED THROUGHOUT CONSTRUCTION.
2. ALL EROSION CONTROL MEASURES SHALL BE INSTALLED AND MAINTAINED THROUGHOUT CONSTRUCTION.
3. ALL EROSION CONTROL MEASURES SHALL BE INSTALLED AND MAINTAINED THROUGHOUT CONSTRUCTION.
4. ALL EROSION CONTROL MEASURES SHALL BE INSTALLED AND MAINTAINED THROUGHOUT CONSTRUCTION.

TEMPORARY GUARD RAIL FOUNDATION BEHIND



DAO CHIEU DAO
 LICENSE No. 54816
 STATE OF FLORIDA
 PROFESSIONAL ENGINEER

NOTE: REPRODUCTION OF THIS PLAN IS PROHIBITED WITHOUT THE WRITTEN PERMISSION OF THE ENGINEER OR ARCHITECT. ANY REPRODUCTION OF THIS PLAN WITHOUT THE WRITTEN PERMISSION OF THE ENGINEER OR ARCHITECT IS UNLAWFUL AND SUBJECT TO PENALTY.

DATE: 11/15/2011
 PROJECT NO.: 11-0000000000
 SHEET: 11 OF 11