

July 1, 2014
BOARD OF COUNTY COMMISSIONERS
ORANGE COUNTY, FLORIDA
IFB Y14-7021-RM
Addendum No. 1
CORRECTIONS - DISTRIBUTION ROUTE & SECURITY GATE
IMPROVEMENTS

BID OPENING DATE: July 29, 2014

This addendum is hereby incorporated into the bid documents of the project referenced above. The following items are clarifications, corrections, additions, deletions and/or revisions to, and shall take precedence over, the original documents. Underlining indicates additions, deletions are indicated by *strikethrough*.

A. The Bid Opening date remains July 29, 2014

B. Delete: The Official Bid Form issued in the Invitation for Bids, Page ~~D-2~~ in its entirety.

Replace with: The attached **Revised Official Bid Form, Pages REVISED D-2 and D2A. The revision includes two additive bid items to the Official Bid Form.**

FAILURE TO SUBMIT THE REVISED SCHEDULE OF PRICES ATTACHED WITH THIS ADDENDUM WITH YOUR BID SHALL RESULT IN YOUR BID BEING DETERMINED NON-RESPONSIVE.

C. SPECIFICATIONS

1. In Section 10341 of the Specifications, paragraph 2.3 B delete 1" square vertical inserts for all four gates. Revise as shown below.

Revise gate panel inserts. Specifications show all four gates with vertical bars. Revise as shown below:

Gate 1: Sheeted option (so gate will be solid on the inside)

Gates 2, 3 & 4: 1/4" mesh option

These are standard options through the specified gate manufacturer. All other specifications remain unchanged.

D. PLANS

1. Minor adjustments were made to each of the gates regarding the exact location, angle, etc. These are minor changes where the gate and its supporting items were move a few feet to better meet Corrections' requirements and operational needs. The attached drawings below have been revised to reflect these changes:

A201, A202, A203, A204, A205, C200, C201, C202, C501, E201, E202, E204

E. ACKNOWLEDGEMENT OF ADDENDA

- a. The Bidder/Proposer shall acknowledge receipt of this addendum by completing the applicable section in the solicitation or by completion of the acknowledgement information on the addendum. Either form of acknowledgement must be completed and returned not later than the date and time for receipt of the bid or proposal.

b. Receipt acknowledged by:

c. All other terms and conditions of the IFB remain the same.

Authorized Signature

Date Signed

Title

Name of Firm

**To the Board of County Commissioners
Orange County, Florida**

The Undersigned, hereinafter called "Bidder", having visited the site of the proposed project and familiarized himself with the local conditions, nature and extent of the work, and having examined carefully the Contract Form, General Conditions, Supplementary Conditions, Plans and Specifications and other Contract Documents, with the Bond requirements herein, proposes to furnish all labor, materials, equipment and other items, facilities and services for the proper execution and completion of: **CORRECTIONS - DISTRIBUTION ROUTE & SECURITY GATE IMPROVEMENTS** in full accordance with the drawings and specifications prepared in accordance with the Contract Documents and, if awarded the Contract, to complete the said work within the time limits specified for the following LUMP SUM BID.

TOTAL BASE BID:

_____ DOLLARS
(In Words)

\$ _____

ADDITIVE BID ITEM 1: Labor and materials to install single mode fiber cabling from communication rooms to all locations required. Fiber will be run in the designated IT conduits already shown on drawings and being provided in the base bid.

_____ DOLLARS
(In Words)

\$ _____

REVISED D-2

ADDITIVE BID ITEM 2: Labor and materials to provide security fencing as needed to modify the perimeter fence line and connect to the new gates. See specifications below for all components that create a security fence for the Corrections Compound.

Each LF of security fence contains:

- 1) 16' tall, 6 gauge, chain link fencing with top, center and bottom rails and performed 6 gauge steel ties mechanically fastened
- 2) 4' tall, security hardware cloth, galvanized woven steel wire cloth with ¼" openings, fastened with steel hog rings
- 3) "Y" cantilever bracket
- 4) 24" concertina wire with stainless steel clips. 6 strands: 3 on cantilever, 3 at bottom of fence

Posts:

- 1) 3" steel pipe that conforms to ASTM F, 1043 Group 1A

<u>ITEM</u>	<u>DESCRIPTION</u>	<u>UNIT</u>	<u>EST QTY</u>	<u>UNIT PRICE</u>	<u>TOTAL</u>
1	Security Fence	LF	400	\$ _____	\$ _____
2	Posts	Ea	40	\$ _____	\$ _____
Total Additive Bid Item 2 (1 Plus 2)					

_____ DOLLARS
(In Words)

\$ _____

In the event the Contract is awarded to this Bidder, he/she will enter into a formal written agreement with the County in accordance with the accepted bid within ten (10) calendar days after said Contract is submitted to him/her and will furnish to the County a Contract Payment and Performance Bond with good and sufficient sureties, satisfactory to the County, in the amount of 100% of the accepted bid. The Bidder further agrees that in the event of the Bidder's default or breach of any of the agreements of this proposal, the said bid deposit shall be forfeited as liquidated damages.

Failure of the Bidder to provide pricing for all unit priced items and/or the Base Bid and ALL requested additive/deductive bid items, or alternate bids shall be cause for rejection of the bid as non-responsive.

REVISED D-2A

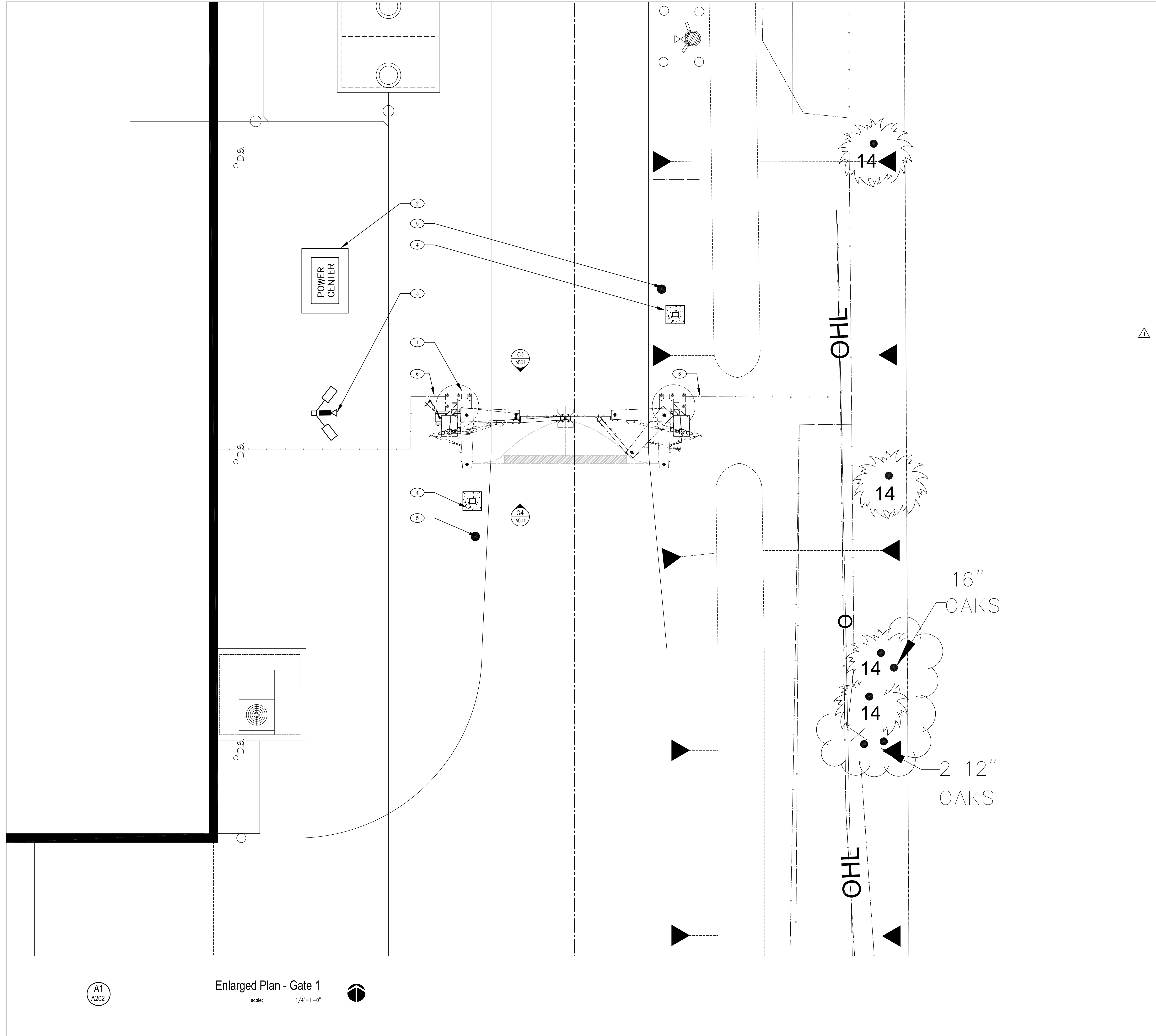

GENERAL PLAN NOTES

1. GENERAL CONTRACTOR IS RESPONSIBLE FOR COORDINATING AND SCHEDULING CONSTRUCTION PHASES WITH THE OWNER PRIOR TO CONSTRUCTION. OBTAINING WRITTEN APPROVAL FROM THE OWNER OF DEMOLITION SCHEDULE IS REQUIRED.
2. FIELD VERIFY ALL EXISTING CONDITIONS PRIOR TO START OF WORK. NOTIFY OWNER IN WRITING OF ANY DISCREPANCIES PRIOR TO START OF CONSTRUCTION.
3. PROTECT ALL EXISTING ITEMS TO REMAIN FROM DAMAGE. CONTRACTOR SHALL BEAR ALL COSTS FOR REPAIRING, REPLACING, REFINISHING ITEMS OF EXISTING ITEMS (INCLUDING FIRE, SMOKE RATINGS) DAMAGED.
4. CONTRACTOR IS TO MAINTAIN EXISTING FIRE, SMOKE RATINGS AT ALL TIMES. CONTRACTOR IS TO PATCH, REPAIR FIRE PROOFING DAMAGED DURING CONSTRUCTION.
5. CONTRACTOR IS TO ENSURE THAT DOOR, WINDOW AND/ OR RATING INFORMATION, STENCILS AND LABELS ARE NOT PAINTED OR COVERED. CONTRACTOR IS TO REPAIR/REPLACE DAMAGED OR COVERED LABELS.
6. PROVIDE, ERECT AND MAINTAIN TEMPORARY PARTITIONS, BARRIERS, GUARD RAILS AND OTHER SAFETY ITEMS AS REQUIRED BY REGULATORY AGENCIES, AS REQUIRED TO PROTECT OCCUPANTS OR AS NECESSARY TO PROTECT MATERIALS, SURFACES AND FINISHES.
7. WHEN CUTTING INTO EXISTING WALLS, SLAB AND ROOF, CONTRACTOR SHALL TAKE EXTREME CARE AND CAUTION TO AVOID DAMAGING THE STRUCTURAL INTEGRITY OF THESE AREAS. CONTRACTOR SHALL DOCUMENT ALL WALL, ROOF CUTS AND SLAB CUTS WHERE REINFORCING MEMBERS ARE CUT. CONTRACTOR SHALL BE RESPONSIBLE FOR REPLACING, RESTORING AND MAINTAINING STRUCTURAL PERFORMANCES WHERE THE STRUCTURAL SYSTEM HAS BEEN COMPROMISED.
8. CONTRACTOR SHALL VERIFY ALL UTILITIES (SHOWN OR NOT SHOWN ON DRAWINGS) THAT ARE TO REMAIN PRIOR TO CONSTRUCTION OR CUTTING INTO ANY WALL. PERMANENT PROCEDURES ARE TO BE MADE TO ROUTE OR BYPASS UTILITIES TO AVOID DISRUPTION OR SEVERING OF UTILITIES. CONTRACTOR SHALL NOT REQUEST ADDITIONAL CHARGES FOR SUCH UTILITIES THAT ARE CLEARLY VISIBLE (WITHOUT DEMOLITION).

NOTES TO SHEET

(NOT ALL NOTES APPLY TO SHEET)

- 1 NEW GATE - FINAL LOCATION OF GATE TO BE CONFIRMED BY OWNER AND A/E - TYP - SEE SHEET A501 FOR ADD'L INFORMATION
- 2 SEE ELECTRICAL DRAWINGS FOR ADD'L INFORMATION
- 3 SECURITY CAMERA - SEE ELECTRICAL DRAWINGS FOR ADD'L INFORMATION
- 4 INTERCOM - SEE ELECTRICAL DRAWINGS FOR ADD'L INFORMATION
- 5 MTL BOLLARD - SEE CIVIL FOR ADD'L INFORMATION
- 6 ADJACENT FENCE TO BE INSTALLED BY OWNER, NIC - TYP

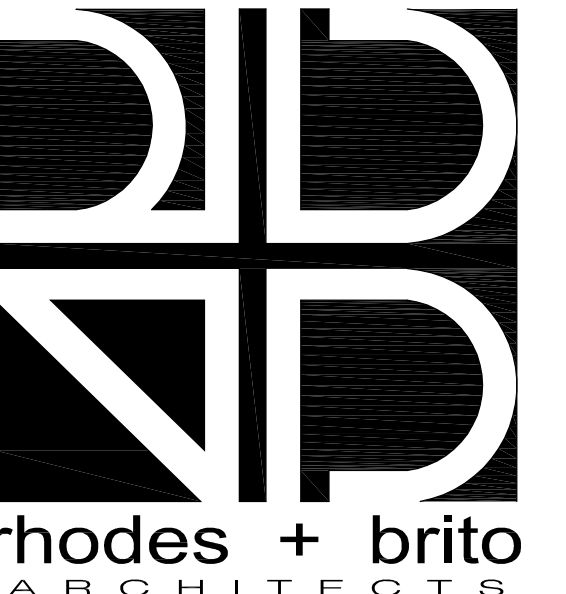

rhodes + brito
ARCHITECTS
605 EAST ROBINSON STREET, SUITE 750
ORLANDO, FL 32801
PH (407) 648 - 7288
FAX (407) 648 - 7289
AA 000 - 2869
www.rbrchitects.com



Orange County Government
Orange County Corrections
Corrections Distribution
Road and Security Gates

2450 33rd Street,
Orlando, FL 32839
ALL REPRODUCTION AND INTELLECTUAL
PROPERTY RIGHTS RESERVED ©

Maximiano Brito, RA, AIA
Fl. Reg. No. AR0015108

CONSTRUCTION DOCUMENTS

no.	revision	date
△	ADDENDUM No01	06-25-2014

ENLARGED PLAN - GATE 1

scale: 1/4"=1'-0"
drawn: LF
check: MB
date: June 13, 2014
project no: 12002.015

A202

A1
A202

Enlarged Plan - Gate 1
scale: 1/4"=1'-0"

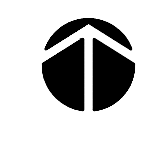

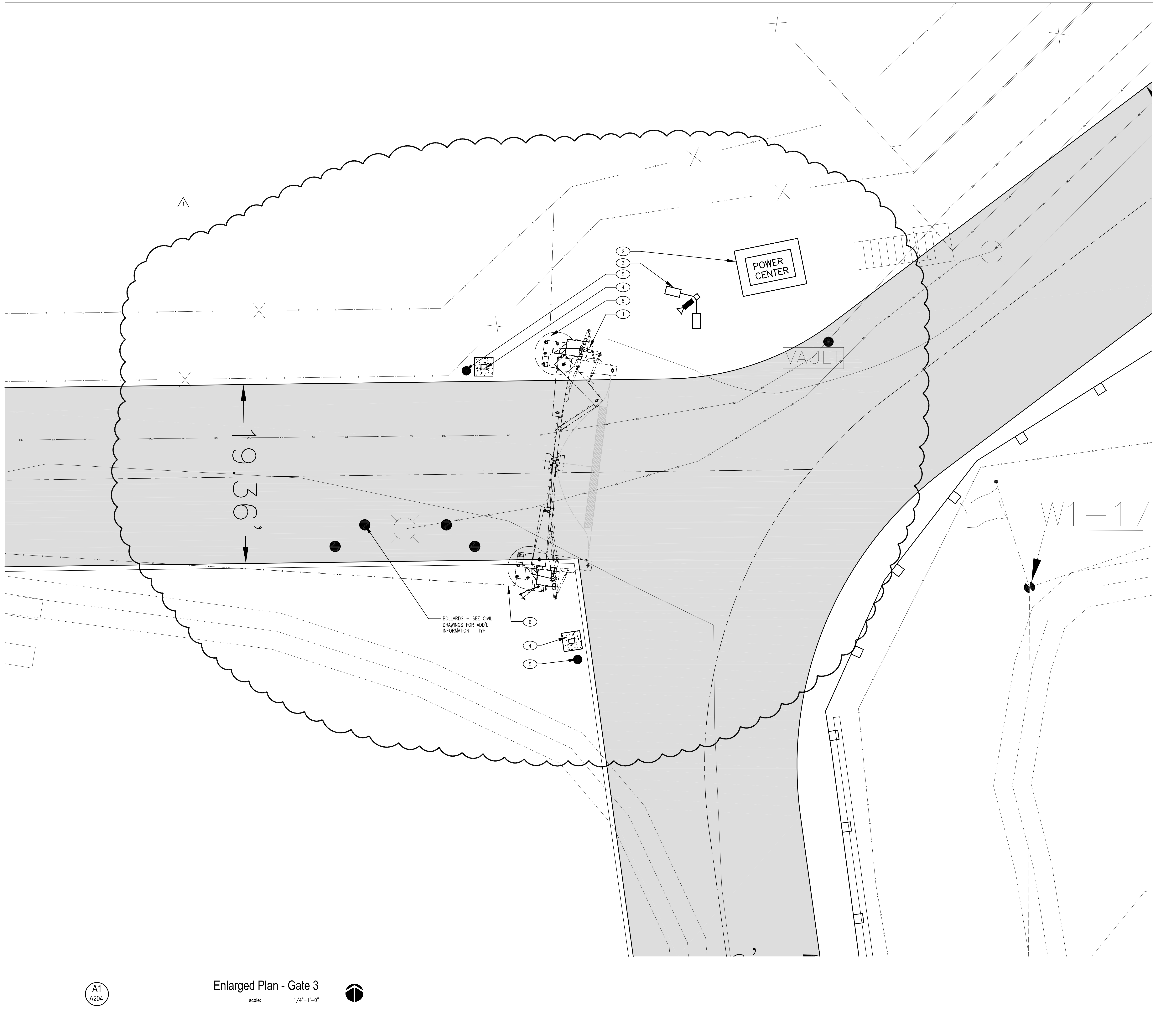

GENERAL PLAN NOTES

1. GENERAL CONTRACTOR IS RESPONSIBLE FOR COORDINATING AND SCHEDULING CONSTRUCTION PHASES WITH THE OWNER PRIOR TO CONSTRUCTION. OBTAINING WRITTEN APPROVAL FROM THE OWNER OF DEMOLITION SCHEDULE IS REQUIRED.
2. FIELD VERIFY ALL EXISTING CONDITIONS PRIOR TO START OF WORK. NOTIFY OWNER IN WRITING OF ANY DISCREPANCIES PRIOR TO START OF CONSTRUCTION.
3. PROTECT ALL EXISTING ITEMS TO REMAIN FROM DAMAGE. CONTRACTOR SHALL BEAR ALL COSTS FOR REPAIRING, REPLACING, REFINISHING ITEMS OF EXISTING ITEMS (INCLUDING FIRE, SMOKE RATINGS) DAMAGED.
4. CONTRACTOR IS TO MAINTAIN EXISTING FIRE, SMOKE RATINGS AT ALL TIMES. CONTRACTOR IS TO PATCH, REPAIR FIRE PROOFING DAMAGED DURING CONSTRUCTION.
5. CONTRACTOR IS TO ENSURE THAT DOOR, WINDOW AND/ OR RATING INFORMATION, STENCILS AND LABELS ARE NOT PAINTED OR COVERED. CONTRACTOR IS TO REPAIR/REPLACE DAMAGED OR COVERED LABELS.
6. PROVIDE, ERECT AND MAINTAIN TEMPORARY PARTITIONS, BARRIERS, GUARD RAILS AND OTHER SAFETY ITEMS AS REQUIRED BY REGULATORY AGENCIES, AS REQUIRED TO PROTECT OCCUPANTS OR AS NECESSARY TO PROTECT MATERIALS, SURFACES AND FINISHES.
7. WHEN CUTTING INTO EXISTING WALLS, SLAB AND ROOF, CONTRACTOR SHALL TAKE EXTREME CARE AND CAUTION TO AVOID DAMAGING THE STRUCTURAL INTEGRITY OF THESE AREAS. CONTRACTOR SHALL DOCUMENT ALL WALL, ROOF CUTS AND SLAB CUTS WHERE REINFORCING MEMBERS ARE CUT. CONTRACTOR SHALL BE RESPONSIBLE FOR REPLACING, RESTORING AND MAINTAINING STRUCTURAL PERFORMANCE WHERE THE STRUCTURAL SYSTEM HAS BEEN COMPROMISED.
8. CONTRACTOR SHALL VERIFY ALL UTILITIES (SHOWN OR NOT SHOWN ON DRAWINGS) THAT ARE TO REMAIN PRIOR TO CONSTRUCTION OR CUTTING INTO ANY WALL. PERMANENT PROCEDURES ARE TO BE MADE TO REROUTE OR BYPASS UTILITIES TO AVOID DISRUPTION OR SEVERING OF UTILITIES. CONTRACTOR SHALL NOT REQUEST ADDITIONAL CHARGES FOR SUCH UTILITIES THAT ARE CLEARLY VISIBLE (WITHOUT DEMOLITION).

NOTES TO SHEET

(NOT ALL NOTES APPLY TO SHEET)

- 1 NEW GATE - FINAL LOCATION OF GATE TO BE CONFIRMED BY OWNER AND A/E - TYP - SEE SHEET A501 FOR ADD'L INFORMATION
- 2 SEE ELECTRICAL DRAWINGS FOR ADD'L INFORMATION
- 3 SECURITY CAMERA - SEE ELECTRICAL DRAWINGS FOR ADD'L INFORMATION
- 4 INTERCOM - SEE ELECTRICAL DRAWINGS FOR ADD'L INFORMATION
- 5 MTL BOLLARD - SEE CIVIL FOR ADD'L INFORMATION
- 6 ADJACENT FENCE TO BE INSTALLED BY OWNER, NIC - TYP

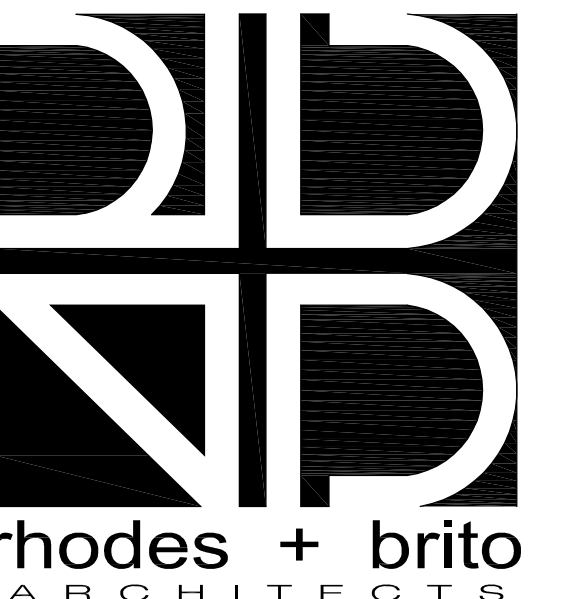

605 EAST ROBINSON STREET, SUITE 750
ORLANDO, FL 32801

PH (407) 648 - 2288
FAX (407) 648 - 2289
AA 000 - 2869
www.rhodesbrito.com



Orange County Government
Orange County
Corrections

Corrections Distribution
Road and Security Gates

2450 33rd Street,
Orlando, FL 32839

ALL REPRODUCTION AND INTELLECTUAL
PROPERTY RIGHTS RESERVED ©

Maximiano Brito, RA, AIA
Fl. Reg. No. AR0015108

CONSTRUCTION DOCUMENTS

no.	revision	date
△	ADDENDUM No01	06-25-2014

ENLARGED PLAN - GATE 3

scale: 1/4"=1'-0"
drawn: LF
check: MB
date: June 13, 2014
project no: 12002.015

A204

A1
A204

Enlarged Plan - Gate 3
scale: 1/4"=1'-0"



